

• GENERAL NOTES •

Legal Width of Right of Way for L.R. 40031 between Sta. 44+00 and Sta. 179+50 is 50 ft., as defined by Pennsylvania Pamphlet Laws of April 11, 1868, page 824.

All Fills 6 ft. or over are to be placed and rolled in layers one-half the specified depth for the class of Materials encountered, in accordance with Sections 3.4.3 of the Specifications.

The DEPARTMENT reserves the Right to eliminate any or all of this work. The Contractor is hereby notified not to perform any such work, except Grading which is within the Highway Right-of-Way, until so ordered in writing by the Engineer.

Specification Form 408, July 1946.

See Special Requirement in Proposal for Public Convenience and Safety.

Construction Details, other than those shown on these drawings, shall conform to the attached Standard Sheets:-

E-3 Approved Oct. 10, 1949	SD-9 Approved Jan. 13, 1950
GF-C " Feb. 21, 1947	SD-10 " Mar. 24, 1947
GF-RCP " Feb. 21, 1947	SD-12 " Mar. 24, 1947
GF-SP " Feb. 21, 1947	S1-4 & 6 " "
SD-1 " Mar. 24, 1947	W-6 " May 7, 1937
SD-6 " Sept. 3, 1946	B-1 " Sept. 9, 1949

The proposed finished grade of pavement between Sta. 119+43.15 and Sta. 179+40 will be approximately 0.19 feet higher at center line than the existing pavement.

Overall Length of this Project = 13,449.07 ft.

Either crushed stone, slag or washed & crushed gravel to be used as a coarse aggregate in the Pl. Cem. Conc. Gutters A & B, the Pl. Cem. Conc. Base Crse. Special Mix., the Pl. Cem. Conc. Curb-B, & in the Bit. Surf. Crse. ID-2, & either Crushed Stone or Slag in the Bit. Surf. Crse. JA-1. Class BM-1 Asphaltic Cement shall be used in the Bit. Surface Crse. ID-2.

Buildings & structures marked [] are to be removed or altered by the Authority responsible for the Payment of Property Damages, and such work is not a part of this Project.

This is a Federal Project and as such is subject to inspection by representatives of the Bureau of Public Roads.

RECORD OF STATIONS OF EXISTING ROAD TYPES

Adjacent to Sta. 44+00 Bit. Surf. Crse. HE on Concrete - 18' Wide
 Sta. 44+00 to Sta. 52+00 Macadam - 18' Wide
 Sta. 52+00 to Sta. 75+50 Relocation
 Sta. 75+50 to Sta. 86+00 Concrete - 20' Wide
 Sta. 86+00 to Sta. 117+50 Relocation
 Sta. 117+50 to Sta. 122+50 Macadam - 28' Wide
 Sta. 122+50 to Sta. 128+85 Brick on Cone Base - 30' Wide
 Sta. 128+85 to Sta. 136+75 Brick Surf. Crse. 20' Wide & 7' Brick Lane Rt. & Lt.
 Sta. 136+75 to Sta. 149+75 Bit. Surf. 20' Wide & 5' Brick Lane Rt. & Lt.
 Sta. 149+75 to Sta. 153+00 Bit. Surf. 20' Wide & 6' Brick Lane Rt. & Lt.
 Sta. 153+00 to Sta. 173+00 Bit. Surf. 20' Wide & 7' Brick Lane Rt. & Lt.
 Sta. 173+00 to Sta. 179+50 Bit. Surf. 20' Wide & 5' Brick Lane Rt. & Lt.
 Adjacent to Sta. 179+50 Bit. Surf. on Brick - 22' Wide

• GRADING SECTION •

The following information on the estimated amounts of Grading Quantities has been used by the DEPT. OF HIGHWAYS in its Preliminary Estimate for this Project and shall not be taken or used as a waiver of any Provisions of the Specifications, & Contract Quantities shown here are Approximate.

STATIONS	LENGTH IN FEET	CU. YDS. CLASS-1 EXCAVATION	CU. YDS. CLASS-2 EXCAVATION	CU. YDS. COMPLETED EMBANKMENT	CU. YDS. BORROW EXCAVATION
44+00-179+50	13,449.07'	96528	2191	106,862	9908
TOTALS	13,449.07'	96528	2191	106,862	9908

• INDEX MAP •
SCALE: 1"=500'

• CONSTRUCTION EQUALITIES •

Sta. 75+96.95 Bk. + Sta. 76+97.88 Ah.

• PUBLIC UTILITIES •

Luzerne County Gas & Electric Co., Kingston, Pa.
 Bell Telephone Co. of Penna., Wilkes Barre, Pa.
 Scranton Spring Brook Water Service Company
 Wilkes Barre, Pa.

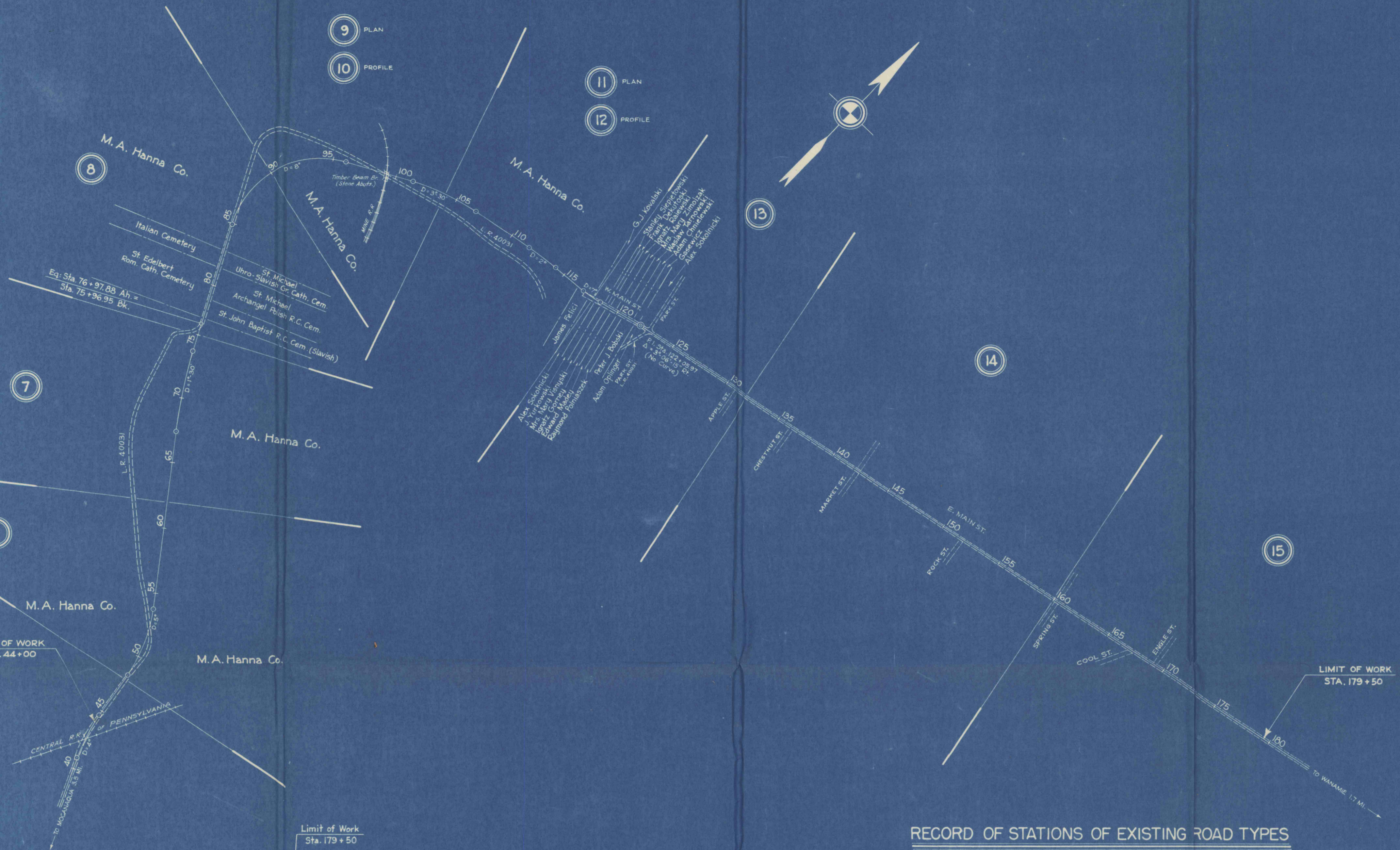

• LOCATION MAP •

No Detour Required

CONSTRUCTION STATE & U.S. ROUTES TOWNSHIP ROADS

NOTE: Hauling is Restricted in accordance with Sections 1, 7, 11 of the Specifications over Routes designated by B & C.