

HIGHWAY  
 PROPOSED MINING

SUSQUEHANNA COLLIERIES DIVISION  
 THE M. A. HANNA COMPANY  
 GLEN LYON COLLIERY

PRINT SHOWING PROPOSED MINING  
 IN BOTTOM ROSS SEAM IN RELATION  
 TO STATE HIGHWAY NO. 40031

SCALE 1" - 100' DEC. 1, 1948

13

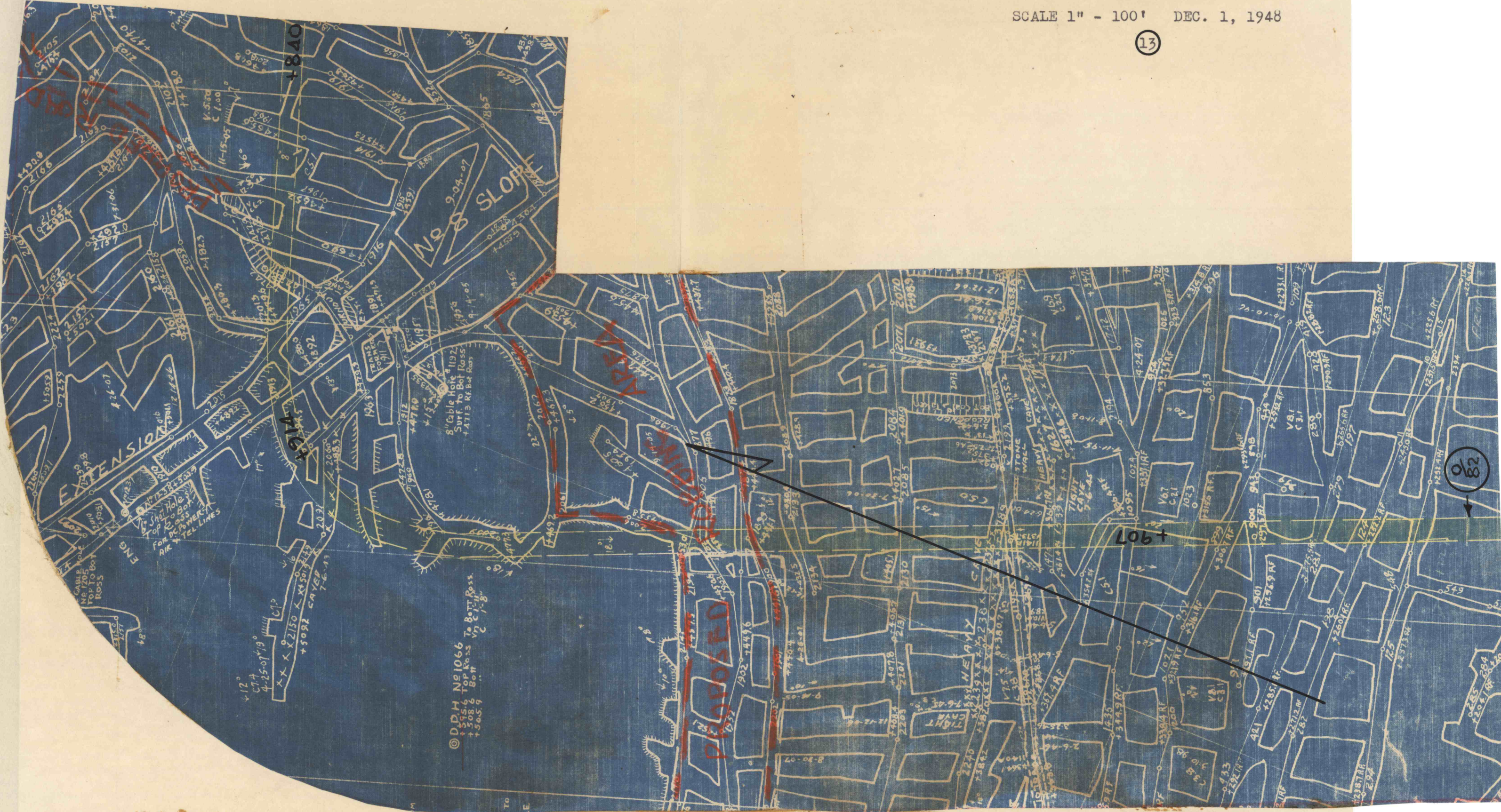

82

1907

© D.D.H. No 1066  
 + 255.6 Top Ross  
 + 308.6 Bot Ross  
 + 305.9

+12°  
 C14  
 4-25-07-19  
 C10  
 + 22150 X  
 + 5082 CAYER  
 7-6-43

1914

1840