

— GRADING SECTIONS —

THE FOLLOWING INFORMATION ON THE ESTIMATED AMOUNTS OF GRADING QUANTITIES HAS BEEN USED BY THE DEPARTMENT OF HIGHWAYS IN ITS PRELIMINARY ESTIMATE FOR THIS PROJECT AND SHALL NOT BE TAKEN OR USED AS A WAIVER OF ANY PROVISIONS OF THE SPECIFICATIONS AND CONTRACT. QUANTITIES SHOWN HERE ARE APPROXIMATE.

STATIONS	LENGTH IN FEET	CU. YDS. OF CLASS 1 EXCAV.	CU. YDS. OF CLASS 2 EXCAV.	CU. YDS. OF COMPLETED EMBANKMENT	CU. YDS. OF BORROW EXCAV.
240+00.00-320+10.00	7988.36	40977	2696	32005	
Total		40977	2696	32005	

PUB. RDS. DIV. NO.	STATE	FEDERAL PROJECT	FISCAL YEAR	DISTRICT	COUNTY	ROUTE	SEC.	SHEET
2	PENNSYLVANIA	S-416(6)		4-0	LUZERNE	654	4	2 of 10

Hazle Township, City of Hazleton & West Hazleton Boro.

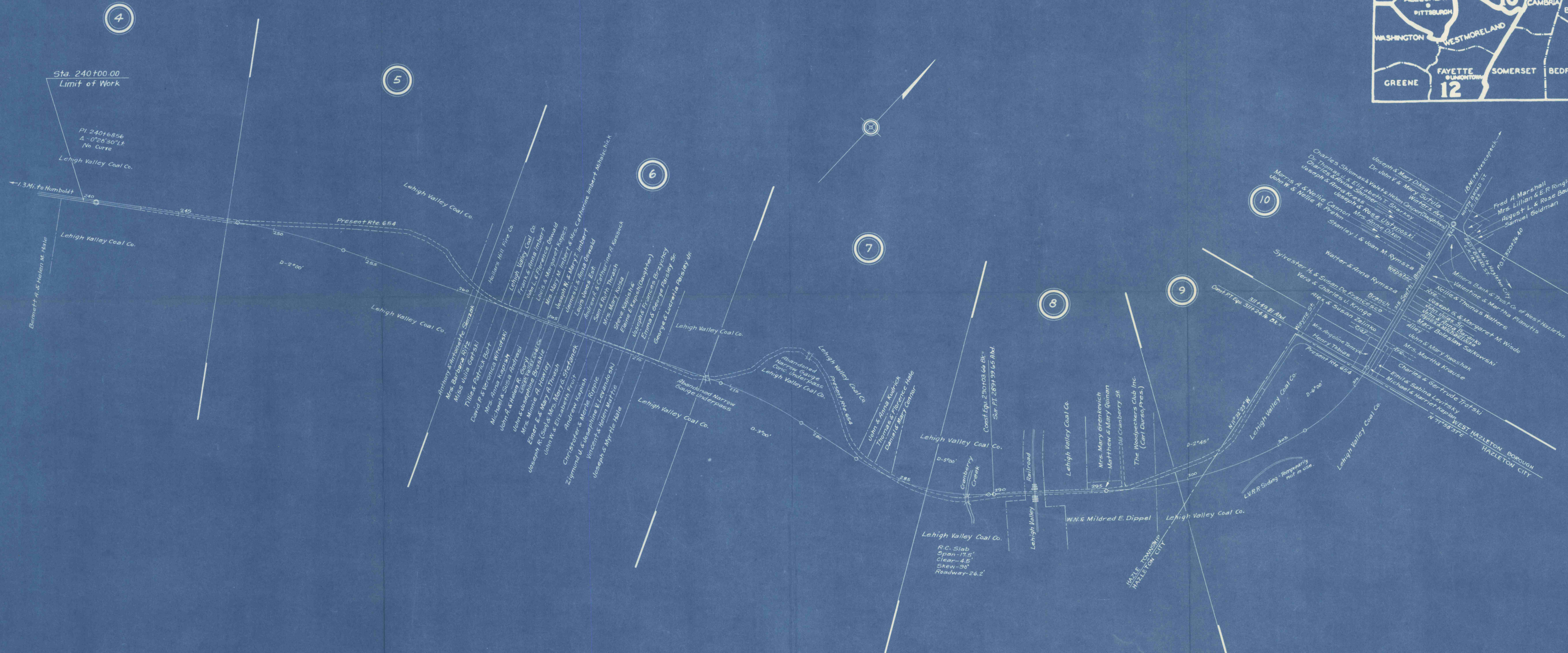
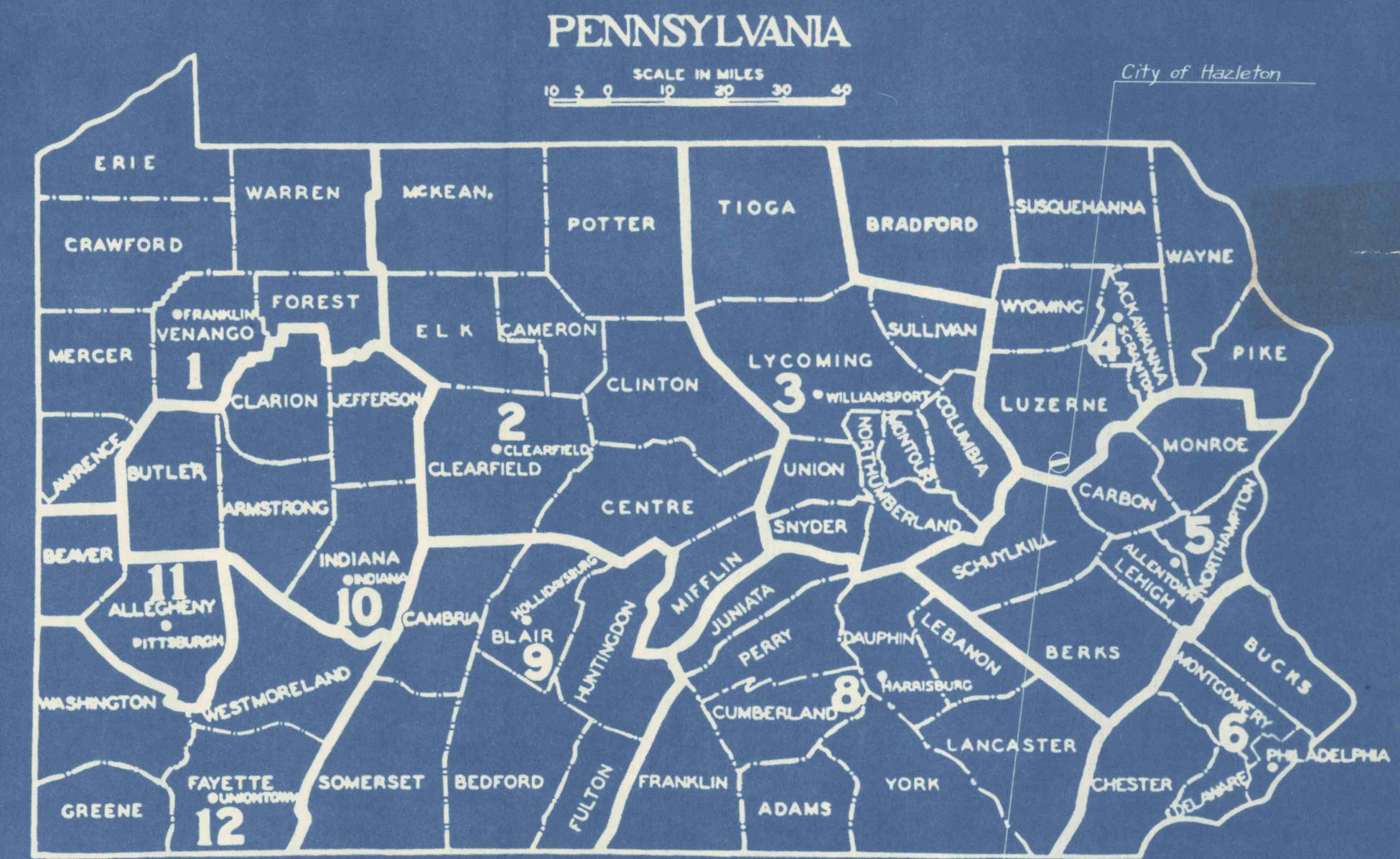

GENERAL NOTES

Legal Width of Right of Way:
 Between Sta. 240+00.00 and Sta. 290+50.00, also Sta. 295+50.00 and Sta. 310+83.00 is Fifty (50) Feet. Information obtained from Road Docket I, Page 166 in the Luzerne County Courthouse at Wilkes-Barre, Penna. Confirmed August Session 1849.

Between Sta. 290+50.00 and Sta. 295+50.00 is Fifty (50) Feet. Information obtained from Plan L.R. 654, Section 2. Approved by Governor Gifford Pinchot, Sept. 7, 1934.

Between Sta. 310+83.00 and Sta. 320+10.00 is Fifty (50) Feet. Information obtained from Map of West Hazleton Boro., dated Jan. 30, 1936.

The Department reserves the right to eliminate any or all of this work. The Contractor is hereby notified not to perform any such work, except grading, which is within the Highway Right of Way, until so ordered in writing by the Engineer.

Buildings and Structures marked [] are to be removed or altered by the authority responsible for the payment of property damages, and such work is not a part of this contract.

Specification Form 408, Dated 1950.

See Special Requirements in the proposal for Public Convenience and Safety.

Construction Details other than shown on these drawings shall conform to the attached Standard Sheets:

E-4	Mar. 18, 1953	Misc. Inlets	May 23, 1951
SD-L	Mar. 24, 1947	Standard Inlets	Aug. 14, 1940
SD-6	Sept. 3, 1946	S1-4'x6'	
SD-10	Mar. 24, 1947	GF-C	Feb. 21, 1947
SD-14	Mar. 18, 1953	GF-SP	Feb. 21, 1947
		GF-R.C.P.	Feb. 21, 1947

Either crushed stone, slag or washed and crushed gravel shall be used as a coarse aggregate in the Bituminous Surface Course ID-2.

Class BM-1 Asphaltic Cement shall be used in the Bituminous Surface Course ID-2.

RECORD OF STATIONS OF EXISTING ROAD TYPES

Adjacent to Sta. 240+00.00	Concrete 18' Wide
Sta. 240+00.00 to Sta. 243+00.00	Concrete 18' Wide
Sta. 243+00.00 to Sta. 248+50.00	Surf. Treated Stone 18' Wide
Sta. 248+50.00 to Sta. 262+50.00	Relocation
Sta. 262+50.00 to Sta. 274+00.00	Surf. Treated Stone 18' Wide
Sta. 274+00.00 to Sta. 290+50.00	Relocation
Sta. 290+50.00 to Sta. 297+00.00	Surf. Treated Stone 18' Wide
Sta. 297+00.00 to Sta. 311+00.00	Relocation
Sta. 311+00.00 to Sta. 320+10.00	Surf. Treated Stone 34' Wide
Adjacent to Sta. 320+10.00	Bit. Surf. on Conc. (Intersection - Var. Width)

INDEX MAP
SCALE: 1" = 300'

This is a Federal Project and as such is subject to inspection by representatives of the Bureau of Public Roads.