

Beginning at a point 3270 feet S. W. of Intersection of County Road and Route #648 for a distance of 1200'.

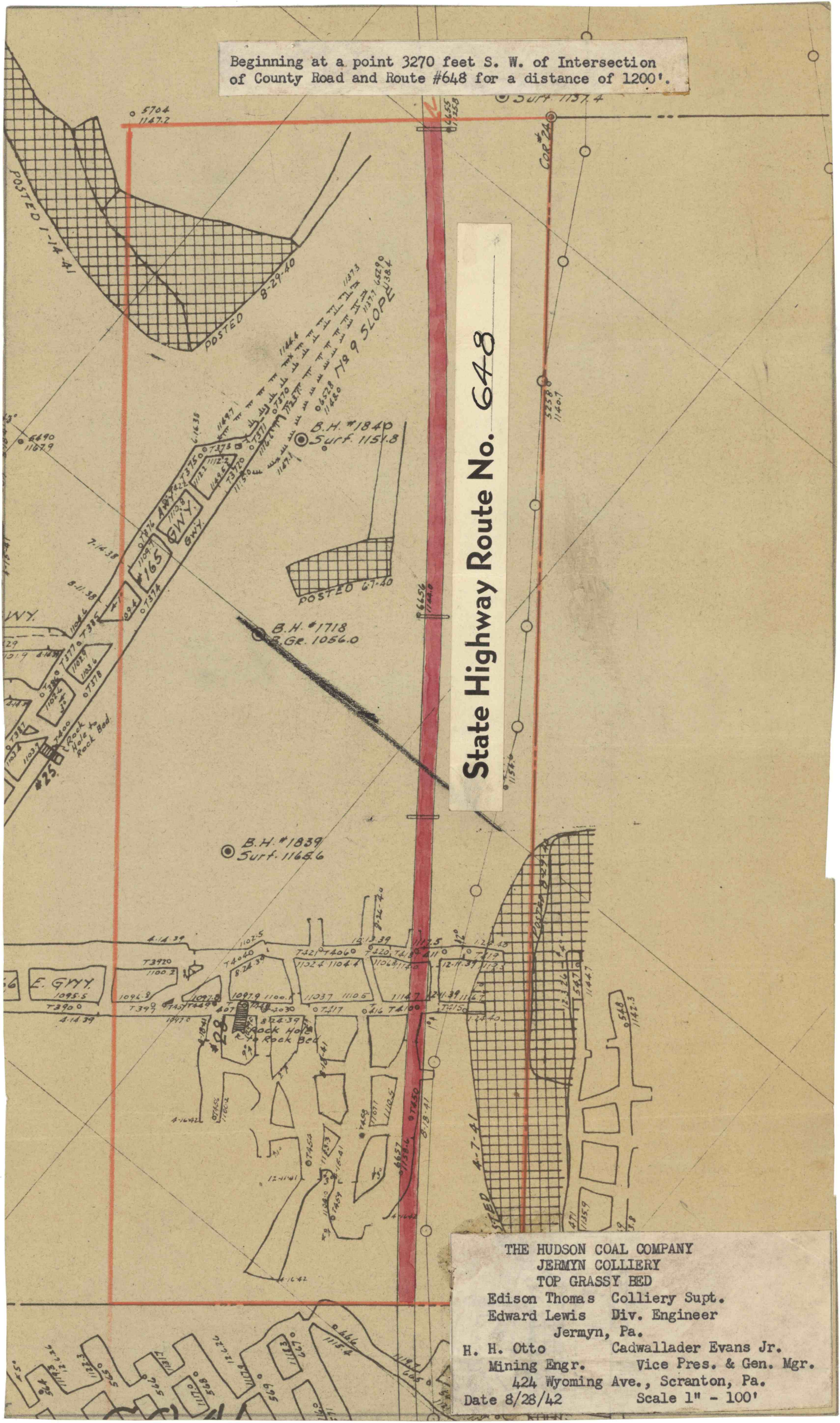

State Highway Route No. 648

THE HUDSON COAL COMPANY
 JERMYN COLLIERY
 TOP GRASSY BED
 Edison Thomas Colliery Supt.
 Edward Lewis Div. Engineer
 Jermyn, Pa.
 H. H. Otto Cadwallader Evans Jr.
 Mining Engr. Vice Pres. & Gen. Mgr.
 424 Wyoming Ave., Scranton, Pa.
 Date 8/28/42 Scale 1" - 100'