

State Highway Route No. 533

To Be Mined  
Next 6 Mos

700' North from Intersection of  
State Highway Route 168 Ext. and  
State Highway Route #533 to a  
point of starting first Mining  
under and adjacent to State  
Highway Route #533 for a distance  
of 250'.

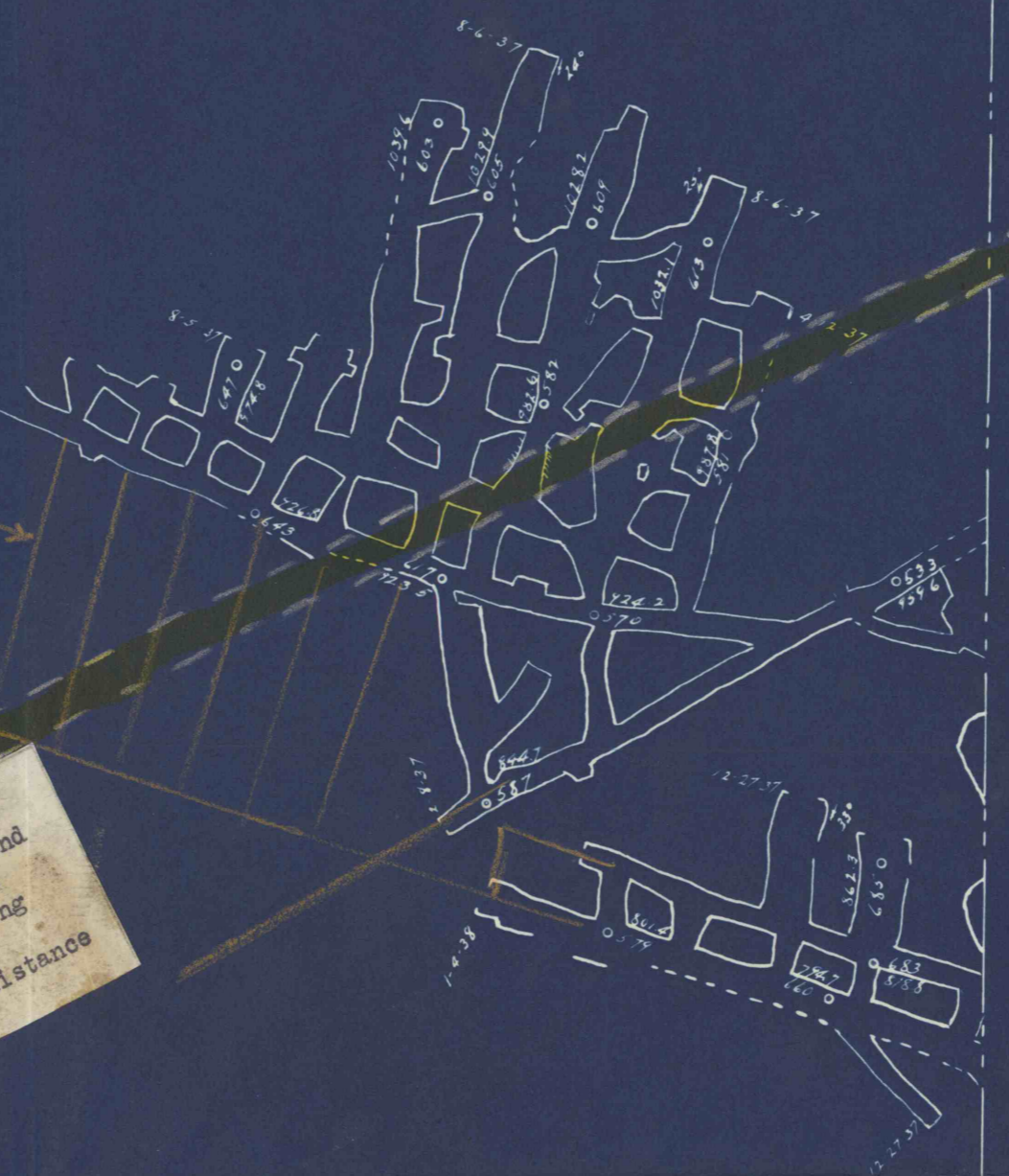

THE HUDSON COAL COMPANY  
OLYPHANT (MILES SLOPE) COLLIERY  
CLARK BED  
Edward Manning Colliery Sup't.  
Walter S. Lutz Div. Engineer  
Olyphant PA.  
H. H. Otto Mining Engineer  
Cadwallader Evans Jr. Vice President & Gen. Mgr.  
424 Wyoming Ave., Scranton, Pa.  
DATE 2/4/38 Scale 1" = 100'  
RTE # 533