

ERS. ESTATED
TRAL COAL CO.

State Highway Route #515

D.D.H.# 4053
Elev. 732.5

D.D.H.# 605
Sur. 766.0

Bed 708

7-60

Coal 5'

D.D.H.# 4082
No COAL
Bed 709

D.D.H.# 804
Sur. 695.2

D.D.H.# 1266
Sur. 743.9

754

Churn

D.D.H.# 1287
Sur. 738.8

D.D.H.# 1285
Sur. 751.7

B.H.# 1308-6" Churn
Sur. 749.0

B.H.# 1309-6" Churn
Sur. 692.1

D.D.H.# 798
Sur. 691.2

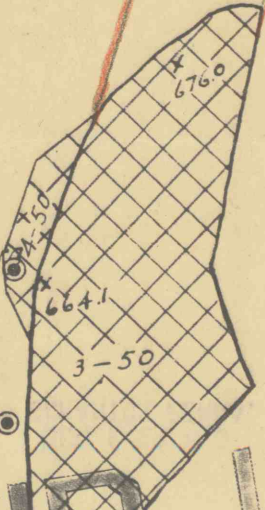

735

B.H.# 1310-6" Churn
Sur. 686.6

AND IRON CO.

The Hudson Coal Company
Delaware Colliery
Bennett Bed
Ralph Smith - Colly Supt
Wm. Black - Colly Engr
Plains Twp., Pa.
J. T. Griffiths - Min. Engr
W.B. Petzold - Vice-Pres.
424 Wyoming Ave. - Scranton, Pa
Date _____ Scale 1" = 100'