

HILLMAN VEIN NO. 14 COLLIERY

SCALE 1"=100'

NOCKNOCK

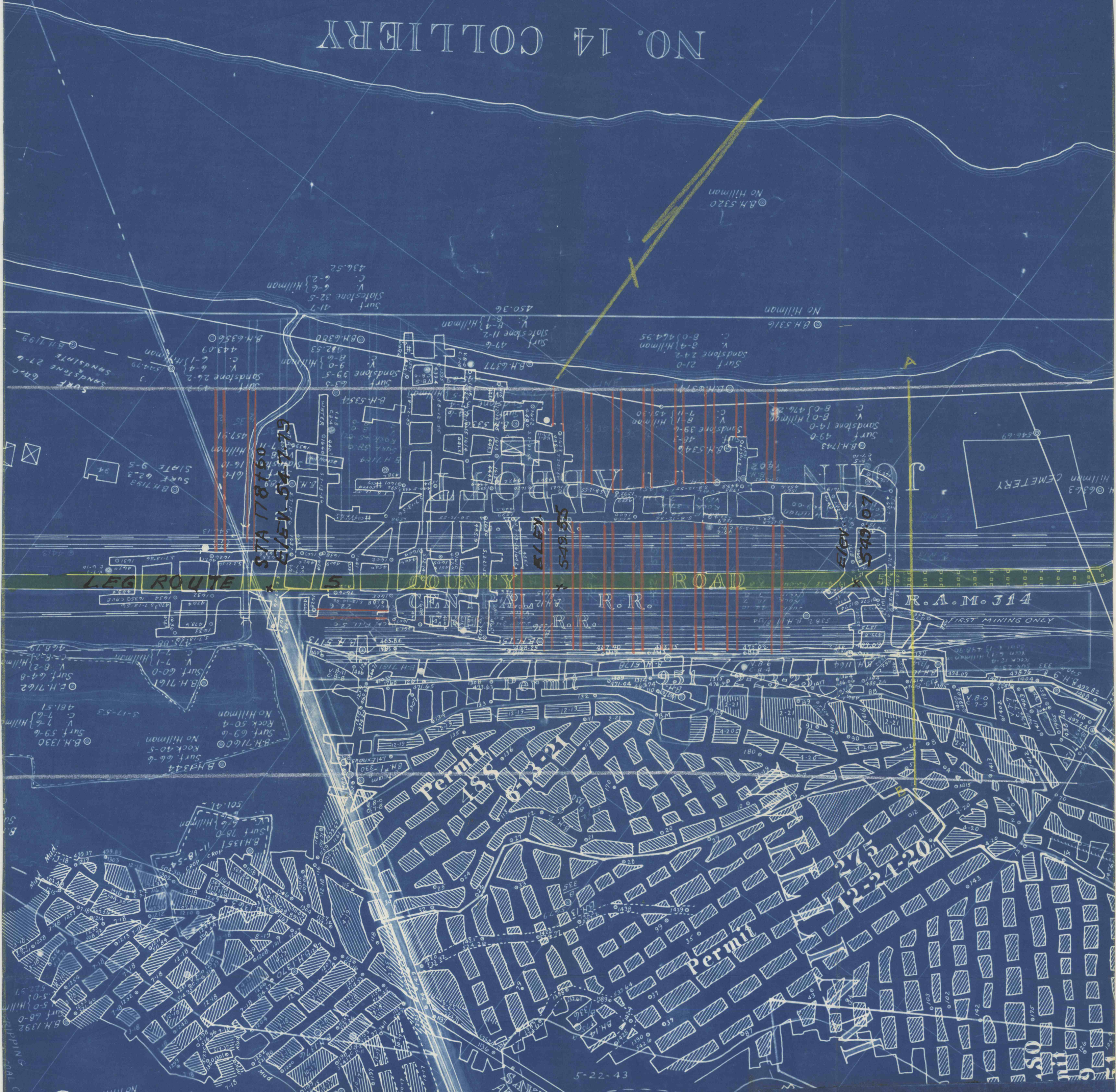

J-G Permit 594 10-3-47

SAYLOR SLOPE
Abandoned April 6, 1925

SLOPE
NO. 14 COLLIERY
HILLMAN VEIN
Scale 1" = 100'

PENNSYLVANIA COAL CO. (Owner)
SMITH & MILL STS., DUNMORE, PA.
CHARLES GELSO (Operator)
P. O. BOX 379, PITTSBURGH, PA.

No Mining Engineer at present.

- GREEN - Leg. Route No. 5
- YELLOW - Cross sections
- WHITE - 300 Ft. line adjacent to center of road
- VIOLET - Six months contemplated second mining
- RED - Six months contemplated first mining