

Note: 1-5 Represent Property owners ADJACENT TO SITE

- NOTES:
- 1- NOS 1 thru 5 Represent Location of Adjoining Property Owners
 - 1- George McKean Owner
 - 2- George R. McKean Owner
 - 3- N. MEGINNIS
 - 4- Henry ELLINGSEN
 - 5- MORTON G. THRESHMAN
 - 2- All Surface Water Seeps Away Into Soil No Run Off From MINED AREA, OR FROM PROPOSED MINE SITE
 - 3- No WATER USED IN THE MINING OPERATION
 - 4- RESTORATION WATER & SEDIMENTATION CONTROL. THIS MINE SITE WILL BE RESTORED AFTER COMPLETION OF THE MINING OPERATION BY GRADING THE ENTIRE SITE TO THE BEST MEAN GRADE WITH SLOPES GRADED TO MIN OF 1:1 TO PREVENT EROSION. THE SITE WILL THEN BE SEEDED WITH GRASS AND TREES WILL BE PLANTED.
 5. Δ LOCATION OF ORIGINAL TEST BORING #1
 6. WELLS & SPRINGS - OWNERS 1-2 & 3 ARE FED FROM Existing Spring Approx 1700 Feet NORTH & WEST FROM MINE See LOCATION PLAN - OWNERS 4 & 5 - WELLS

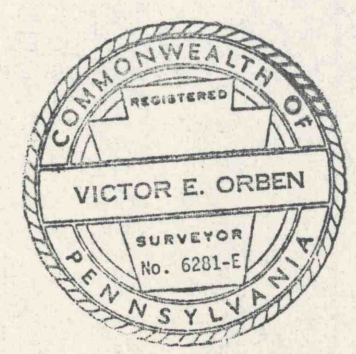
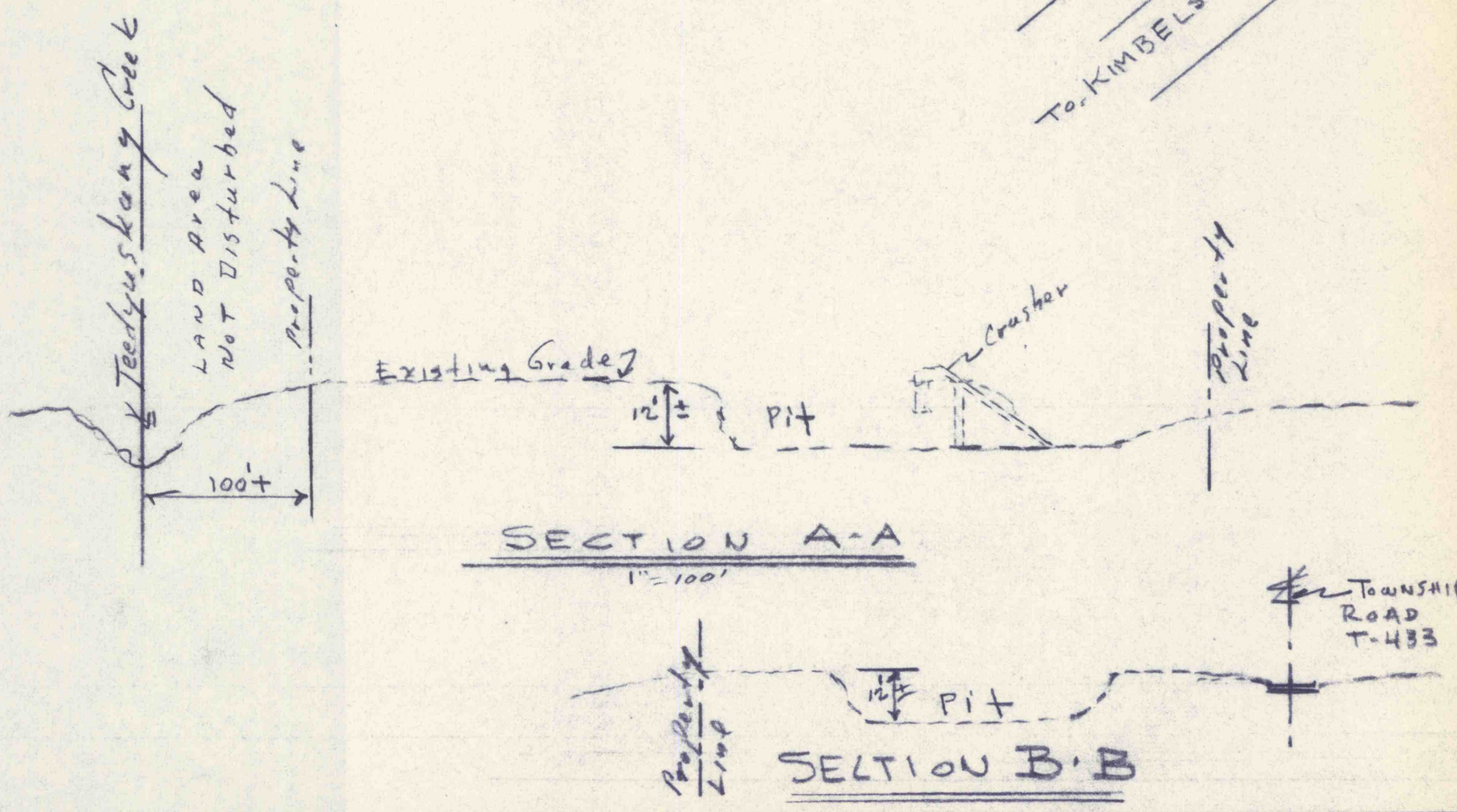

Feb. 23, Added 5th-2

VICTOR E. ORBEN REGISTERED SURVEYOR MILFORD, PENNA.	
SURFACE MINE 6.4 Acres MCKEAN & SONS INC.	
LOCATION: LACKAWAXEN TOWNSHIP	COUNTY: PIKE
STATE: PA	SCALE: 1"=100'
DR. BY: [Signature]	DATE: DEC. 6, 1976
DWG. No. CC-117 Sheet 1 OF 2	