

LOCATION MAP

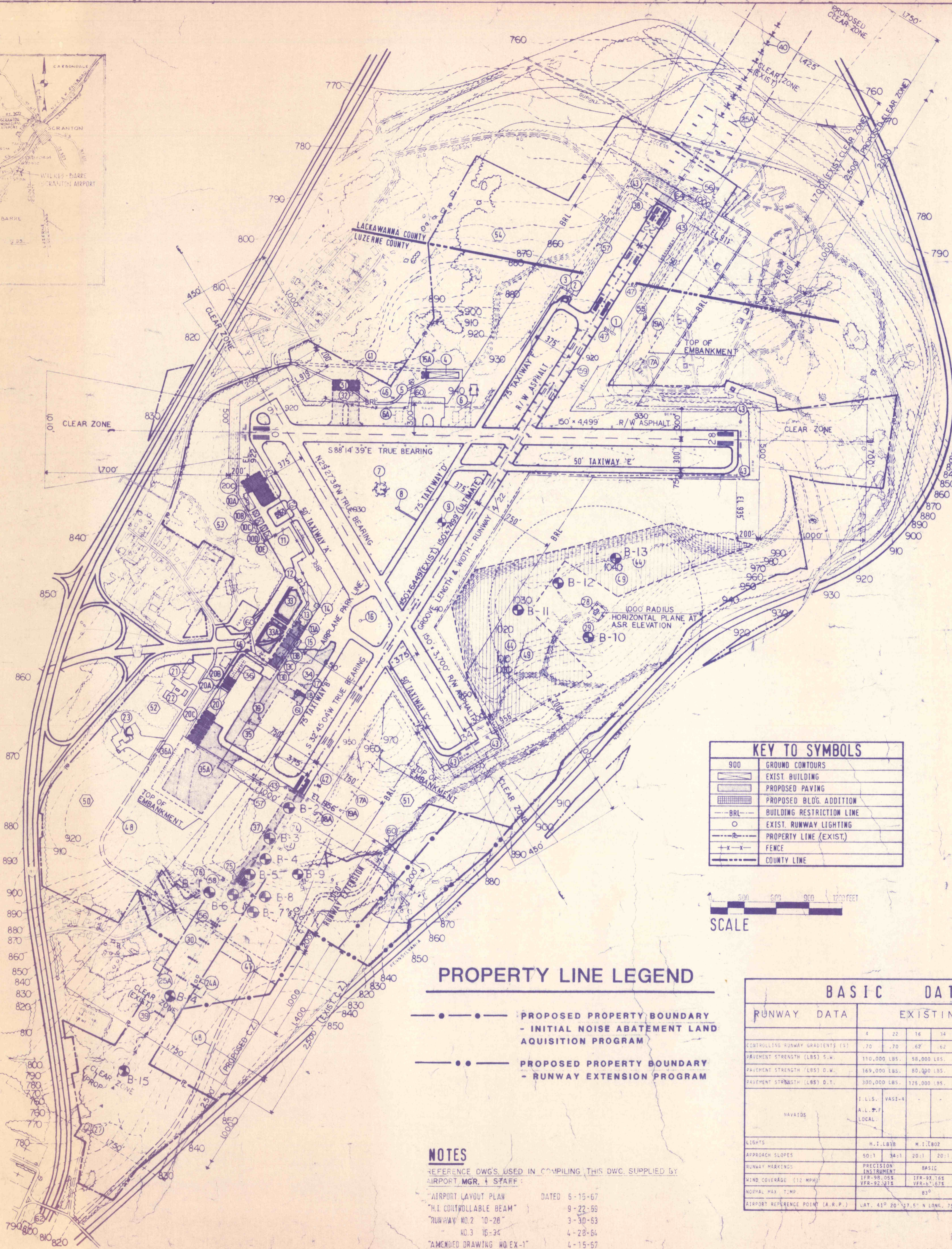

**KEY TO SYMBOLS**

900	GROUND CONTOURS
[Symbol]	EXIST. BUILDING
[Symbol]	PROPOSED PAVING
[Symbol]	PROPOSED BLDG. ADDITION
[Symbol]	BUILDING RESTRICTION LINE
[Symbol]	EXIST. RUNWAY LIGHTING
[Symbol]	PROPERTY LINE (EXIST.)
[Symbol]	FENCE
[Symbol]	COUNTY LINE

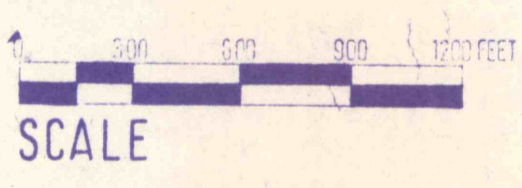

**PROPERTY LINE LEGEND**

- PROPOSED PROPERTY BOUNDARY - INITIAL NOISE ABATEMENT LAND ACQUISITION PROGRAM
- PROPOSED PROPERTY BOUNDARY - RUNWAY EXTENSION PROGRAM

- NOTES**
- REFERENCE DWGS. USED IN COMPILING THIS DWG. SUPPLIED BY AIRPORT MGR. & STAFF:
  - AIRPORT LAYOUT PLAN DATED 5-15-67
  - "H.I. CONTROLLABLE BEAM" 9-22-69
  - "RUNWAY NO. 2 10-26" 3-30-63
  - NO. 3 16-34 4-28-64
  - "AMENDED DRAWING NO. EX-1" 4-15-67
  - "UNTITLED, UNDATED CONTOUR DWG."
  - "DRAINAGE BASIN CONTOURS" 9-29-67
  - "AMF GENERAL PLAN" 10-17-60
  - LLS. R/W & VASI R/W 22 PLOT PLAN 6-10-71
  - & CABLE ROUTING

**BASIC DATA CHART**

RUNWAY DATA	EXISTING						ULTIMATE					
	4	22	16	14	10	28	4	22	16	14	10	28
CENTRAL/END RUNWAY GRADIENT (%)	.70	.70	.67	.62	.27	.27	SAME	SAME	SAME	SAME	SAME	SAME
PAVEMENT STRENGTH (LBS) S.W.	110,000 LBS.	58,000 LBS.	58,000 LBS.	58,000 LBS.	58,000 LBS.	58,000 LBS.	SAME	SAME	SAME	SAME	SAME	SAME
PAVEMENT STRENGTH (LBS) D.W.	165,000 LBS.	80,000 LBS.	80,000 LBS.	80,000 LBS.	80,000 LBS.	80,000 LBS.	SAME	SAME	SAME	SAME	SAME	SAME
PAVEMENT STRENGTH (LBS) D.T.	300,000 LBS.	125,000 LBS.	125,000 LBS.	125,000 LBS.	125,000 LBS.	125,000 LBS.	SAME	SAME	SAME	SAME	SAME	SAME
HAYARDS	1. I.L.S. VASI-4	ALL P.P.					1. I.L.S. VASI-4	ALL P.P.				
LIGHTS	H.I. LWB	M.I. LWB					H.I. LWB	M.I. LWB				
APPROACH SLOPES	50:1	34:1	20:1	20:1	20:1	20:1	50:1	34:1	20:1	20:1	34:1	20:1
RUNWAY MARKINGS	PRECISION	PRECISION	BASIC	NON-PRECISION	NON-PRECISION	NON-PRECISION	SAME	SAME	SAME	SAME	SAME	SAME
WIND COVERAGE (10 MPH)	177-99.05%	177-99.05%	177-99.05%	177-99.05%	177-99.05%	177-99.05%	SAME	SAME	SAME	SAME	SAME	SAME
WIND COVERAGE (15 MPH)	177-99.05%	177-99.05%	177-99.05%	177-99.05%	177-99.05%	177-99.05%	SAME	SAME	SAME	SAME	SAME	SAME
WIND COVERAGE (20 MPH)	177-99.05%	177-99.05%	177-99.05%	177-99.05%	177-99.05%	177-99.05%	SAME	SAME	SAME	SAME	SAME	SAME
REPORT REFERENCE POINT (A.R.P.)	LAT. 41° 20' 32.5" N LONG. 75° 53' 28.0" W						LAT. 41° 20' 19" N LONG. 75° 53' 28" W					

**LEGEND**  
 • BORING LOCATION

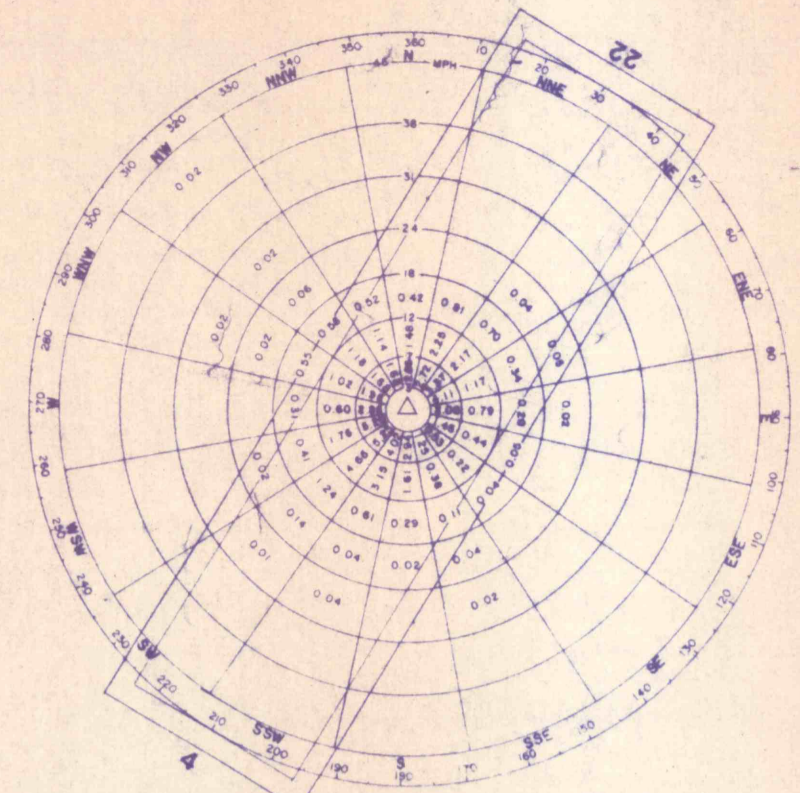

**IFR**  
 RECORD PERIOD: 1960-1973

12 MPH CROSSWIND COVERAGE R/W 4/22 - 98.05%	15 MPH CROSSWIND COVERAGE R/W 4/22 - 99.08%
15 MPH CROSSWIND COVERAGE R/W 10/28 - 98.68%	15 MPH CROSSWIND COVERAGE R/W 10/28 - 98.68%
15 MPH CROSSWIND COVERAGE R/W 16/34 - 97.16%	15 MPH CROSSWIND COVERAGE R/W 16/34 - 98.25%
15 MPH CROSSWIND COVERAGE ALL R/W'S - 100%	15 MPH CROSSWIND COVERAGE ALL R/W'S - 100%
CALMS PLUS 1-3 MPH	

CEILING EQUAL TO OR GREATER THAN 400 FEET WITH 3/4 THROUGH LESS THAN 3 MILES VISIBILITY OR CEILING EQUAL TO OR GREATER THAN 400 FEET BUT LESS THAN 1000 FEET WITH VISIBILITY EQUAL TO OR GREATER THAN 3 MILES.

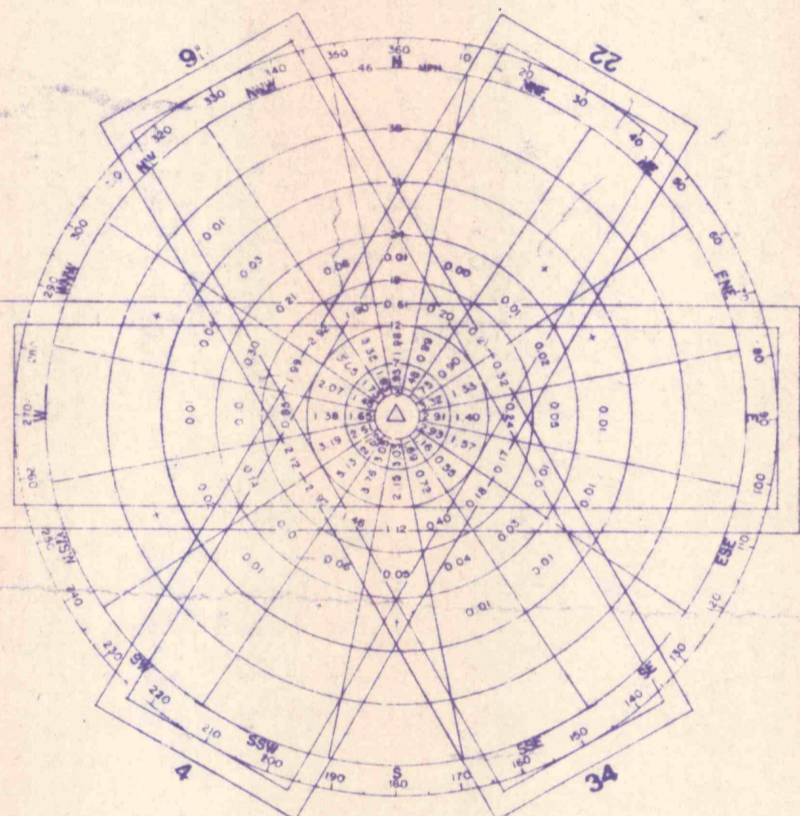

**VFR**  
 RECORD PERIOD: 1960-1973

12 MPH CROSSWIND COVERAGE R/W 4/22 - 92.31%	15 MPH CROSSWIND COVERAGE R/W 4/22 - 96.96%
15 MPH CROSSWIND COVERAGE R/W 10/28 - 96.44%	15 MPH CROSSWIND COVERAGE R/W 10/28 - 96.44%
15 MPH CROSSWIND COVERAGE R/W 16/34 - 87.87%	15 MPH CROSSWIND COVERAGE R/W 16/34 - 97.45%
15 MPH CROSSWIND COVERAGE ALL R/W'S - 100%	15 MPH CROSSWIND COVERAGE ALL R/W'S - 100%
CALMS PLUS 1-3 MPH	

**LEGEND**

NAME	USE	SQ. FT.	DATE	SECURITY
1 - LLS LOCALIZER - EXISTING				LOCKED
2 - LLS LOCALIZER BUILDING - EXISTING	ELECTRONIC EQUIP.	270		
3 - LLS EMERGENCY GENERATOR - EXISTING	EMERGENCY POWER GEN.	108		
4 - MAINTENANCE BUILDING	MAINT. GARAGE & STORAGE	16,900		LOCKED
5 - "HERTZ" SERVICE GARAGE	AUTO SERVICE CENTER	1,600		LOCKED
6 - FUEL STORAGE AVJET	51,000 GAL.			
6A - FUEL STORAGE AVGAS	7,000 GAL.			
7 - SEG. CIRCLE & WIND TEE				
8 - HYGROTHERM				
9 - AIRPORT REFERENCE POINT	LONGITUDE & LATITUDE			
10 - CORPORATE HANGERS				LOCKED & FENCED
10A - MOFFAT & STAUFFER-ASHLEY HANGER	AIRCRAFT STORAGE	6,540		
10B - SULLIVAN TRAIL HANGER	AIRCRAFT STORAGE	2,480		
10C - MEDICO HANGER	AIRCRAFT STORAGE	2,520		
10D - BELLANTE & CLAUS HANGER	AIRCRAFT STORAGE	2,500		
10E - DR. SCROBOLA HANGER	AIRCRAFT STORAGE	4,800		
11 - CEILOMETER				
12 - ELECTRIC VAULT	FIELD LIGHTING CONTROLS	356		LOCKED
13 - TERMINAL BUILDING - EXISTING	PASSENGER TERMINAL & ADMINISTRATIVE OFFICES	64,010		LOCKED & FENCED
13A - PROPOSED TERMINAL EXPANSION			A	
13B - PROPOSED TERMINAL EXPANSION	PASSENGER TERMINAL	6,300	B	
13C - PROPOSED TERMINAL EXPANSION	PASSENGER TERMINAL	5,400	C	
13D - PROPOSED TERMINAL EXPANSION	AIR CARGO	10,000	B	
14 - TOWER	AIRCRAFT CONTROL	400		LOCKED & FENCED
15 - CRASH & RESCUE BUILDING - EXISTING (AIR CARGO)	FIRE DEPT.	3,321	A	LOCKED & FENCED
15A - CRASH & RESCUE BUILDING - PROPOSED RELOCATION	FIRE DEPT.	4,000	A	LOCKED & FENCED
16 - SIREN				
17 - RVR TRANSMITTER - EXIST. LOCATION				LOCKED & FENCED
17A - RVR TRANSMITTER - PROPOSED (RE)LOCATION			A	LOCKED & FENCED
18 - GLIDE SLOPE XMTR - EXIST. LOCATION	ELECTRONIC EQUIP.	96		LOCKED & FENCED
18A - GLIDE SLOPE XMTR - PROPOSED (RE)LOCATION			A	LOCKED & FENCED
19 - RVR RECEIVER - EXIST. LOCATION				LOCKED & FENCED
19A - RVR RECEIVER - PROPOSED (RE)LOCATION			A	LOCKED & FENCED
20 - GENERAL AVIATION HANGERS - EXISTING	AIRCRAFT MAINT. & STORAGE	22,000		LOCKED & FENCED
20A - GENERAL AVIATION TERMINAL - EXISTING	ADMIN. OFF. SCHOOL RMS & STOR.	2,000		LOCKED & FENCED
20B - GEN. AVN. TERMINAL EXPANSION - PROPOSED		7,000	A	LOCKED & FENCED
20C - GEN. AVN./CORPORATE HANGERS EXP. - PROPOSED	AIRCRAFT MAINT. & STORAGE			LOCKED & FENCED
21 - TV STUDIO	TV STATION & EXEC. OFFICES	19,000		LOCKED & FENCED
22 - "AVIS" SERVICE GARAGE	ADMIN. OFFICE & SERVICE CENTER	1,560		LOCKED & FENCED
23 - NAVAL RESERVE BUILDING	USNR TRAINING CENTER	29,676		LOCKED & FENCED
24 - HIGH INT. APPR. LIGHT EQUIP. BLDG. - EXIST. LOCATION	POWER VAULT & STORAGE	184		LOCKED & FENCED
24A - MALS R EQUIP. BLDG. - PROPOSED LOCATION	POWER VAULT & STORAGE	184	A	LOCKED & FENCED
25 - "000" MARKER - EXIST. LOCATION				LOCKED & FENCED
25A - "000" MARKER - PROPOSED (RE)LOCATION			A	LOCKED & FENCED
26 - PUMP HOUSE - EXIST.	WATER SYS. PUMP (S. SIDE)	216		LOCKED & FENCED
27 - MIDDLE MARKER - EXIST. LOCATION	RADIO TRANSMITTER	96		LOCKED & FENCED
28 - F.A.A. ASR (RADAR)	ELECTRONIC EQUIP. & STORAGE	14,88		LOCKED & FENCED
29 - AIRPORT BEACON				
30 - HIGH INT. APPROACH LIGHTING SYSTEM - EXIST. R/W 4				
31 - PROPOSED AIR CARGO BUILDING	AIRCARGO LOADING & UNLOADING	25,000	C	
32 - PROPOSED AIR CARGO APRON			C	
33 - PROPOSED PARKING EXPANSION			C	
33A - PROPOSED PARKING EXPANSION			A	
34 - PROPOSED AIR CARRIER APRON			B & C	
35 - PROPOSED GENERAL AVIATION APRON			A	
35A - PROPOSED GENERAL AVIATION APRON			C	
36 - PROPOSED GENERAL AVIATION PARKING			A	
36A - PROPOSED GENERAL AVIATION PARKING			B & C	
37 - PROPOSED RUNWAY EXPANSION			A	
38 - PROPOSED RUNWAY - TURNOFF ROAD BULB			A	
39 - PROPOSED MALS R SYSTEM R/W 4			A	
40 - PROPOSED ALSF-2 SYSTEM R/W 22			A	
41 - PROPOSED ROAD RELOCATION			A	
42 - PROPOSED VASI-4 SYSTEM R/W 4			A	
43 - PROPOSED REILS SYSTEM			A	
44 - REMOVE EXIST. HILL (FOR RUNWAY EXTENSION)			A	
45 - PARKING BOOTH	PARKING ATTENDANT	48	A	LOCKED & FENCED
46 - F.A.A. REMOTE TRANSMITTER BUILDING	F.A.A. STORAGE	1,170		LOCKED & FENCED
47 - EXISTING VASI-4 SYSTEM				
48 - ROAD AS PROPOSED BY EAST'N DIST. CENTER				
49 - POTENTIAL AIRPORT RELATED LAND USE				
50 - THROUGH 50 - INDUSTRIAL / COMMERCIAL				
55 - PROPOSED GLIDE SLOPE TRANSMITTER			A	
56 - PROPOSED LOCALIZER ANTENNA			A	
57 - LAND RESERVE FOR TAXIWAY EXTENSION			B	
58 - RELOCATED REILS SYSTEM			A	
59 - TOUCHDOWN ZONE & CENTERLINE LIGHTING			A	
60 - SECURITY FENCING				
61 - EXTEND TAXIWAY			A	
62 - MIDDLE MARKER - PROPOSED RELOCATION			A	
63 - HELI-PAD			A	
64 - STABILIZED OVERRUN & BLAST PAD				

- NOTES:**
- 1 - MISCELLANEOUS FACILITIES: TAXIWAY LIGHTING, TAXIWAY GUIDANCE SIGNS.
  - 2 - TERMINAL BUILDING FIRST FLOOR EL. 941.70'
  - 3 - CONTROL TOWER ROOF EL. 983.00'
  - 4 -
  - 5 - TOPOGRAPHIC INFORMATION & PROPERTY LINES PROVIDED BY AIRPORT MANAGER.

**BORING LOCATION PLAN**  
 EXTENSION OF RUNWAY 4/22  
 AIP PROJECT NO. 3-42-0105-05-04

FEB. 27, 1984

WILKES-BARRE / SCRANTON AIRPORT	
<b>MASTER PLAN</b>	
1 PROPERTY LINE REVISIONS	DATE BY
NO. REVISIONS	DATE BY
PROVIDED BY:	RIGGI & RIGGI ARCHITECTS DUNMORE, PENNSYLVANIA
T.A.A. WILKES-BARRE AIRPORT	TRANSPLAN, INC. - CONSULTANTS
PENN. DOT	PROPOSED AIRPORT LAYOUT
PENN. DOT	DRWING NO. 3