

STA 17+00 RT

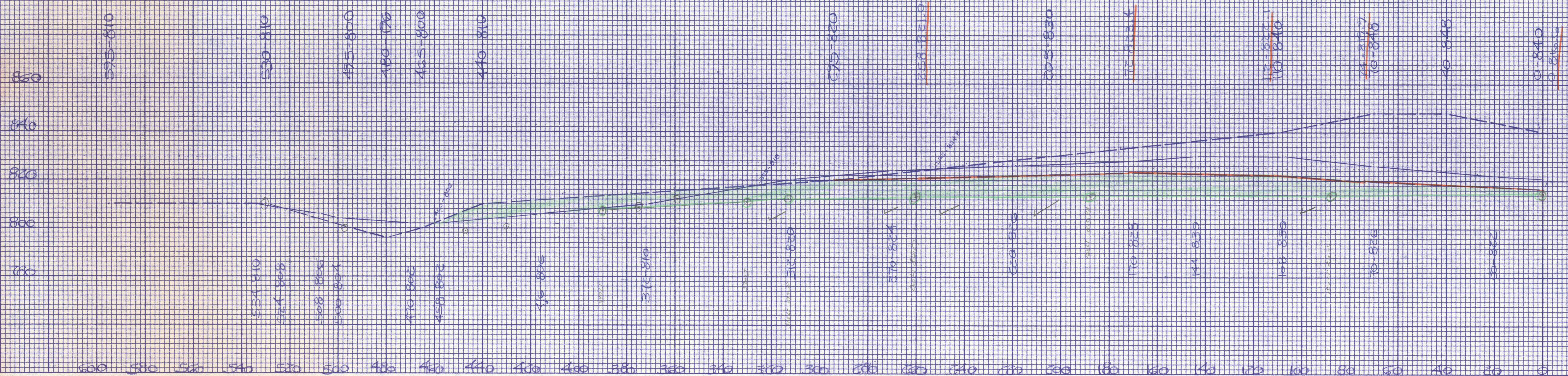

STA 17+00 LT

OSM 40 (L.S.) 102.1
DELAWARE & HUDSON R.R.

DATE: 11/20
 DRAWN BY: [Signature]
 CHECKED BY: [Signature]
 APPROVED BY: [Signature]

WINKED IN 1/2" V

DIELXOEM
10 x 10 - ONE INCH
-REPROCL. CROSS SECTION

WINKED IN 1/2" V

DIELXOEM
10 x 10 - ONE INCH
-REPROCL. CROSS SECTION

RECEIVED
4-7-92