

NOTE: The Contractor shall comply with Act 287 of the General Assembly, as amended, which defines the procedures for notification to Public Utilities prior to excavation, Drilling, or demolition work using power equipment or explosives.

Tamaqua Borough Water Department
320 East Broad Street
Tamaqua, PA 18252
Phone (717) 668-3444

Consolidated Rail Corporation
150 Allendale Rd.
King Of Prussia, PA 19406
Phone (215) 596-3877

LEGEND

- Riprap Ditch
- Jute Matting Lined Ditch
- Area Boundaries
- Silt Barrier Fence

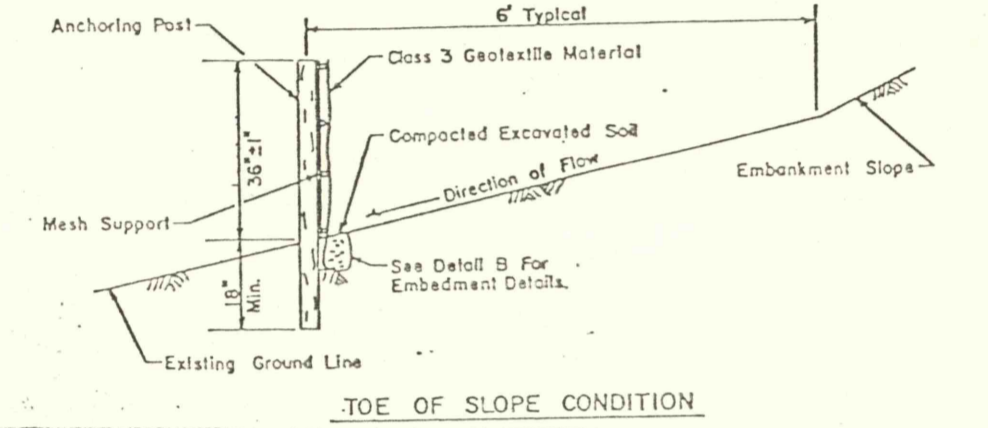
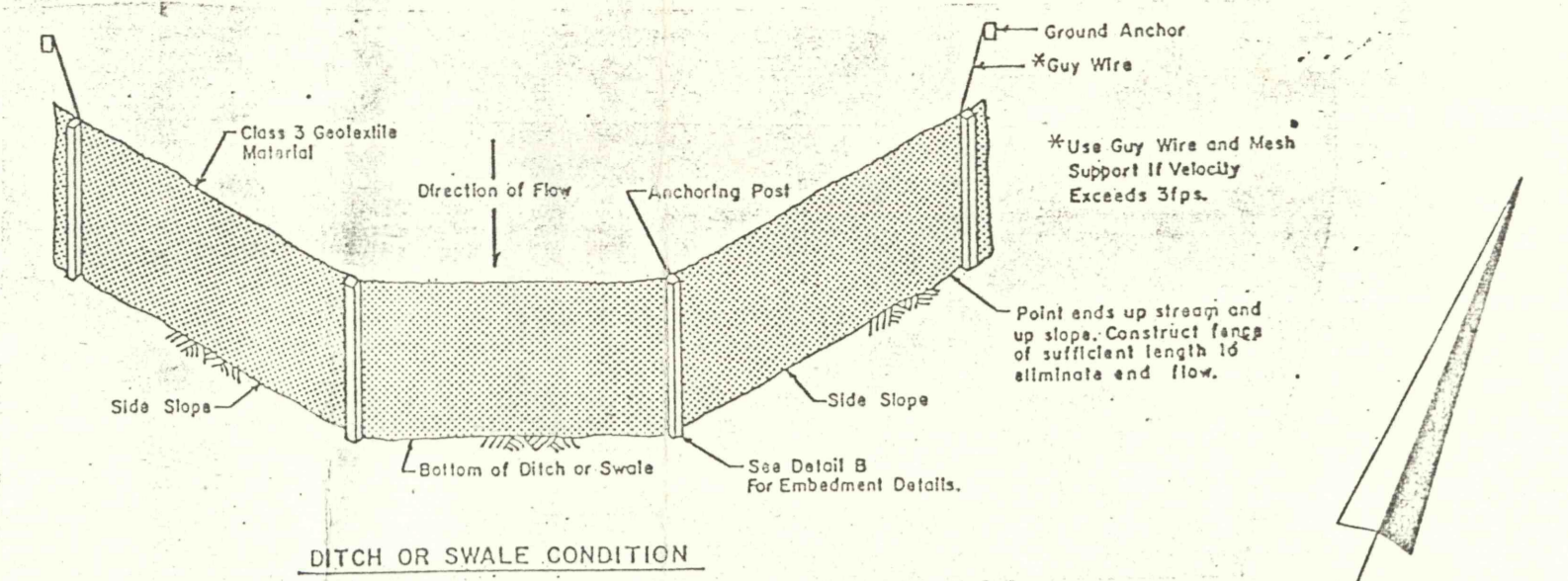
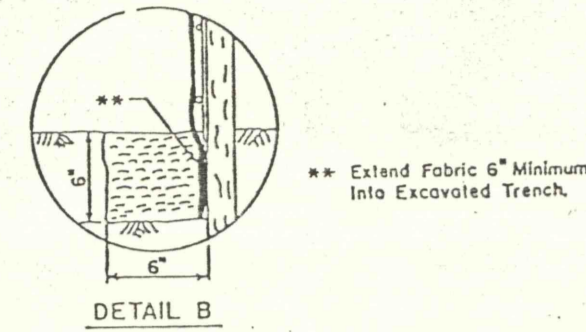
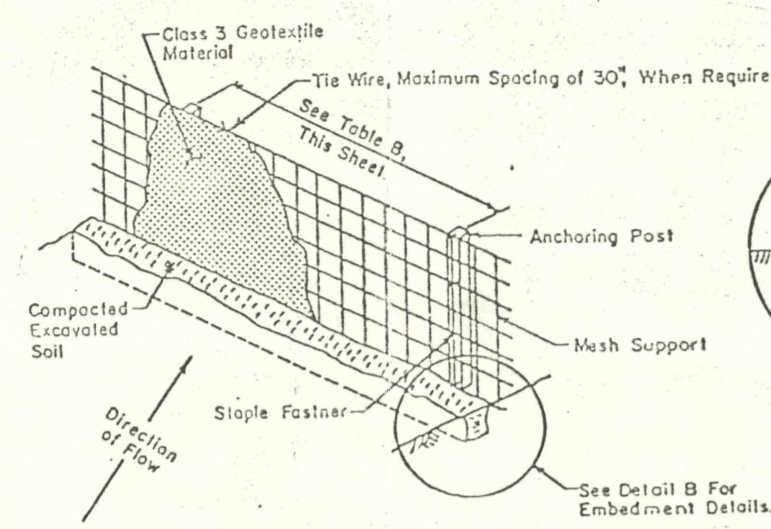

- * Silt barrier fence will be placed at every 100 feet in the ditch until project is completed.
- * Erosion and sedimentation control devices will be inspected weekly and cleaned and repaired if necessary.

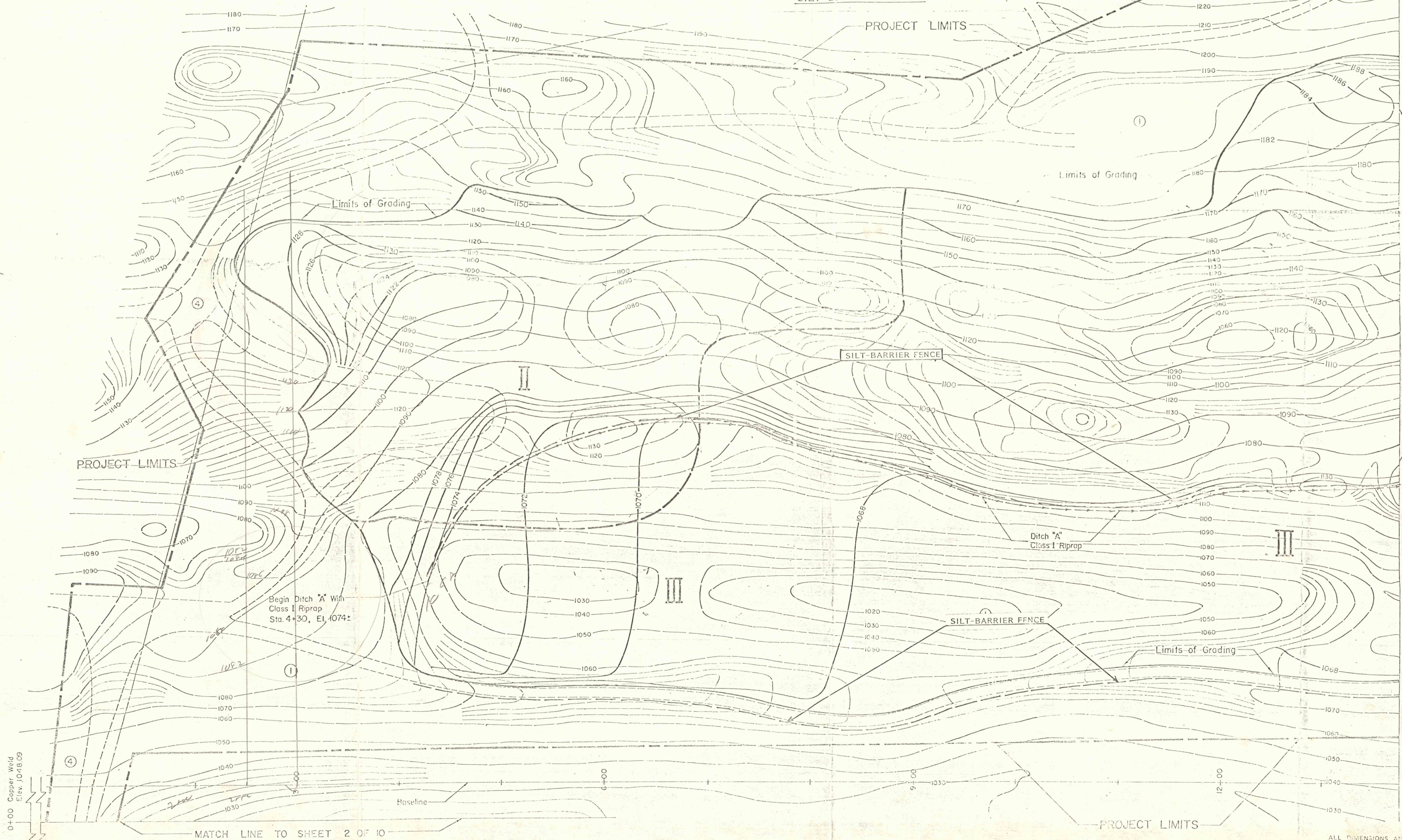

NO.	DATE	REVISION	APPR.
1			
SUBMITTED <i>Charles J. Kelly</i> CHIEF, DESIGN SECTION, WILKES-BARRE			
APPROVED <i>Michael P. Perko</i> DISTRICT ENGINEER, WILKES-BARRE			
APPROVED <i>Richard J. Smith</i> DIRECTOR, BUREAU OF ABANDONED MINE RECLAMATION			
COMMONWEALTH OF PENNSYLVANIA DEPARTMENT OF ENVIRONMENTAL RESOURCES OFFICE OF RESOURCES MANAGEMENT			
PROJECT NO. Q S M 54(3240)10.11			
BACKFILLING ABANDONED ASHTON STRIP PITS BOROUGH OF TAMAQUA SCHUYLKILL COUNTY, PENNSYLVANIA			
SURFACE MAP			

ALL DIMENSIONS AND EXISTING CONDITIONS SHALL BE CHECKED AND VERIFIED BY CONTRACTOR AT THE SITE.
 DRAWN BY *gdf* DATE Jan. 13, 1988
 CHECKED BY *C.L.* SCALE 1" = 50' 3 of 8