

MATCH LINE TO SHEET 3 OF 10

MATCH LINE TO SHEET 4 OF 10

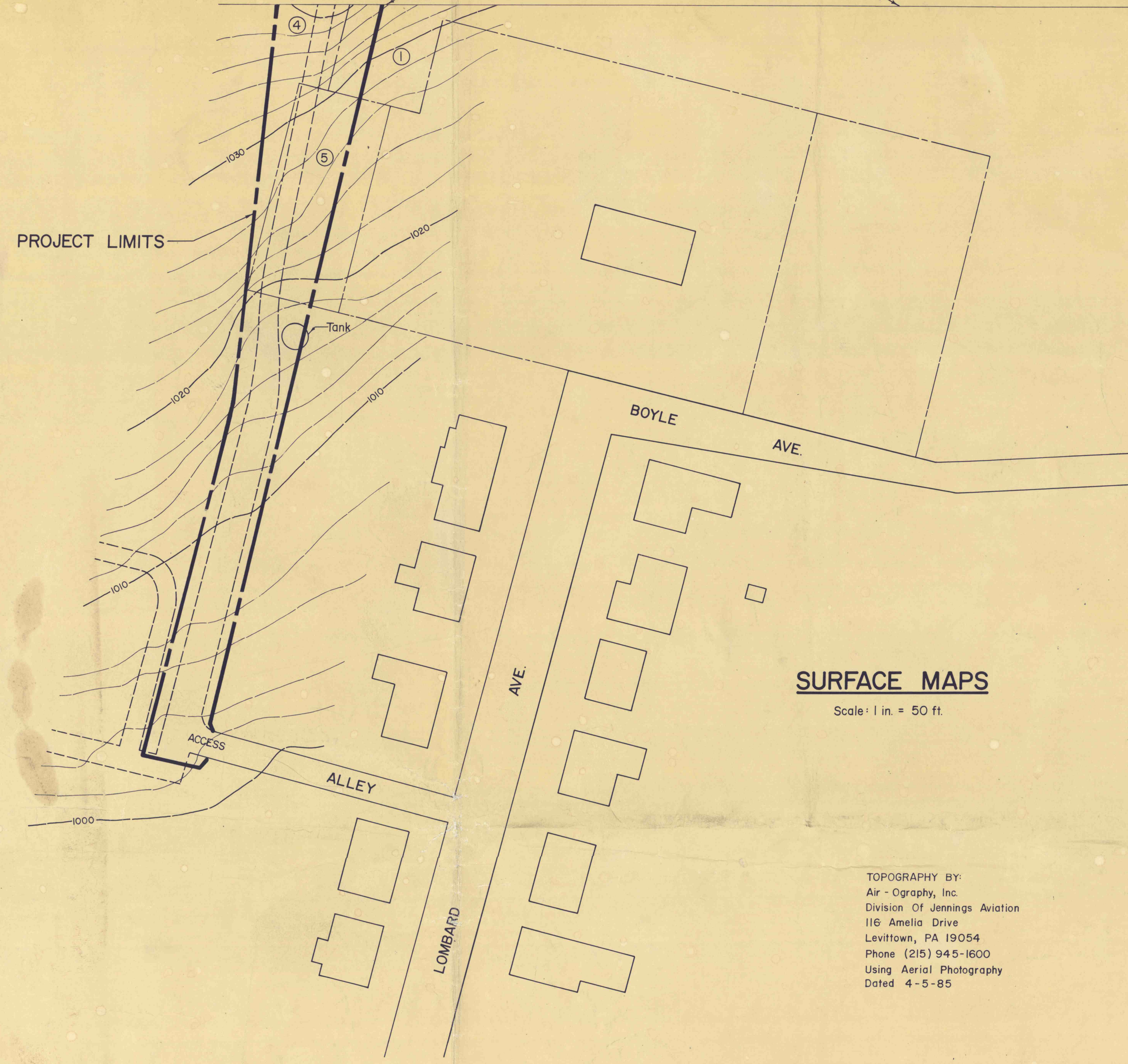

SURFACE MAPS

Scale: 1 in. = 50 ft.

TOPOGRAPHY BY:
Air - Ography, Inc.
Division Of Jennings Aviation
116 Amelia Drive
Levittown, PA 19054
Phone (215) 945-1600
Using Aerial Photography
Dated 4-5-85

LEGEND

- Project Limits
- Limits of Grading
- Existing Contours
- Proposed Contours
- Property Line
- Railroad Tracks

NOTE: The Project Shall Be Graded In The Following Sequence As Indicated In The Technical Specifications:

1. Area I
2. Area II
3. Area III

Area I And Area II May Be Done Simultaneously, If The Contractor Desires To Change The Sequence He Will Be Required To Obtain An Earth Disturbance Permit.

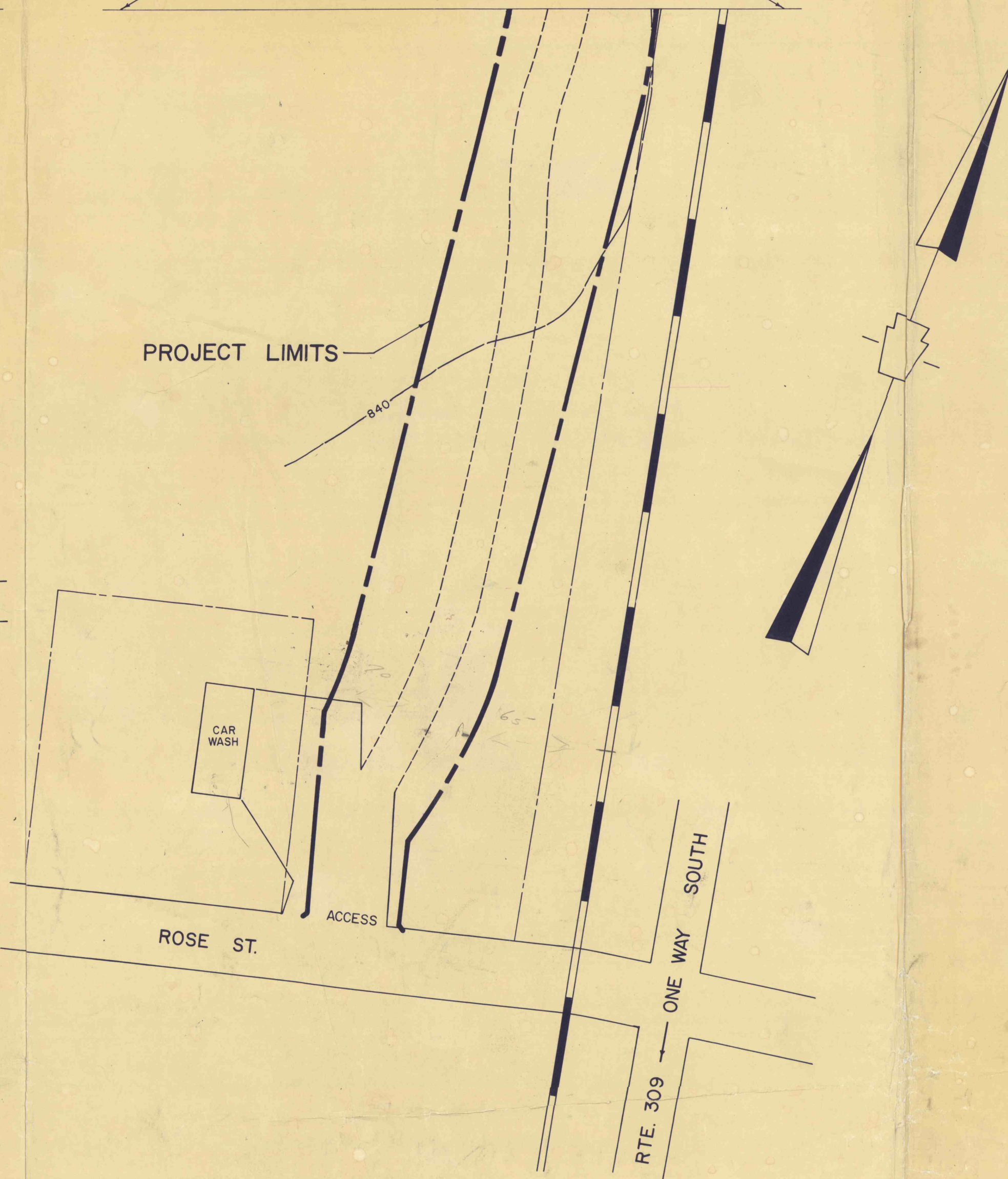

SURFACE OWNERS

- ① Tamaqua Area School District
Stadium Hill Road
Tamaqua, PA 18252
- ③ Consolidated Rail Corporation
Room 801
1528 Walnut Street
Philadelphia, PA 19102
- ⑤ Service Electric Cable
106 W. Broad Street
Tamaqua, PA 18252

MINERAL OWNER

- ② J.G. Lazar
R.D. 1, Box 396
Tamaqua, PA 18252
- ④ Reading Anthracite Corporation
200 Mahantongo Street
Pottsville, PA 17901

NOTE: The CONRAIL Right-Of-Way And Centerline Of Ditch Along The Right-Of-Way Is Staked In The Field.

PROJECT

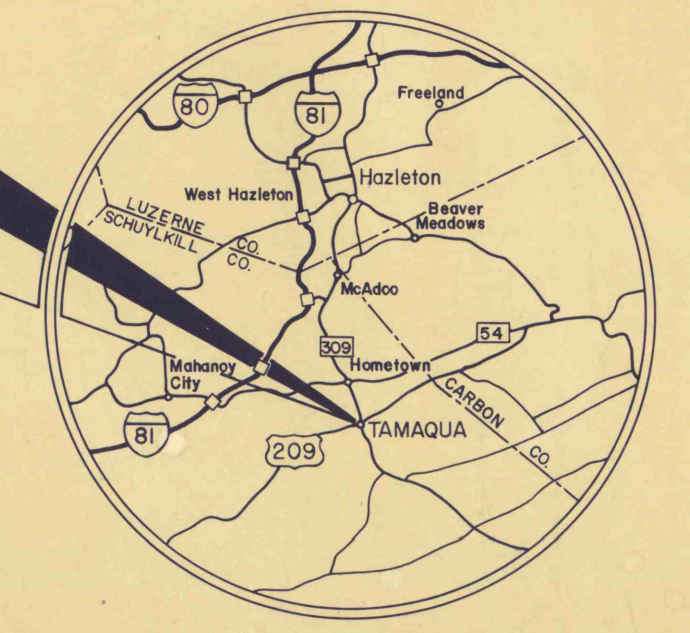

LOCATION MAP

Scale: 1 in. = 9 mi.

PROJECT

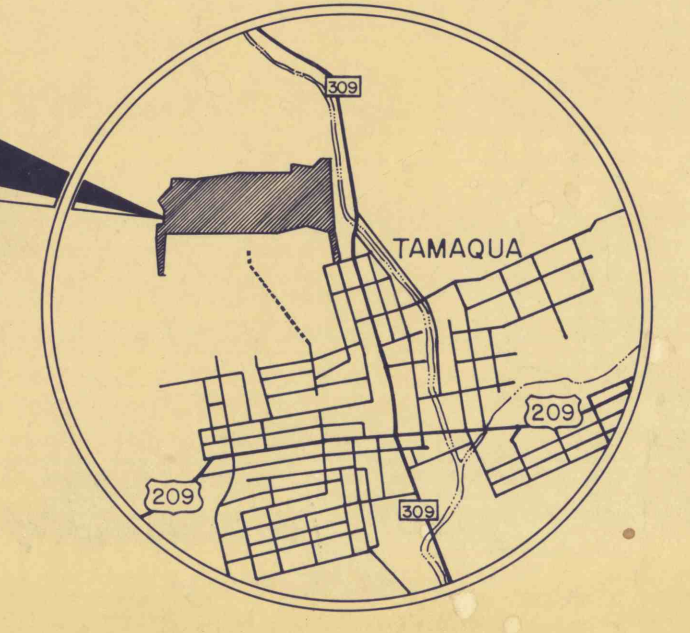

VICINITY MAP

Scale: 1 in. = 2666 ft.

NO.	DATE	REVISION	APPR.

SUBMITTED
Robert J. Fisher
CHIEF, DESIGN SECTION, WILKES-BARRE

APPROVED
Michael R. Terico
DISTRICT ENGINEER, WILKES-BARRE

APPROVED
Robert J. Fisher
DIRECTOR, BUREAU OF ABANDONED MINE RECLAMATION

COMMONWEALTH OF PENNSYLVANIA
DEPARTMENT OF ENVIRONMENTAL RESOURCES
OFFICE OF RESOURCES MANAGEMENT

PROJECT NO. O S M 54(3240)101.1

BACKFILLING ABANDONED ASHTON STRIP PITS
BOROUGH OF TAMAQUA
SCHUYLKILL COUNTY, PENNSYLVANIA

SURFACE, LOCATION AND VICINITY MAPS

DRAWN BY <i>J.S.F.</i>	DATE Jan. 13, 1988	DRAWING NO. 2 of 8
CHECKED BY <i>C.V.</i>	SCALE As Shown	

ALL DIMENSIONS AND EXISTING CONDITIONS SHALL BE CHECKED AND VERIFIED BY CONTRACTOR AT THE SITE.