

Match to Sheet 18

Match to Insert Above

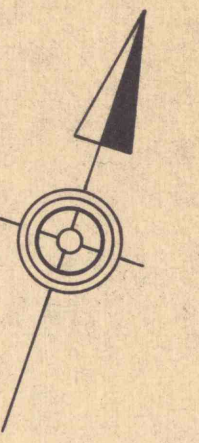
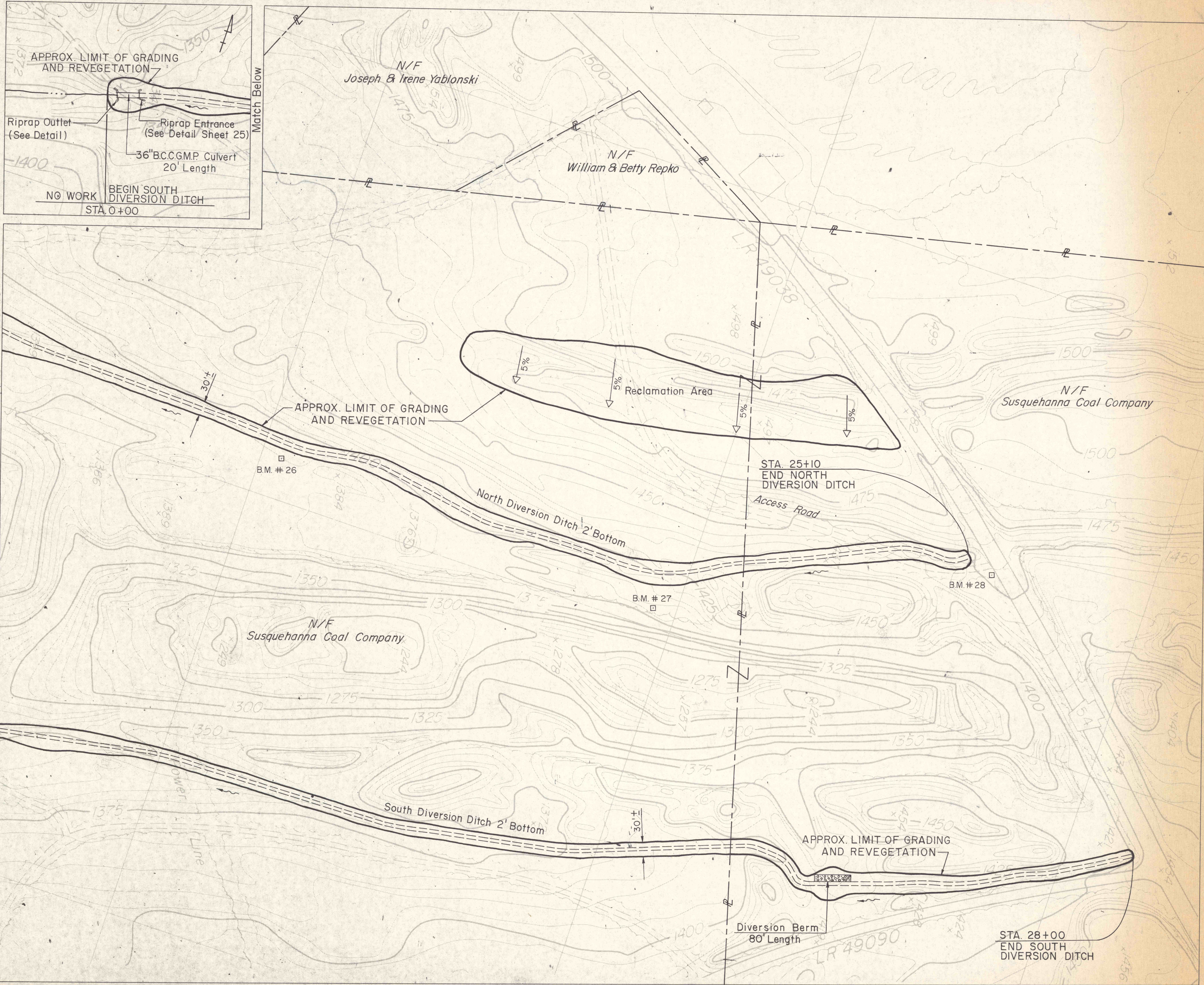

B.M. # 26 Elevation 1389.09
Spike & Washers in top of 8" Birch Stump

B.M. # 27 Elevation 1406.51
Spike & Washers in top of 6" Locust Stump

B.M. # 28 Elevation 1449.07
Spike & Washers in top of 6" Locust Stump

NO	DATE	REVISION	APPR.

COMMONWEALTH OF PENNSYLVANIA
DEPARTMENT OF ENVIRONMENTAL RESOURCES
OFFICE OF RESOURCES MANAGEMENT
PROJECT NO. SL 113-5-1
MINE DRAINAGE POLLUTION ABATEMENT
COAL RUN
SHAMOKIN CREEK WATERSHED
NORTHUMBERLAND COUNTY, PA.

ERDMAN, ANTHONY, ASSOCIATES
Consulting Engineers
Camp Hill, Pa. Rochester, N.Y.

PLAN	
DRAWN BY GMS	DATE
CHECKED BY	SCALE 1" = 100'
DRAWING NO. 19 of 26	