

- B.M. # 21 Elevation 1319.07
Spike & Washers in top of 5" Birch Stump
- B.M. # 22 Elevation 1345.99
Spike & Washers in top of 3" Birch Stump
- B.M. # 23 Elevation 1361.71
Spike & Washers in top of 6" Aspen Stump
- B.M. # 24 Elevation 1365.99
X-Cut in top of bolt in Concrete Post
- B.M. # 25 Elevation 1379.88
X-Cut on Metal Bar in Concrete Foundation

Match to Sheet 16

Match to Sheet 19

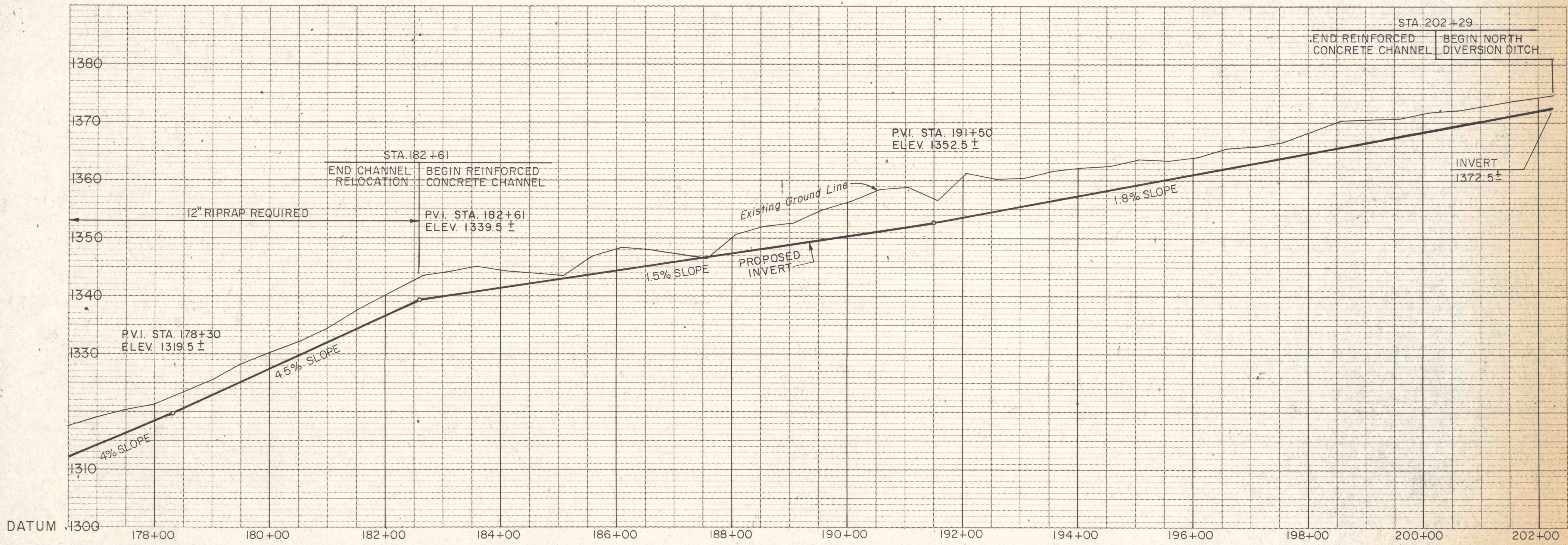
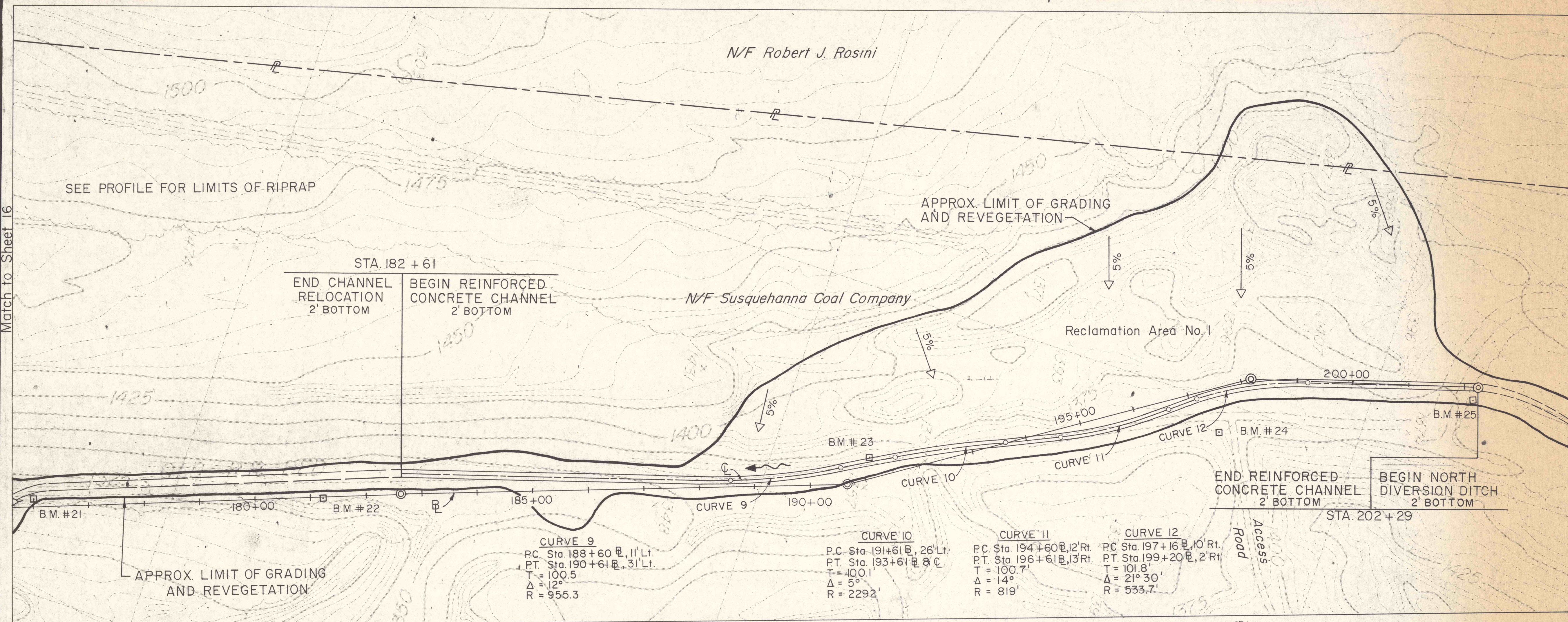

NO.	DATE	REVISION	APPR.
SUBMITTED			
PROFESSIONAL			
APPROVED			
CHIEF - DIVISION OF MINE RECLAMATION			
APPROVED			
DIRECTOR - BUREAU OF DESIGN			
COMMONWEALTH OF PENNSYLVANIA DEPARTMENT OF ENVIRONMENTAL RESOURCES OFFICE OF RESOURCES MANAGEMENT			
PROJECT NO. SL 113-5-1			
MINE DRAINAGE POLLUTION ABATEMENT COAL RUN SHAMOKIN CREEK WATERSHED NORTHUMBERLAND COUNTY, PA.			
ERDMAN, ANTHONY, ASSOCIATES Consulting Engineers Camp Hill, Pa. Rochester, N.Y.			
PLAN & PROFILE			
DRAWN BY	DATE	DRAWING NO.	
GMS		18 of 26	
CHECKED BY	SCALE 1"=10' VERT 1"=100' HOR.		