

Vein 9, 31
Coal 3' 6"
Map 6047

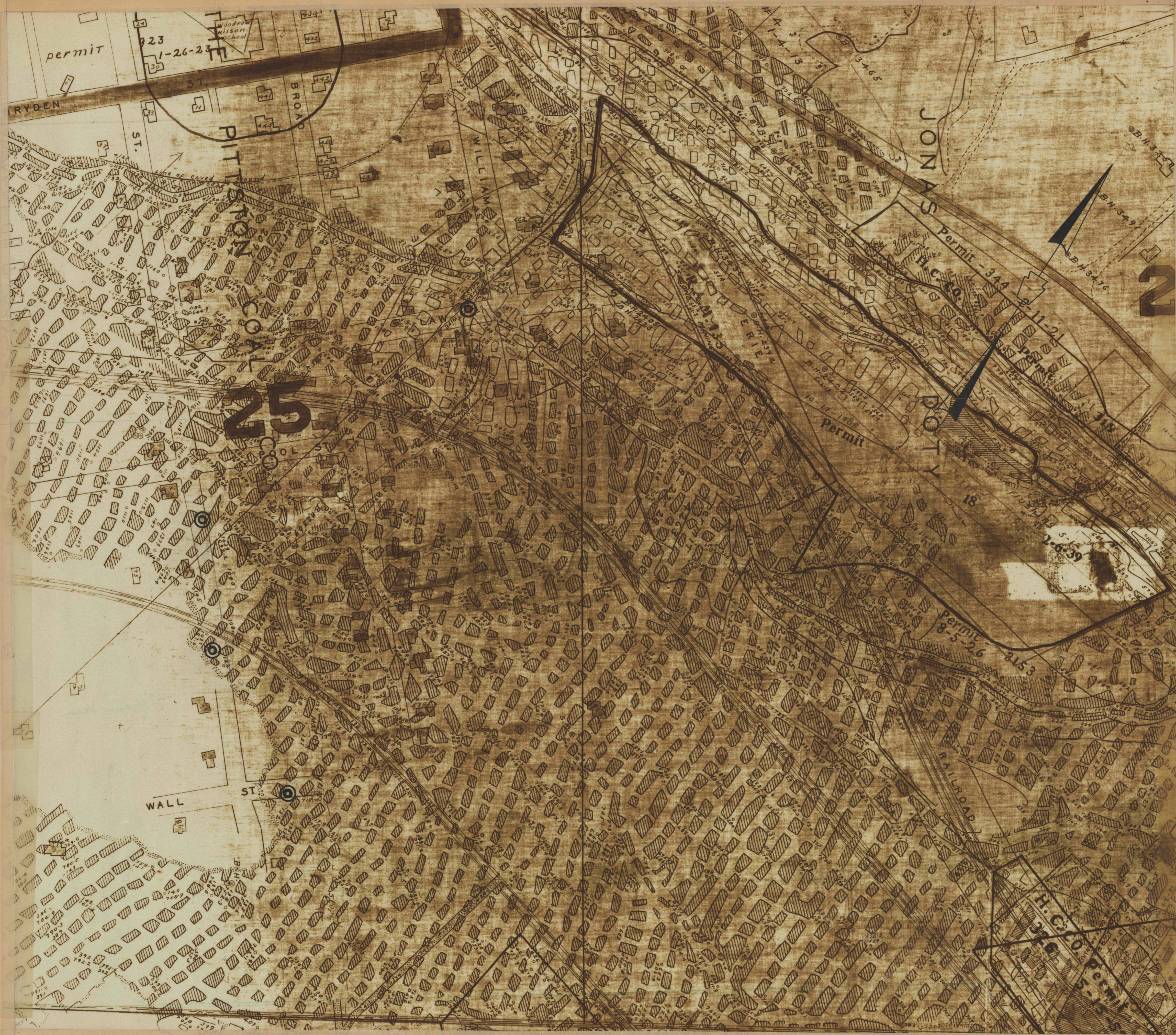

NO.	DATE	REVISION	APPR.

SUBMITTED _____
DESIGN ENGINEER

APPROVED *M. Yacino*
DISTRICT ENGINEER - ANTHRACITE

APPROVED _____
DIRECTOR - BUREAU OF RESOURCES PROGRAMMING

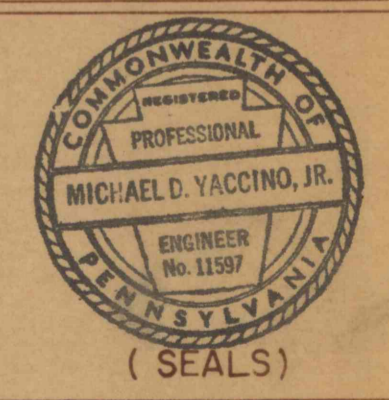

COMMONWEALTH OF PENNSYLVANIA
DEPARTMENT OF ENVIRONMENTAL RESOURCES
OFFICE OF RESOURCES MANAGEMENT

PROJECT NO. **SL-451**
TITLE **CORE BORING SUB-SURFACE INVESTIGATION**
PITTSBURGH TOWNSHIP
LUZERNE COUNTY, PENNA.

SHEET DESCRIPTION
BUTLER COLLIERY
PITTSBURGH VEIN

DRAWN BY	DATE	DRAWING NO.
CHECKED BY	SCALE AS SHOWN	SL-451-1.2