

1-19 79  
1-28  
1-28  
1-28

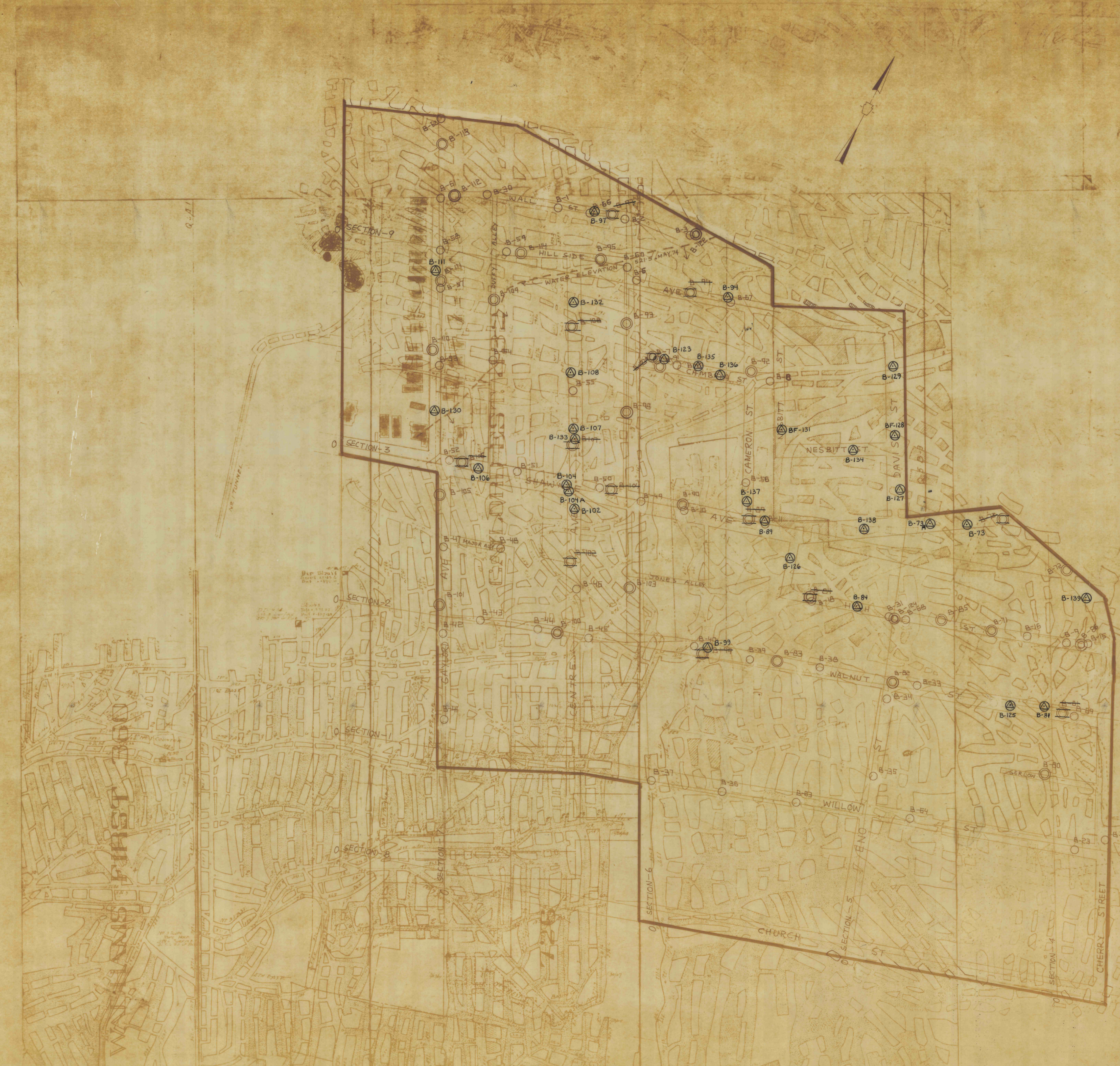
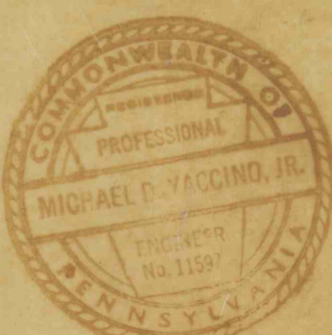
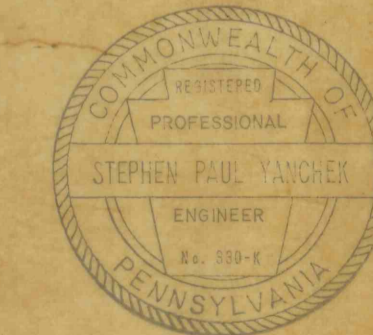

**LEGEND -**  
 ○ exploratory boreholes already drilled.  
 ⊙ injection holes to be drilled.

1-19 79	Relocated or Additional	
	Deleted Boreholes	
NO. DATE	REVISION	APPROVED
DRAWN BY <i>Stephen P. Zanichelli P.E.</i>		
APPROVED <i>[Signature]</i> DISTRICT ENGINEER ANTHRACITE REGION		
APPROVED <i>S. F. Kyle for</i> DIRECTOR OF ENVIRONMENTAL RESOURCES MANAGEMENT		
 		
COMMONWEALTH OF PENNSYLVANIA DEPARTMENT OF ENVIRONMENTAL RESOURCES OFFICE OF RESOURCES MANAGEMENT		
<b>PROJECT NO. A.S.P. 16</b>		
<b>FILLING MINE VOIDS</b>		
<b>SHAWNEE AVENUE AREA, LUZERNE COUNTY, PLYMOUTH BORO, PENNA.</b>		
<b>ABANDONED NOTTINGHAM COLL'Y BOTTOM BALTIMORE VEIN</b>		
DRAWN BY	DATE	CHECKED BY
SCALE 1"=100'		ASP 16-14