

PROJECT

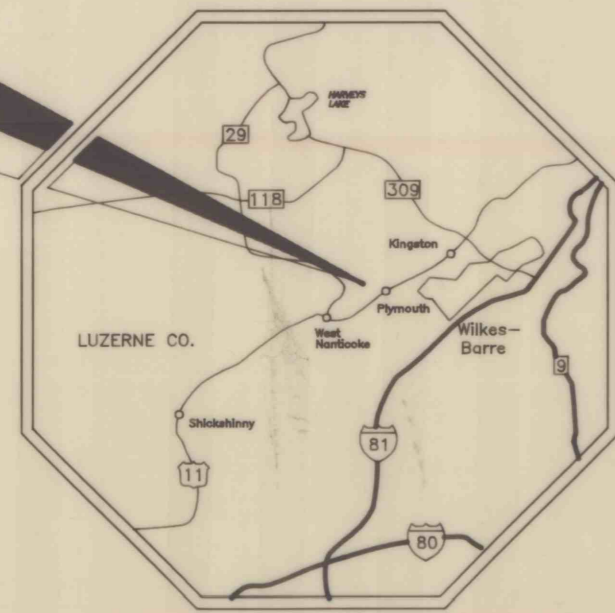

LOCATION MAP

SCALE: 1 in. = 9 mi.

PROJECT

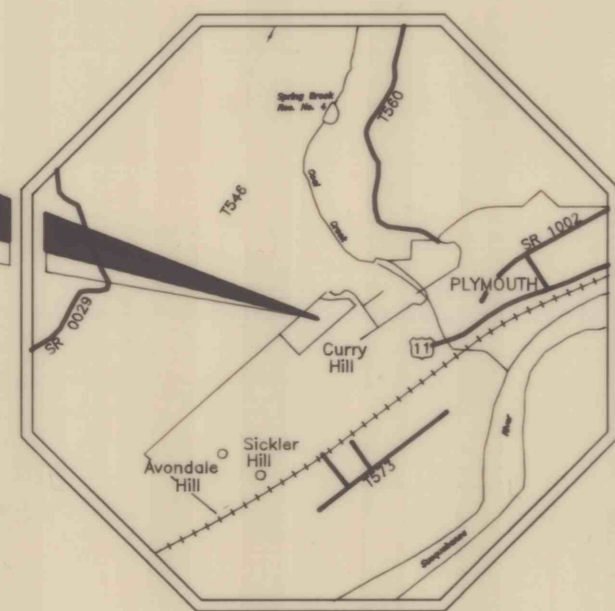

VICINITY MAP

SCALE: 1 in. = 1 mi.

LEGEND

- PROJECT LIMIT
- LIMIT OF GRADING
- DITCH
- EXISTING CONTOURS
- PROPOSED 10 CONTOURS
- PROPOSED 2 CONTOURS
- FILTER FABRIC FENCE
- WILDLIFE HABITAT
- BOUNDARY BETWEEN GRADING AREAS
- POSSIBLE EXISTING SLOPES

CAUTION

THE CONTRACTOR IS CAUTIONED ABOUT THE POSSIBLE SLOPES LOCATED WITHIN THE PROJECT. THEREFORE THE CONTRACTOR SHALL EXERCISE EXTREME CARE IN THE VICINITY OF THE SLOPES WHEN EXECUTING THE ITEMS OF WORK.

SPECIAL ATTENTION IS DRAWN TO "SPECIAL REQUIREMENT NO. 10 SAFETY" IN THE CONTRACT DOCUMENTS. THE CONTRACTOR SHALL STRICTLY ADHERE TO THIS REQUIREMENT.

NOTE:

THERE ARE NO KNOWN SUBSURFACE UTILITIES WITHIN THE PROJECT LIMITS. WILDLIFE HABITATS AND FILTER FABRIC FENCE SHOWN OUTSIDE OF LIMITS OF GRADING FOR CLARITY.

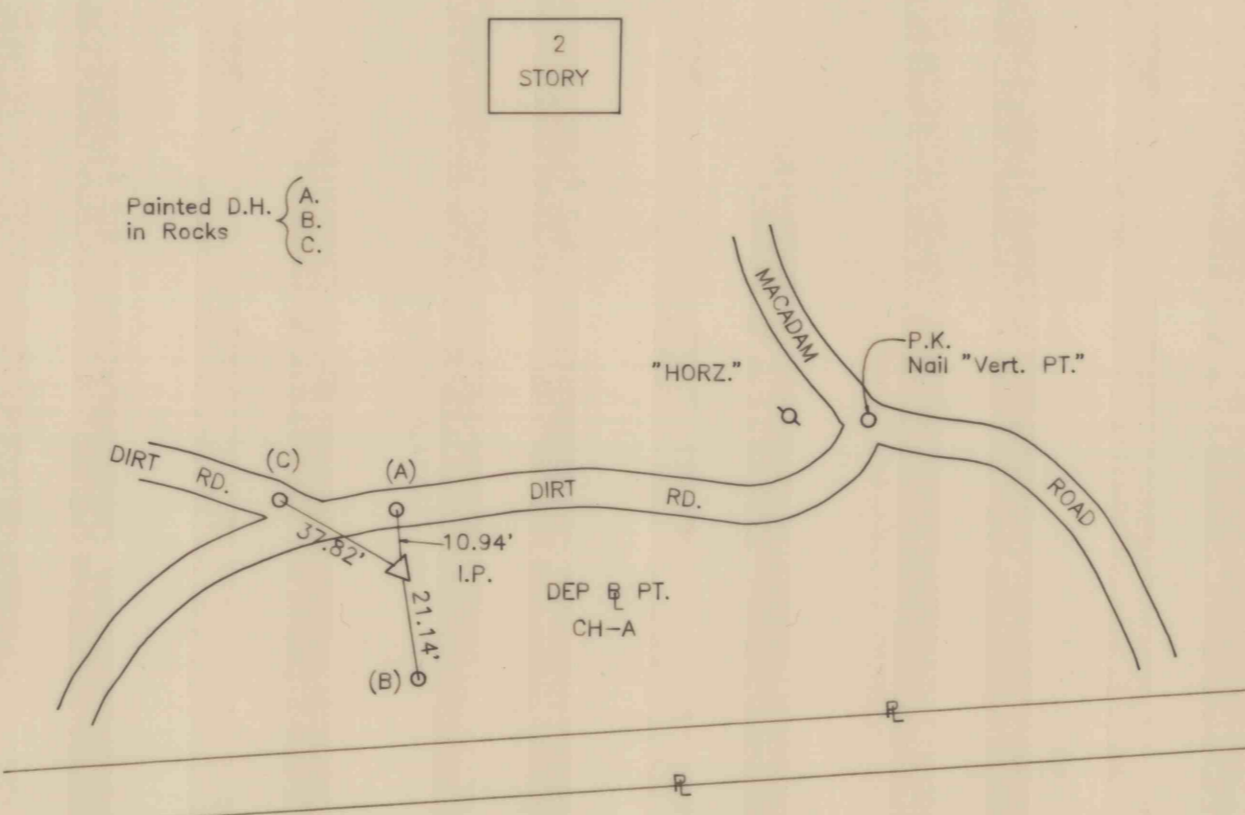

SURVEY REFERENCE CH-A (Not To Scale)

PROPERTY OWNER

Earth Conservancy
101 South Main Street
Ashley, PA. 18706

PROJECT LIMIT

Limit Of Grading

GRADING AREA A

MATCH LINE TO SHEET 3 OF 6

SURFACE MAP

Scale: 1 in. = 50 ft.

NO.	DATE	REVISION	APPR.

SUBMITTED *San Paris*
PROJECT DESIGNER, WILKES-BARRE

APPROVED *Theodore J. Fisher, Jr.*
CHIEF, DESIGN SECTION, WILKES-BARRE

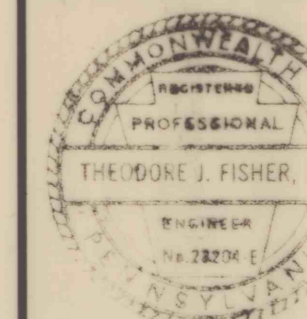

COMMONWEALTH OF PENNSYLVANIA
DEPARTMENT OF ENVIRONMENTAL PROTECTION
CONTRACT NO. OSM 40(2138)101.1

BACKFILLING STRIP PIT
CURRY HILL - AVONDALE
PLYMOUTH TOWNSHIP
LUZERNE COUNTY, PENNSYLVANIA

LOCATION, VICINITY, AND SURFACE MAPS

DRAWN BY <i>G.P.F.</i>	DATE MAR. 7, 1996	DRAWING NO. 2 of 6
CHECKED BY <i>V.T.Q.</i>	SCALE As Shown	

ALL DIMENSIONS AND EXISTING CONDITIONS SHALL BE CHECKED AND VERIFIED BY CONTRACTOR AT THE SITE.