

- LEGEND**
- : EXISTING GRADE
  - - - : FINISHED GRADE
  - (100) : EXISTING GRADE
  - (700) : FINISHED GRADE
  - ◇ : DITCH TYPE SEE DWG. #D-1

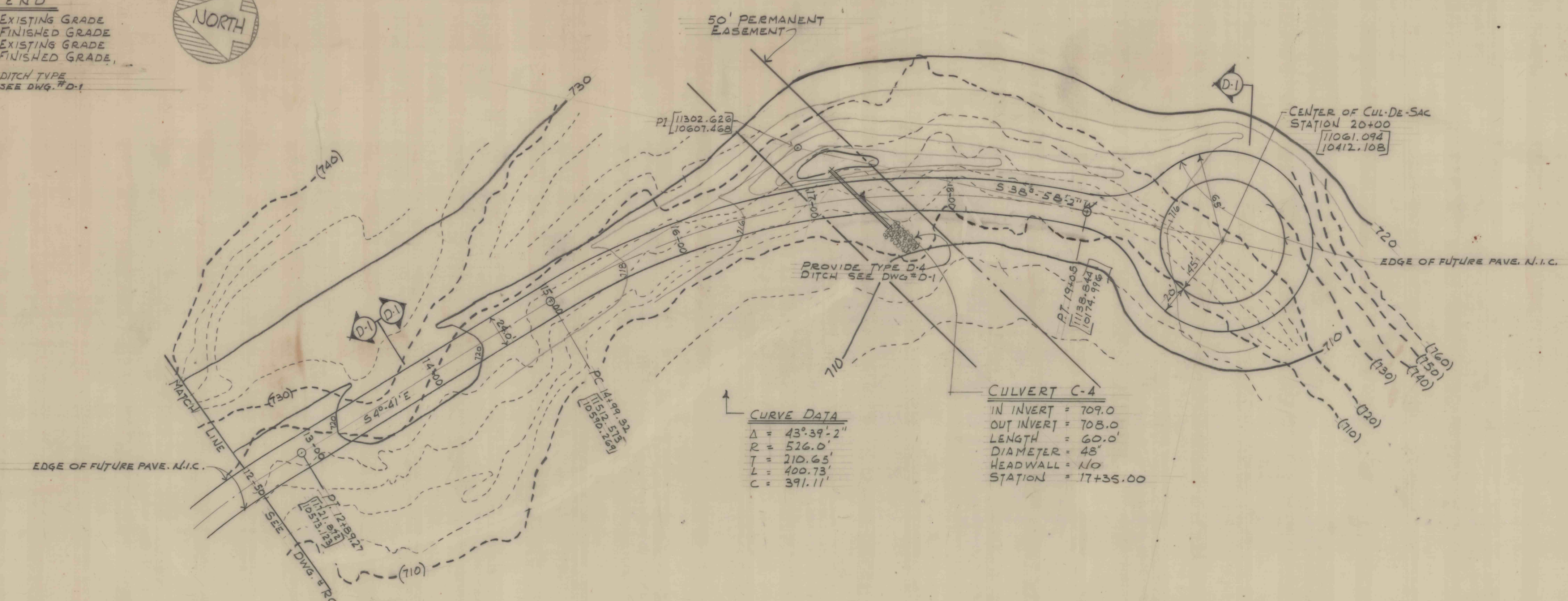

Note: For finish contours, see new Plan drawings No. A1 of 3 thru A3 of 3.

**PLAN**  
1" = 50.0'

10-85 As built NO. DATE REVISION APPR.		CONTRACT NO. ASMR-18	
SUBMITTED PROFESSIONAL		STRIP MINE RESTORATION SOLOMON CREEK WATERSHED WILKES-BARRE TWP. LUZERNE CO., PA	
APPROVED CHIEF - DIVISION OF MINE RECLAMATION		LACY, ATHERTON & DAVIS ARCHITECTS & ENGINEERS	
APPROVED DIRECTOR - BUREAU OF DESIGN		WILKES-BARRE HARRISBURG WILLIAMSPORT	
COMMONWEALTH OF PENNSYLVANIA DEPARTMENT OF ENVIRONMENTAL RESOURCES OFFICE OF RESOURCES MANAGEMENT		ROADWAY PLAN & PROFILE	
DRAWN BY CHECKED BY		DATE 4-28-80	DRAWING NO. RC-2