

493
236
257

80' 7" 1/2
103' 1" 1/2
14' 1" 1/2

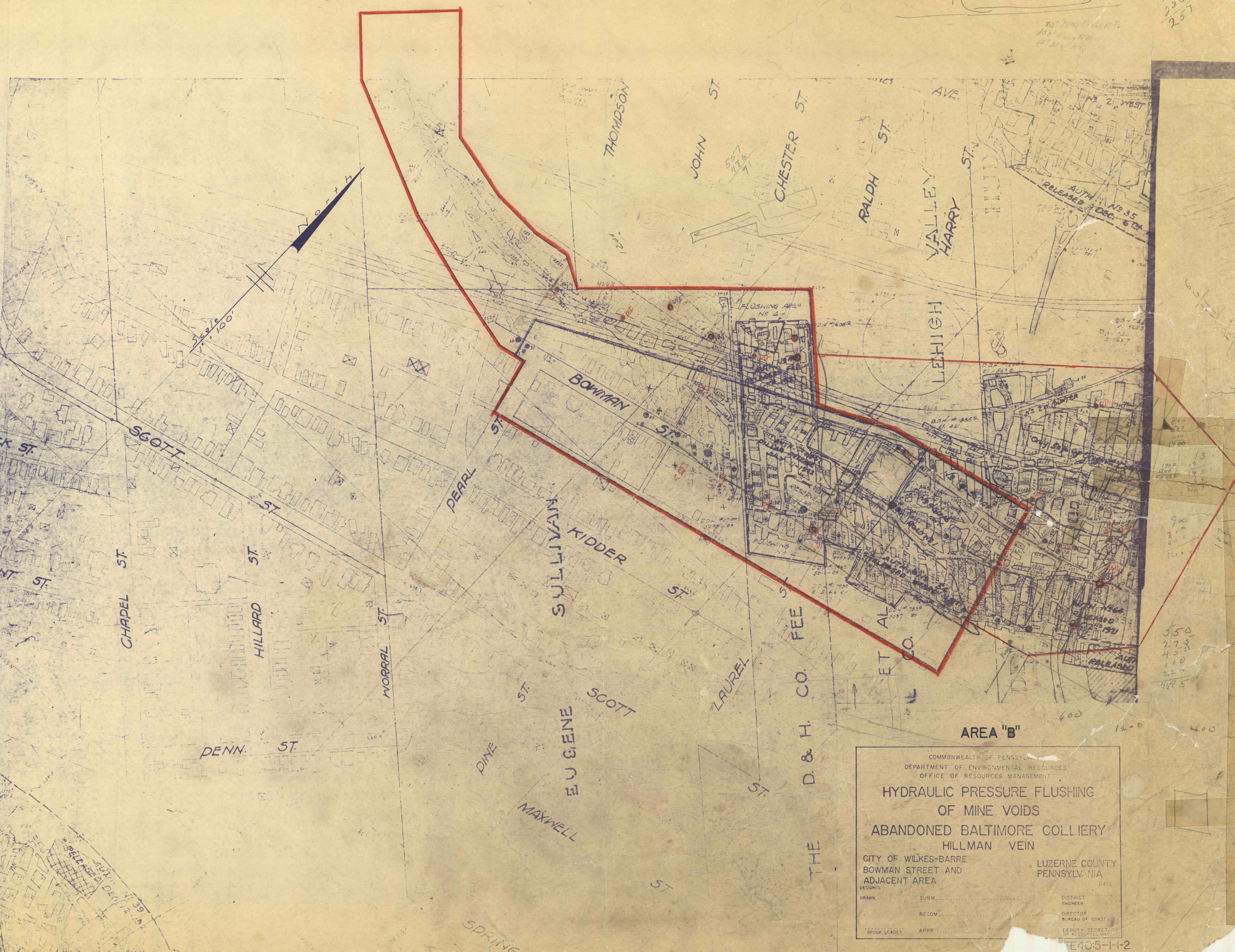

13
1700
145
1700
145
1700
145

900
300
400
100
1000
1100

550
275
40
110
200
1825

197
1200
400

AREA "B"

COMMONWEALTH OF PENNSYLVANIA
 DEPARTMENT OF ENVIRONMENTAL RESOURCES
 OFFICE OF RESOURCES MANAGEMENT

**HYDRAULIC PRESSURE FLUSHING
 OF MINE VOIDS
 ABANDONED BALTIMORE COLLIERY
 HILLMAN VEIN**

CITY OF WILKES-BARRE
 BOWMAN STREET AND
 ADJACENT AREA

LUZERNE COUNTY
 PENNSYLVANIA

DESIGNED _____ DATE _____
 DRAWN _____ SUBM. _____ DISTRICT ENGINEER _____
 RECOM. _____ DIRECTOR _____
 GROUP LEADER _____ APPR. _____ DEPUTY SECRETARY OF RESOURCES MANAGEMENT _____

TE405-11-2