

TRAVERSE DATA

Traverse Station	Coordinates	
	North	East
34+33.80 B	10,945.699	9,257.719
37+79.30 B	10,629.693	9,397.512
41+03.58 B	10,410.212	9,158.778

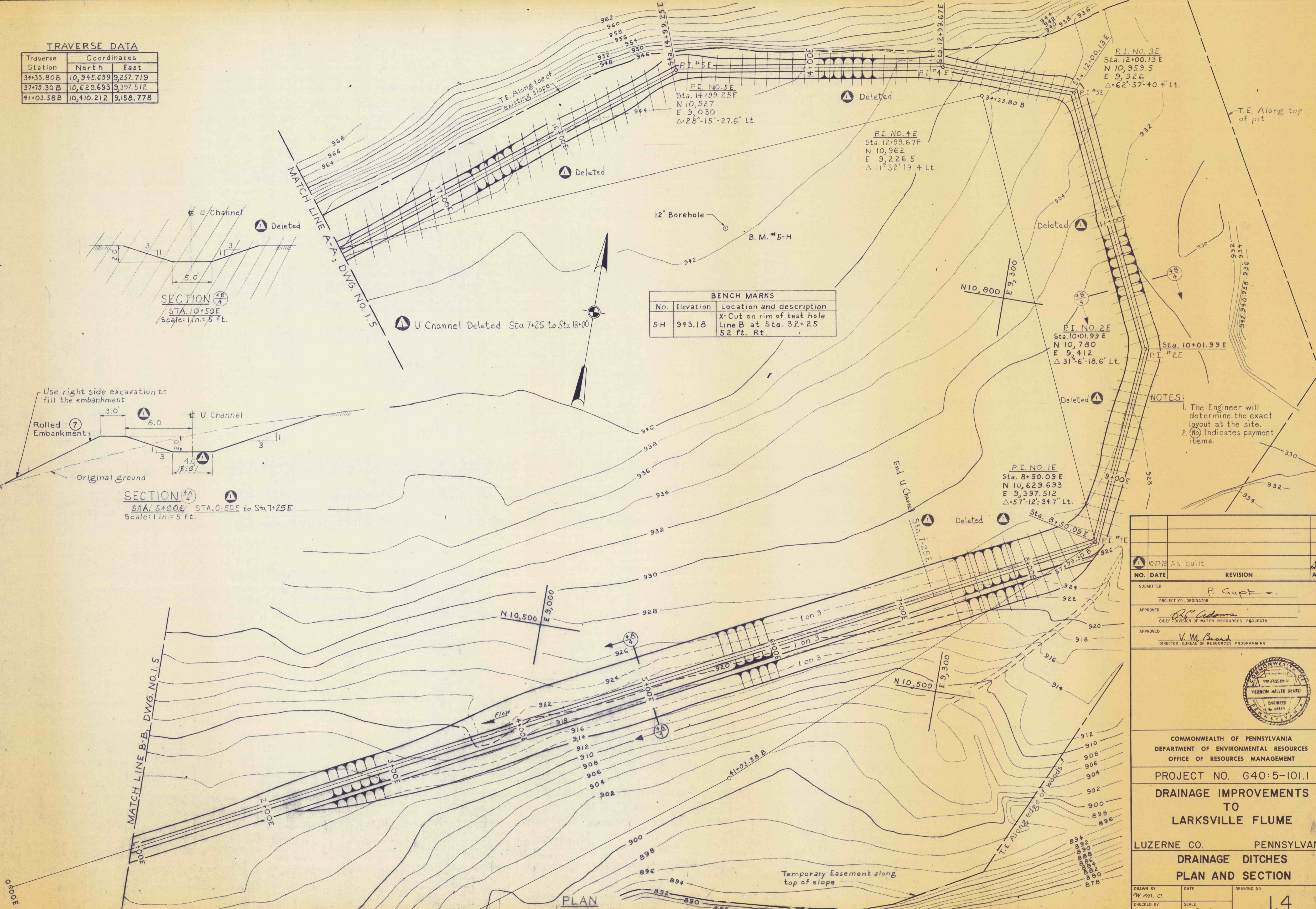

SECTION 4B
 STA. 10+50E
 Scale: 1 in. = 5 ft.

SECTION 4A
 STA. 5+00E to STA. 7+25E
 Scale: 1 in. = 5 ft.

BENCH MARKS		
No.	Elevation	Location and description
5-H	943.18	X-Cut on rim of test hole Line B at Sta. 32+25 52 ft. Rt.

- NOTES:**
1. The Engineer will determine the exact layout at the site.
 2. (No) Indicates payment items.

NO.	DATE	REVISION	APPR.
102778		As built	
SUBMITTED			
PROJECT CO-ORDINATOR			
APPROVED <i>P. Gupta</i>			
CHIEF DIVISION OF WATER RESOURCES PROJECTS			
APPROVED <i>V. M. Beard</i>			
DIRECTOR - BUREAU OF RESOURCES PROGRAMMING			



COMMONWEALTH OF PENNSYLVANIA
 DEPARTMENT OF ENVIRONMENTAL RESOURCES
 OFFICE OF RESOURCES MANAGEMENT

PROJECT NO. G40:5-101.1
**DRAINAGE IMPROVEMENTS
 TO
 LARKSVILLE FLUME**

LUZERNE CO. PENNSYLVANIA
**DRAINAGE DITCHES
 PLAN AND SECTION**

DRAWN BY <i>W. M. C.</i>	DATE	DRAWING NO.
CHECKED BY	SCALE As shown	1.4