

MATCH LINE - SEE SHEET NO. I.1A

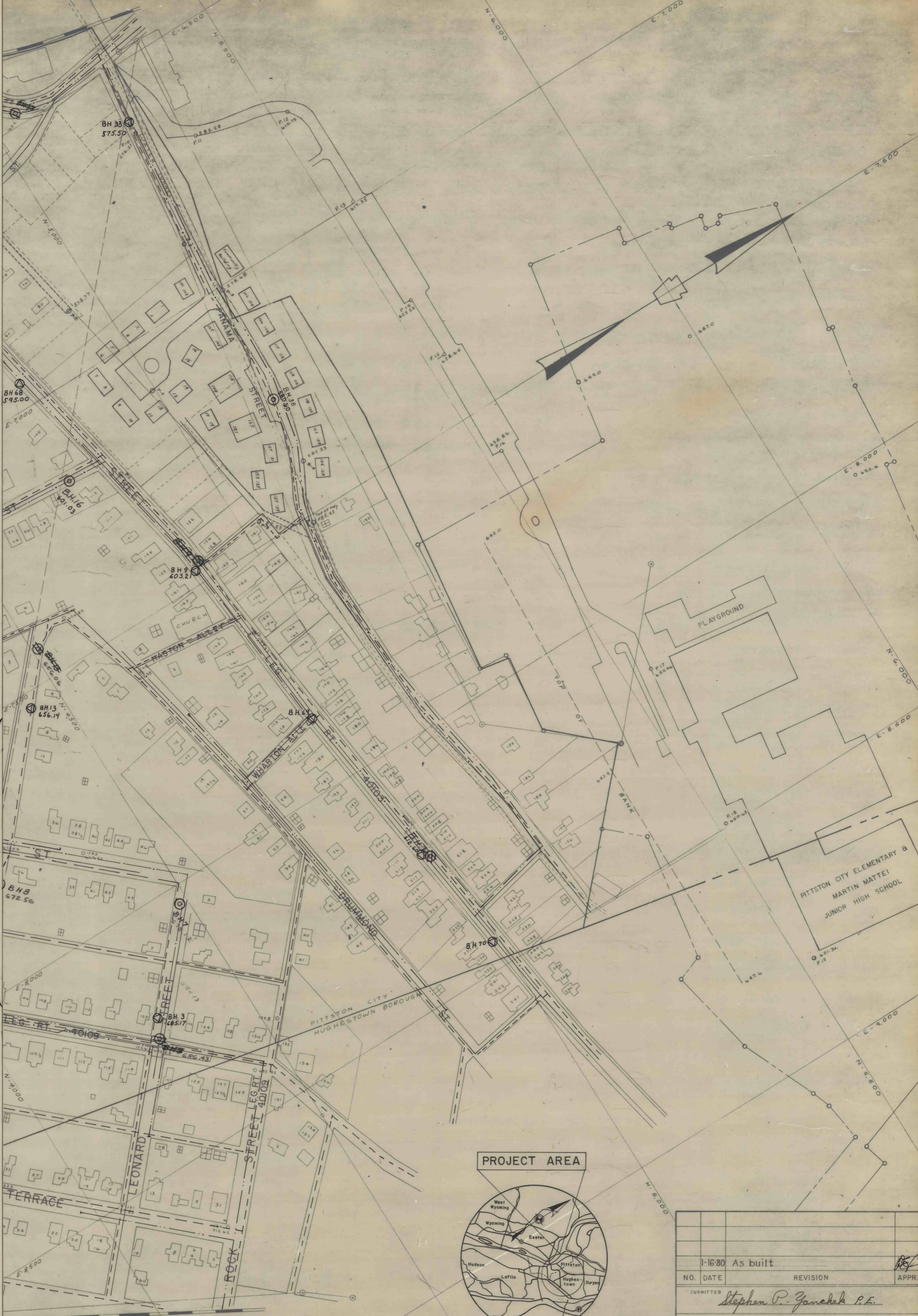

PROJECT AREA

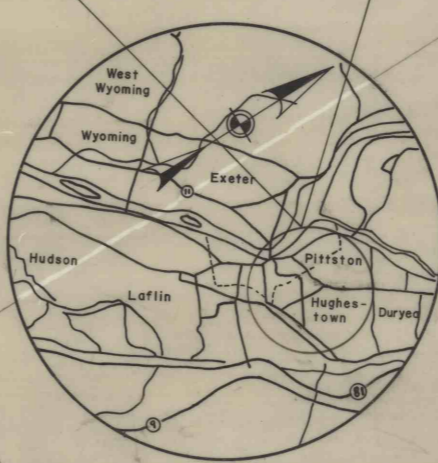

LOCATION MAP

PROJECT AREA

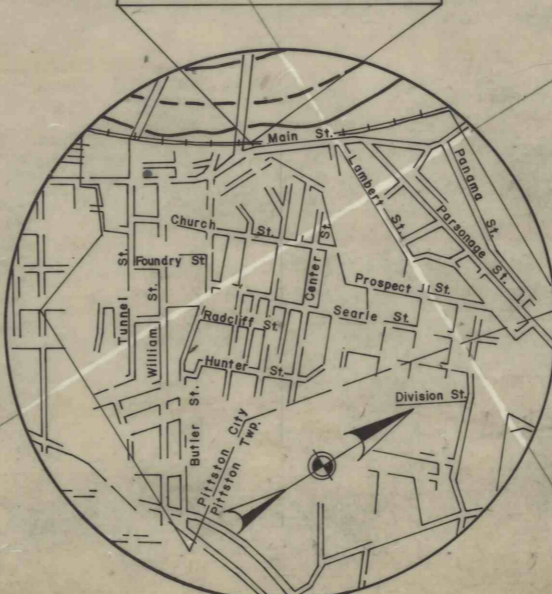

SITE PLAN

LEGEND

- WATER LINE
 PENNA. GAS & WATER COMPANY
 39 PUBLIC SQUARE
 WILKES-BARRE, PENNA. 18711
 TEL. (717) 824-8711 EXT. 168
 P.G. & W. SERIAL NO. CM-268
- GAS LINE
 PITTSTON GAS COMPANY
 21 BROAD ST.
 PITTSTON, PENNA. 18640
 TEL. (717) 654-3353
- ELECTRIC LINE
 PENNA. POWER & LIGHT COMPANY
 344 SOUTH POPLAR ST.
 HAZLETON, PENNA. 18201
 TEL. (717) 454-6641
 P.P. & L. SERIAL NO. 2-1745
- SEWER LINE
 THOMAS CONNORS
 STREET COMMISSIONER
 CITY HALL
 PITTSTON, PENNA. 18640
 TEL. (717) 654-1160

⊙ Relocated and New Boreholes

NO.	DATE	REVISION	APPR.
	1-16-80	As built	
SUBMITTED		<i>Stephen P. Zanehek P.E.</i>	
APPROVED		<i>V.M. Bond</i>	
APPROVED			

COMMONWEALTH OF PENNSYLVANIA
 DEPARTMENT OF ENVIRONMENTAL RESOURCES
 OFFICE OF RESOURCES MANAGEMENT
PROJECT NO.- SL 470-101.5
**DRILLING EXPLORATORY BOREHOLES
 AT THE
 ABANDONED NO. 9 COLLIERY**
 CITY OF PITSTON, LUZERNE CO., PENNA.
**NO. 9 COLLIERY
 SURFACE MAP**

DRAWN BY	DATE	DRAWING NO.
CHECKED BY	MARCH-78	
	SCALE 1" = 100'	1.1