

STA. 70+90 TO STA. 71+00
TRANSITION FROM 10' WIDE CONC.
CHANNEL TO 12' WIDE CONC. CHANNEL.

EXIST. CONC. BOX CULVERT
12'-0" WIDE
6'-6" HIGH
INV. 660.3 (IN)
INV. 659.9 (OUT)

CURVE DATA TABLE

Curve No.	P.I. Coordinates		P.I. Station	Δ	D	R	T	L	P.C. Station	P.T. Station
	North	East								
8	382,041.03	2,501,307.07	75+56.71	58°57'29" RT.	28°38'52"	200.00'	113.06'	205.80'	74+43.65	76+49.45
9	382,579.02	2,501,179.03	80+89.41	69°25'20" LT.	38°11'50"	150.00'	103.91'	181.75'	79+85.50	81+67.25

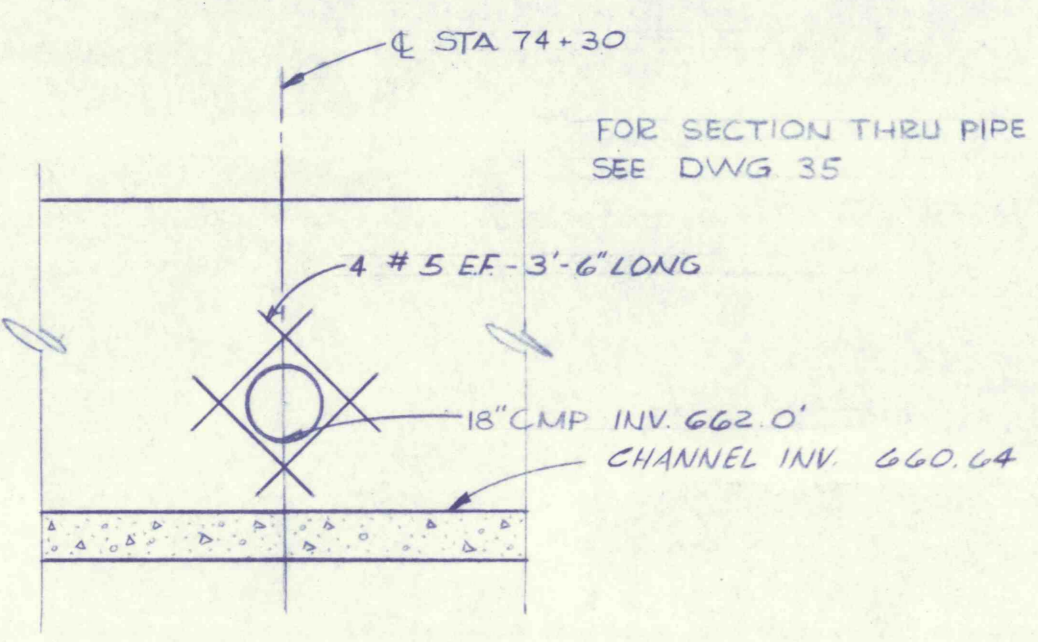

DETAIL "A"
SCALE: 1/4 IN. = 1 FT.

PLAN
SCALE: 1 IN. = 50 FT.

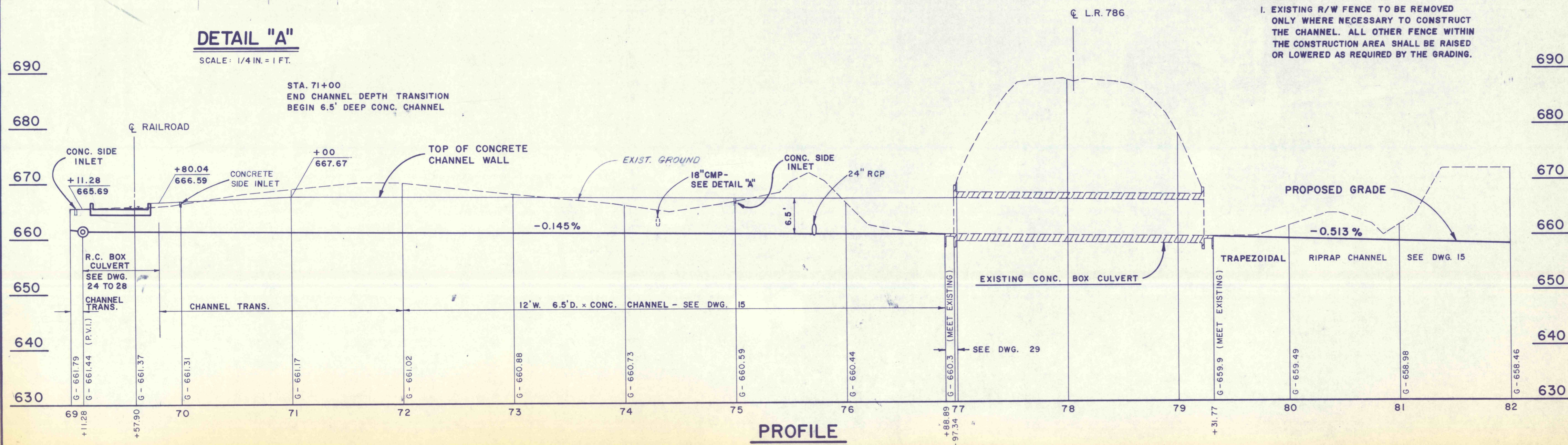

PROFILE

NOTES:
1. EXISTING R/W FENCE TO BE REMOVED ONLY WHERE NECESSARY TO CONSTRUCT THE CHANNEL. ALL OTHER FENCE WITHIN THE CONSTRUCTION AREA SHALL BE RAISED OR LOWERED AS REQUIRED BY THE GRADING.

NO.	DATE	REVISION	APPR.
SUBMITTED			
APPROVED			
APPROVED			

FINAL

S.J.M. JUL 28 1977

COMMONWEALTH OF PENNSYLVANIA
DEPARTMENT OF ENVIRONMENTAL RESOURCES
OFFICE OF RESOURCES MANAGEMENT

CONTRACT NO. SL 181-3-101.1

SUGAR NOTCH RUN AMD
ABATEMENT PROJECT
WARRIOR CREEK AND
SOLOMON CREEK WATERSHEDS

GEO-Technical Services
CONSULTING ENGINEERS & GEOLOGISTS
851 So. 19th St. HARRISBURG, PENNA.

PLAN & PROFILE
STA. 69+00 TO STA. 82+00