

Curves No. 1

PI - 9152.04
A - 67° 47'
R - 250.00
T - 149.53
L - 269.52

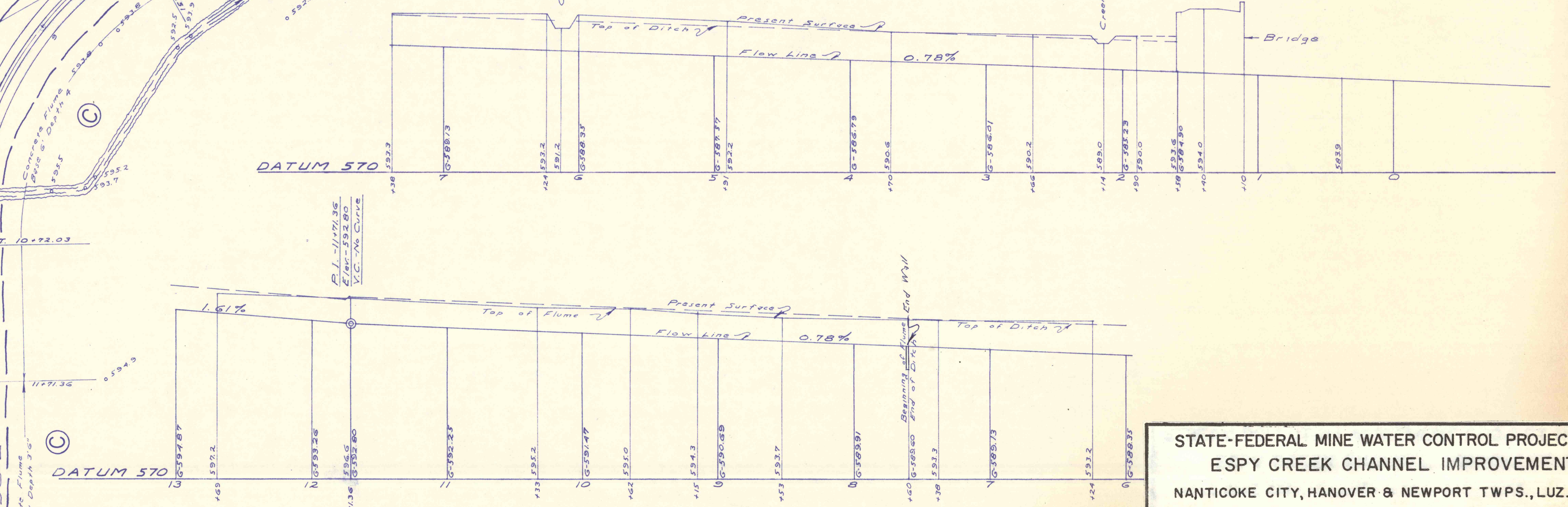
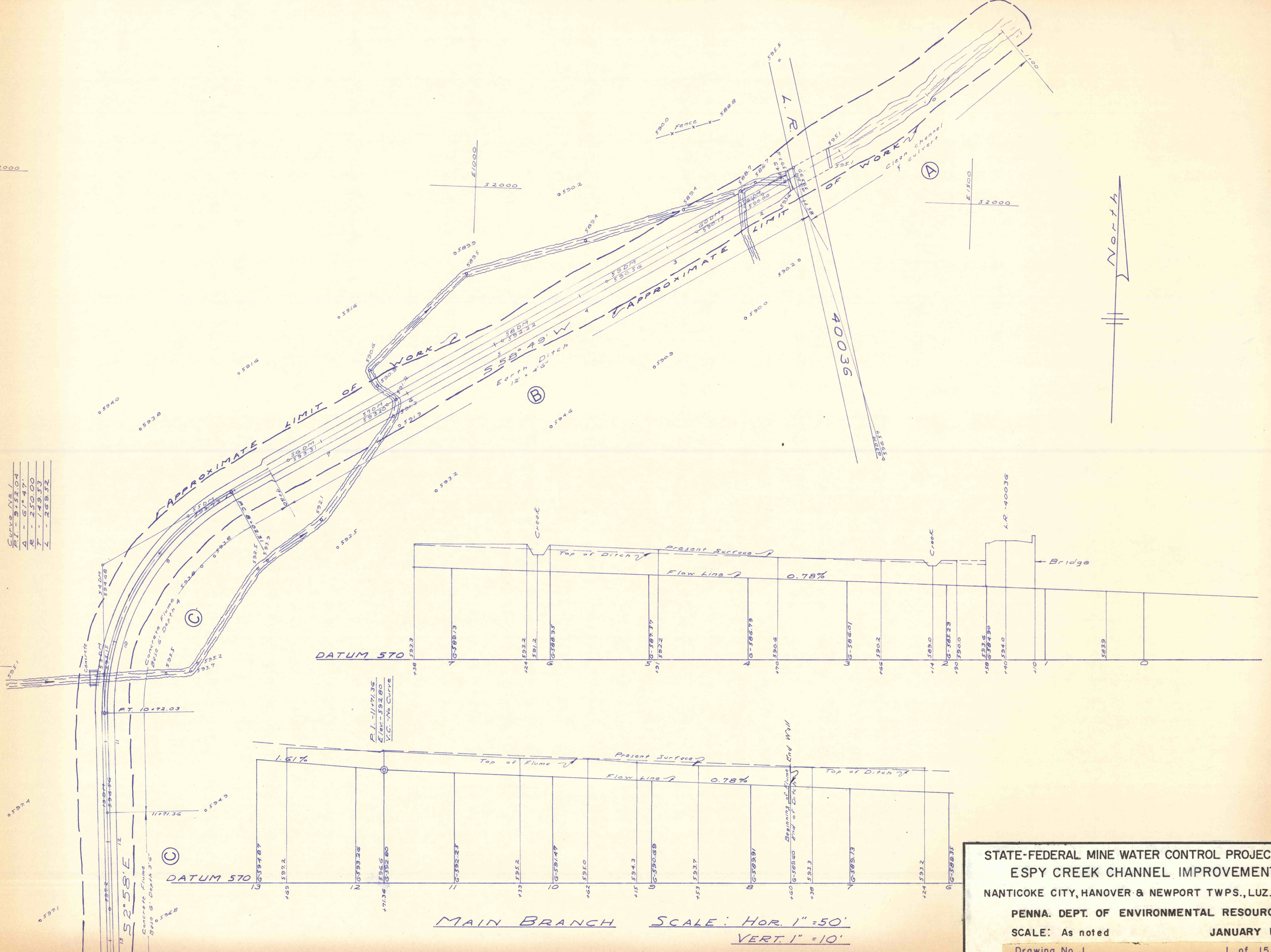
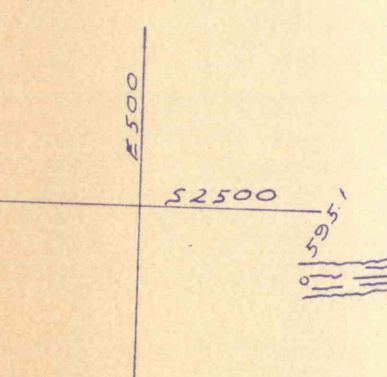

DATUM 570

PI - 1171.36
Elev - 592.80
V.C. - 7% Curve

13	6+394.87	160	592.2
12	6+393.26	159	592.2
11	6+392.23	158	592.2
10	6+391.47	157	592.2
9	6+390.69	156	592.2
8	6+389.91	155	592.2
7	6+389.13	154	592.2
6	6+388.35	153	592.2
5	6+387.57	152	592.2
4	6+386.79	151	592.2
3	6+386.01	150	592.2
2	6+385.23	149	592.2
1	6+384.45	148	592.2
0	6+383.67	147	592.2

MAIN BRANCH SCALE: HOR. 1" = 50'
VERT. 1" = 10'

STATE-FEDERAL MINE WATER CONTROL PROJECT NO. —
 ESPY CREEK CHANNEL IMPROVEMENTS
 NANTICOKE CITY, HANOVER & NEWPORT TWPS., LUZ. CO., PA.
 PENNA. DEPT. OF ENVIRONMENTAL RESOURCES
 SCALE: As noted
 Drawing No. 1

JANUARY 1971
 1 of 15