

WYOMING VALLEY WEST SCHOOL DISTRICT  
SITE NO. 12

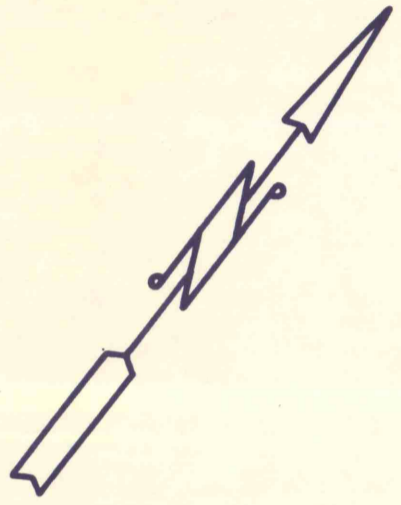

**LEGEND**

-  ACCEPTABLE  
0.0' - 0.5' of subsidence
-  CONDITIONALLY ACCEPTABLE  
0.5' - 1.7' of subsidence
-  NOT ACCEPTABLE  
OVER 1.7' of subsidence
-  SCHOOL SITE BOUNDARY

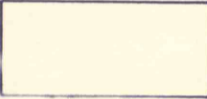
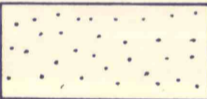
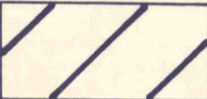
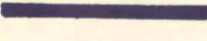
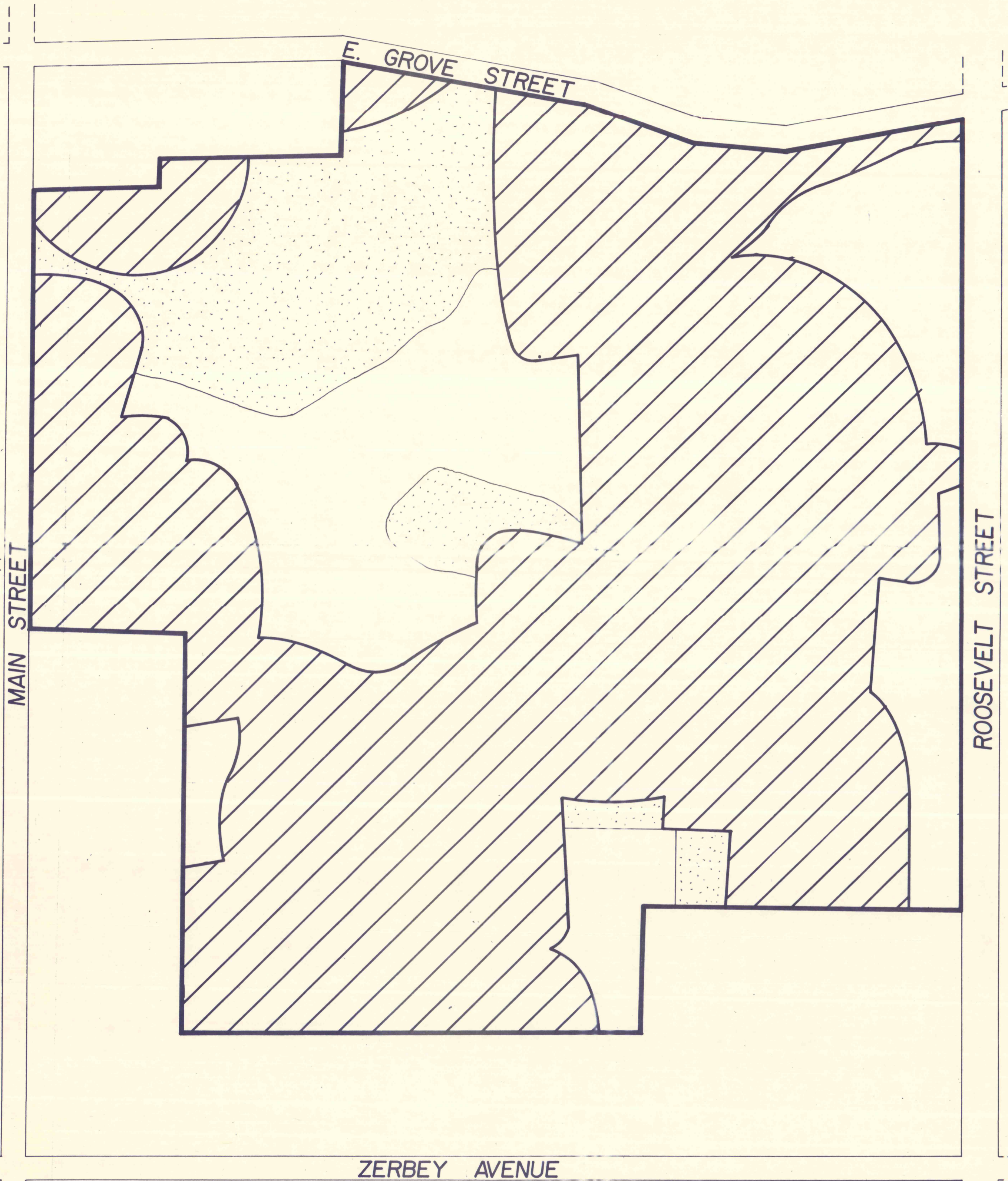
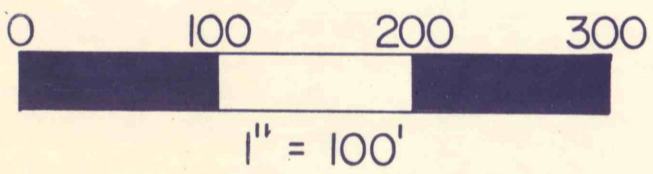

MAIN STREET

ROOSEVELT STREET

E. GROVE STREET

ZERBEY AVENUE