

EARL & GRIFFIN TO G.A.C.CO.  
DEED DATED JAN. 10, 1929

KELSEY  
CHURCH

WILSON

SWIFTY ZONE  
MAKING A DEPTH OF 100 FT. FROM THE RIVER

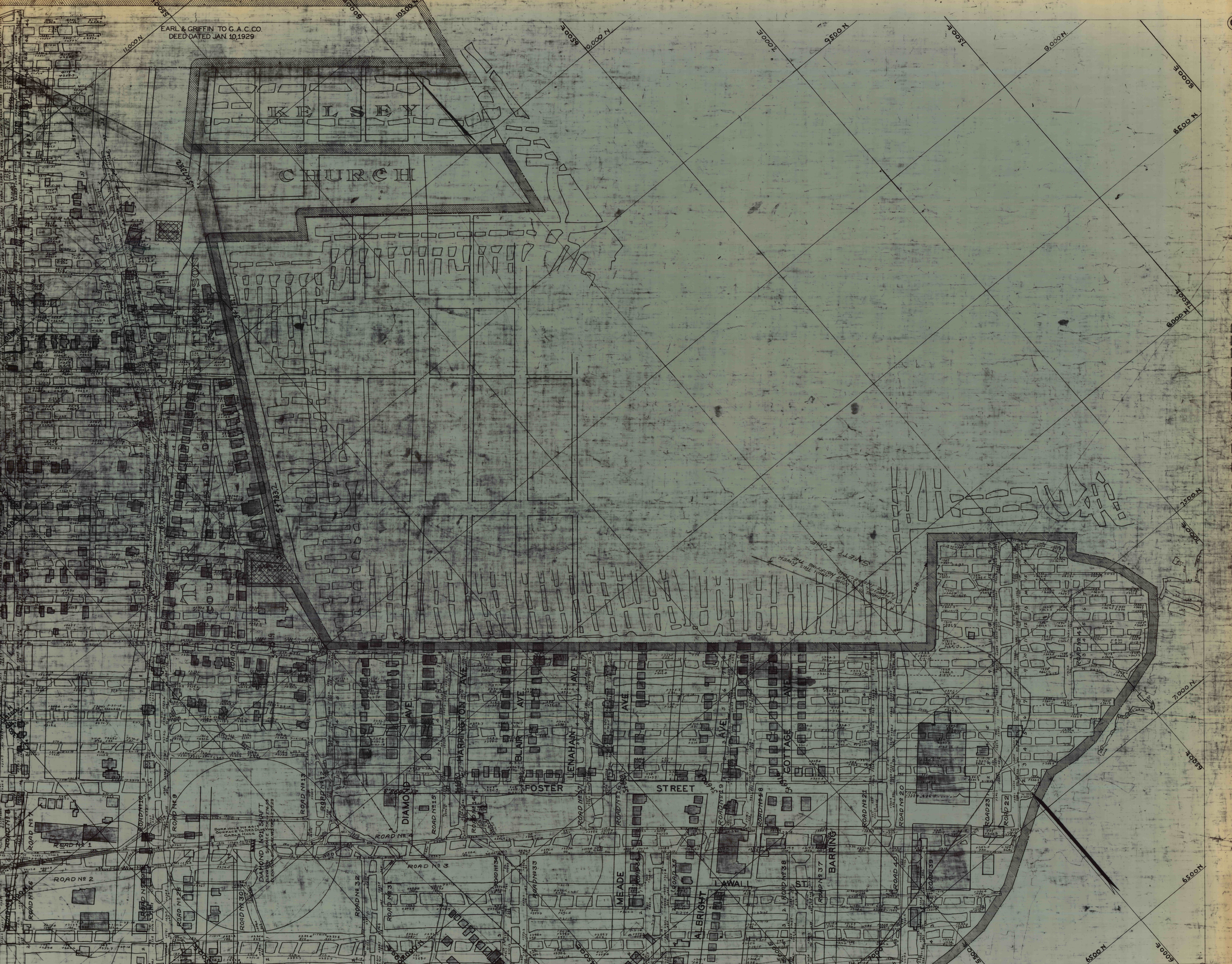

DIAMOND COLLY'Y. NO. 3 DUNMORE BED