

LEGEND

- TELEPHONE POLE +
- RAILROAD TRACK ++++++
- ELECTRIC LINE —E—
- WATER LINE —W—
- SANITARY SEWER —S—
- WALL ———
- FENCE —x—x—

- NOTES:**
1. P.G. & W. CO. - WATER LINE EASEMENTS = 40' WIDE 20' RIGHT & LEFT OF LINE
 2. NO GAS ON SITE
 3. CONTOUR OF LAND - RELATIVELY LEVEL
 4. RUNOFF ON SITE IS INSIGNIFICANT SINCE SITE IS RELATIVELY FLAT.

DEED REFERENCE:
 FIRST NATIONAL BANK OF EASTERN PA., TRUSTEE
 TO JAMES B. & ROBERT E. POST
 MAY 16 1974 DB 1223 Pg. 146.

PRELIMINARY PLAN ACCEPTED BY:	FINAL PLAN ACCEPTED BY:

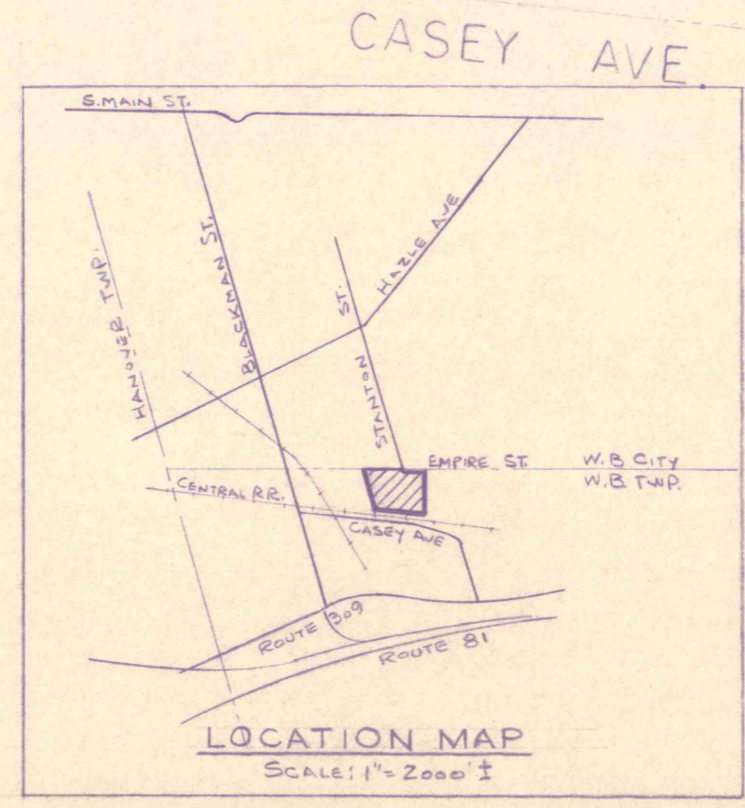

OWNERS:
 JAMES B. POST - 300 HIGHLAND BLD., DALLAS, PA.
 ROBERT E. POST - RD. #4, W. CENTER HILL RD., DALLAS, PA.

	REQUIRED RIGHT OF WAY		REQ. TEMPORARY EASEMENT FOR CONSTRUCTION	
	SQUARE FEET	ACRES	SQUARE FEET	ACRES
GREATER WILKES-BARRE INDUSTRIAL FUND AND J.B. POST CO. (FRANKLIN COLLIERY)	22,476.74	0.52 ±	18,494.83	0.43 ±
J.B. POST CO. (STANTON COLLIERY)	23,849.65	0.55 ±	14,419.02	0.34 ±
TIM SHAW (STANTON COLLIERY)	7,629.42	0.18 ±	4,558.00	0.11 ±
TOTALS	53,955.91	1.25 ±	37,471.85	0.88 ±

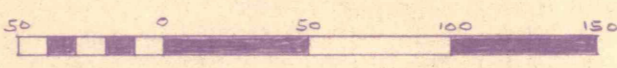

REV 2: ADDED MISC DETAILS - JUNE 19, 1979
 REV 1: ADDED 4 AC PARCEL - MAY 25, 1979.

J. B. POST CO.

J. B. POST SUB-DIVISION

STANTON AND FRANKLIN COLLIERIES
 SHOWING TAKING FOR STORM WATER
 DRAINAGE CHANNEL.
 WILKES-BARRE TOWNSHIP, LUZ. CO., PA.

SCALE 1" = 50' DATE DEC. 8, 1978

CALLAHAN ENGINEER ASSOCIATES, INC.
 7 MARION AVE., HANOVER, PENNA. NOS. 910 BE

Douglas A. ...

REGD. SURVEYOR
 PENNA. NOS. 910 BE