

**PLAN**  
Scale 1 in. = 100 ft.

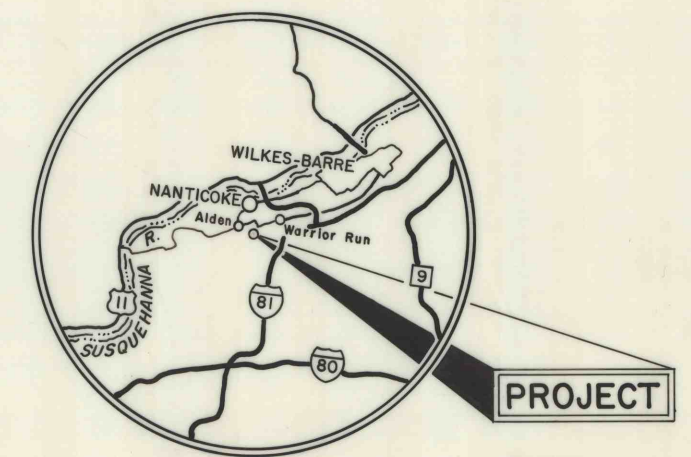

**LOCATION MAP**  
Scale 1 in. = 9 mi.

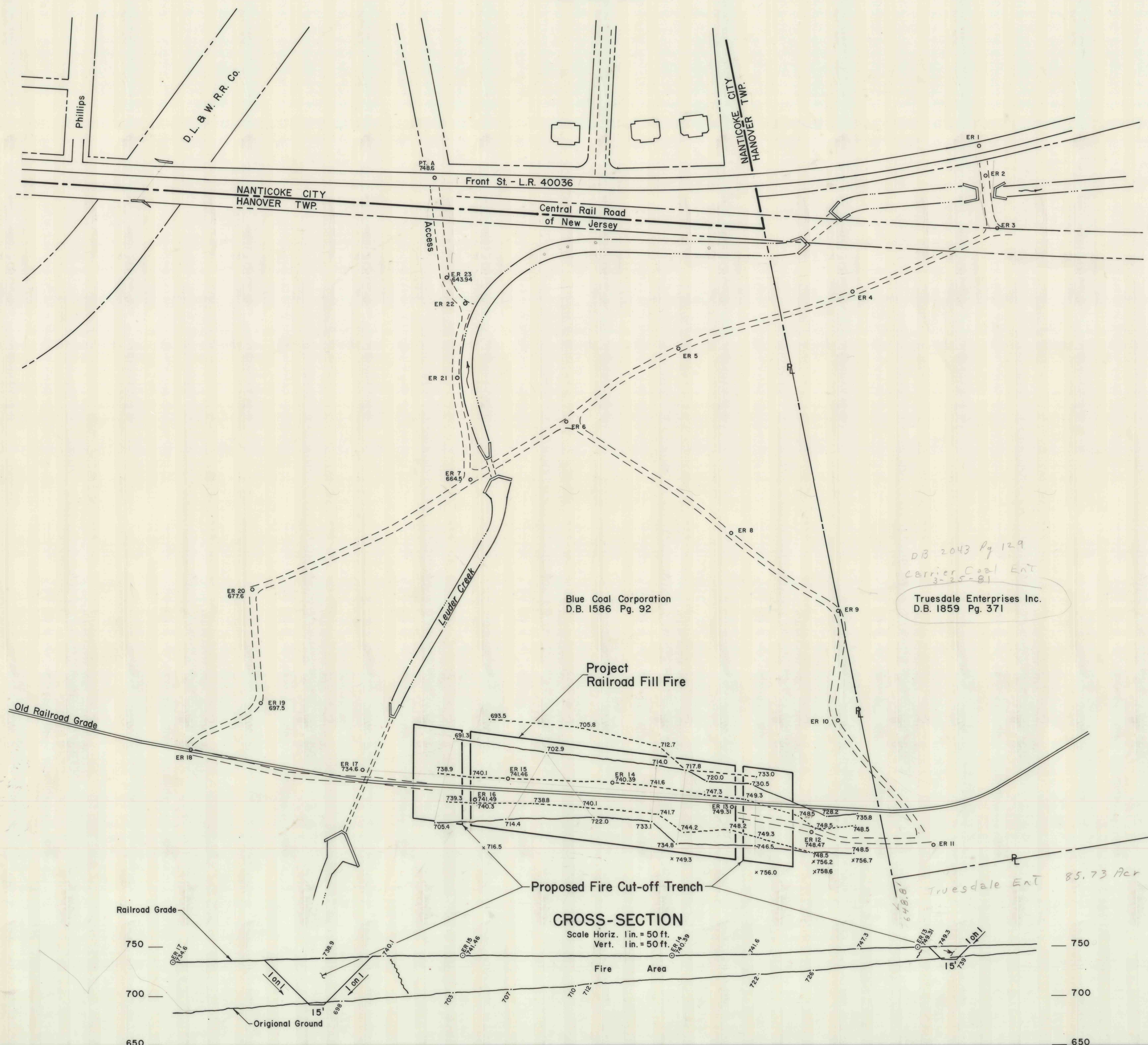
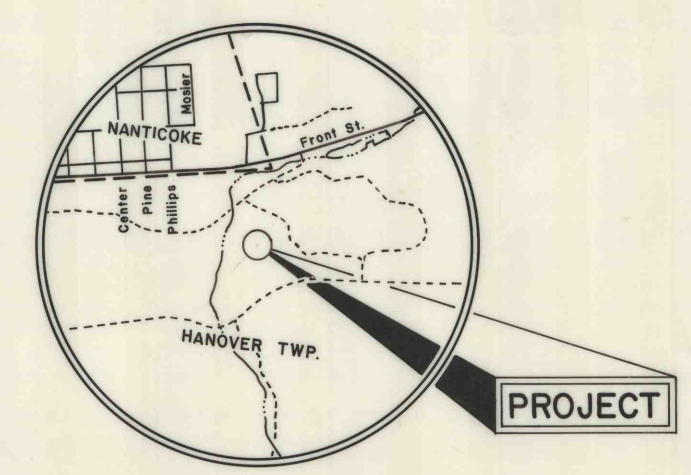

**VICINITY MAP**  
Scale 1 in. = 2,000 ft.

NO.	DATE	REVISION	APPR.
SUBMITTED			
DESIGNER: <i>Robert J. Stepanek P.E.</i>			
APPROVED			
DISTRICT OPERATIONS SUPERVISOR, WILKES-BARRE: <i>William P. Zambich P.E.</i>			
APPROVED			
DIRECTOR, BUREAU OF RESOURCES PROGRAMMING			
COMMONWEALTH OF PENNSYLVANIA DEPARTMENT OF ENVIRONMENTAL RESOURCES OFFICE OF RESOURCES MANAGEMENT			
PROJECT NO. A.D. 81-1			
ABANDONED RAILROAD FILL FIRE BLUE COAL PROPERTY			
HANOVER TOWNSHIP, LUZERNE COUNTY			
<b>PLAN, LOCATION AND VICINITY MAPS</b>			
DRAWN BY R. J. S.	DATE June 26, 1981	DRAWING NO. 1 of 1	
CHECKED BY	SCALE As Shown		