

1300
375
43,560 / 450,000 (10 AC.)

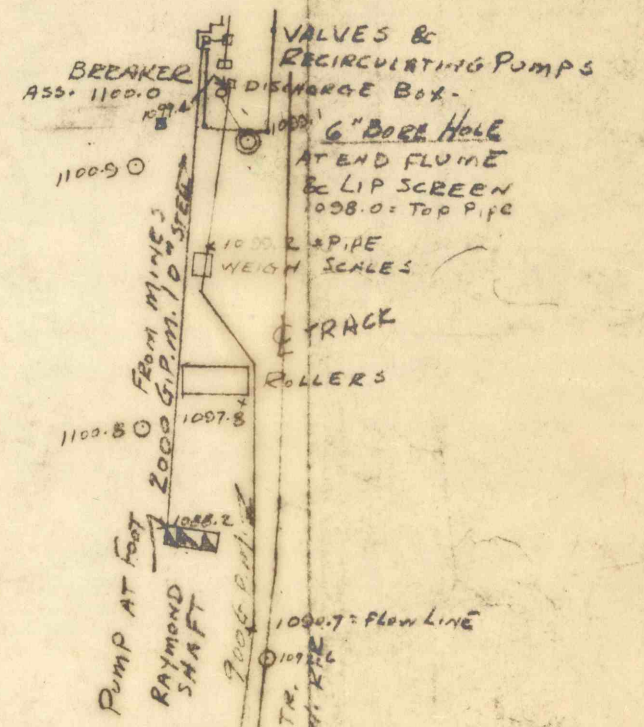

PLAN ACCOMPANYING REQUEST FOR PERMIT TO
OPERATE AN ANTHRACITE BREAKER WITH THE
NECESSARY SILT DISPOSAL PLANT SHOWING THE
PRESENT & PLANNED FACILITIES OF THE
NORTHWEST MINING CO., INC. - RAYMOND
BREAKER - (EYNON) - ARCHBALD BOROUGH -
LACKAWANNA COUNTY - PENNA.
SCALE 1" = 100' MARCH 9, 1963
Paul A. Linn, P.E.
Reg. No. # 7565 E
Engr. No. # 6258-6

Part 3-10 AC.
1311.4
319.7
43,560 / 457,539 (10 1/4 AC.)

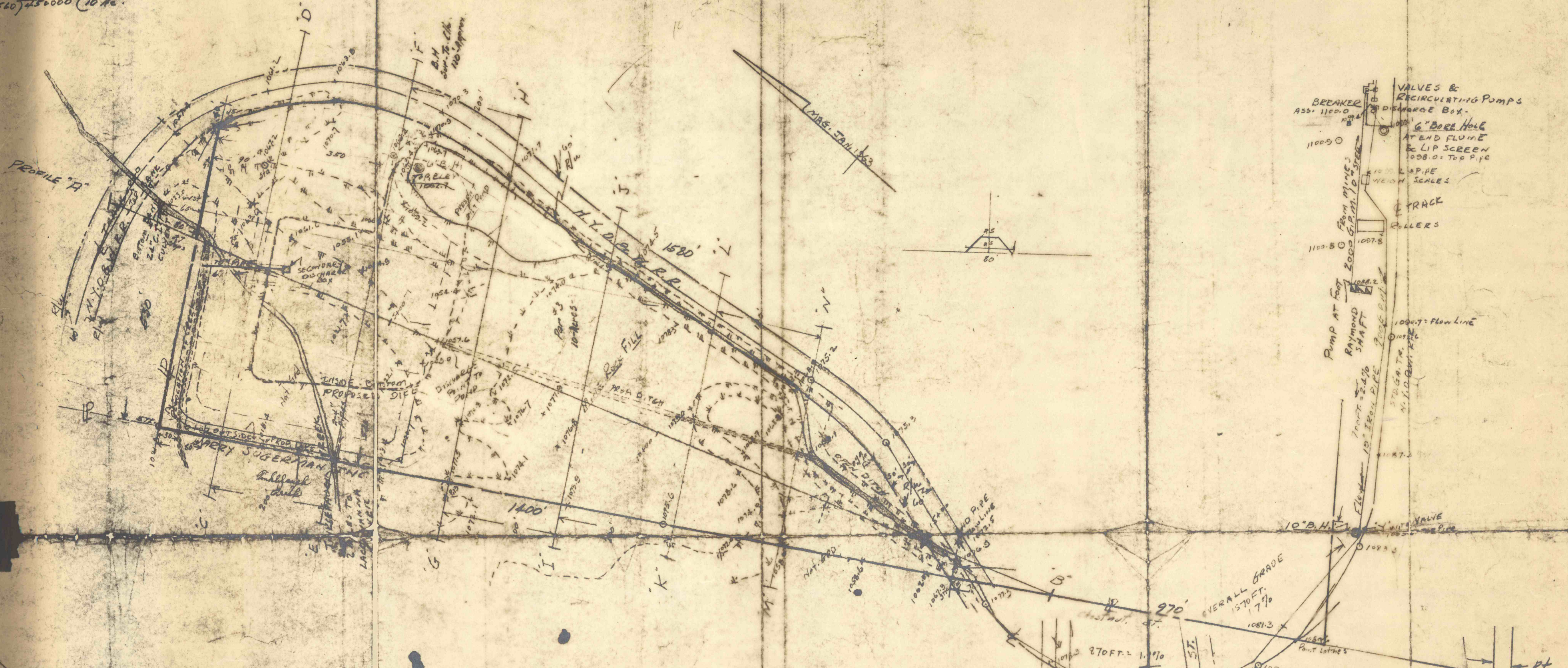