

1200  
375  
15,625 (10 Ac.)  
Approx.  
22,200 Cu. Yds.

Approx.  
2000 Cu. Yds.

EYNON BORO

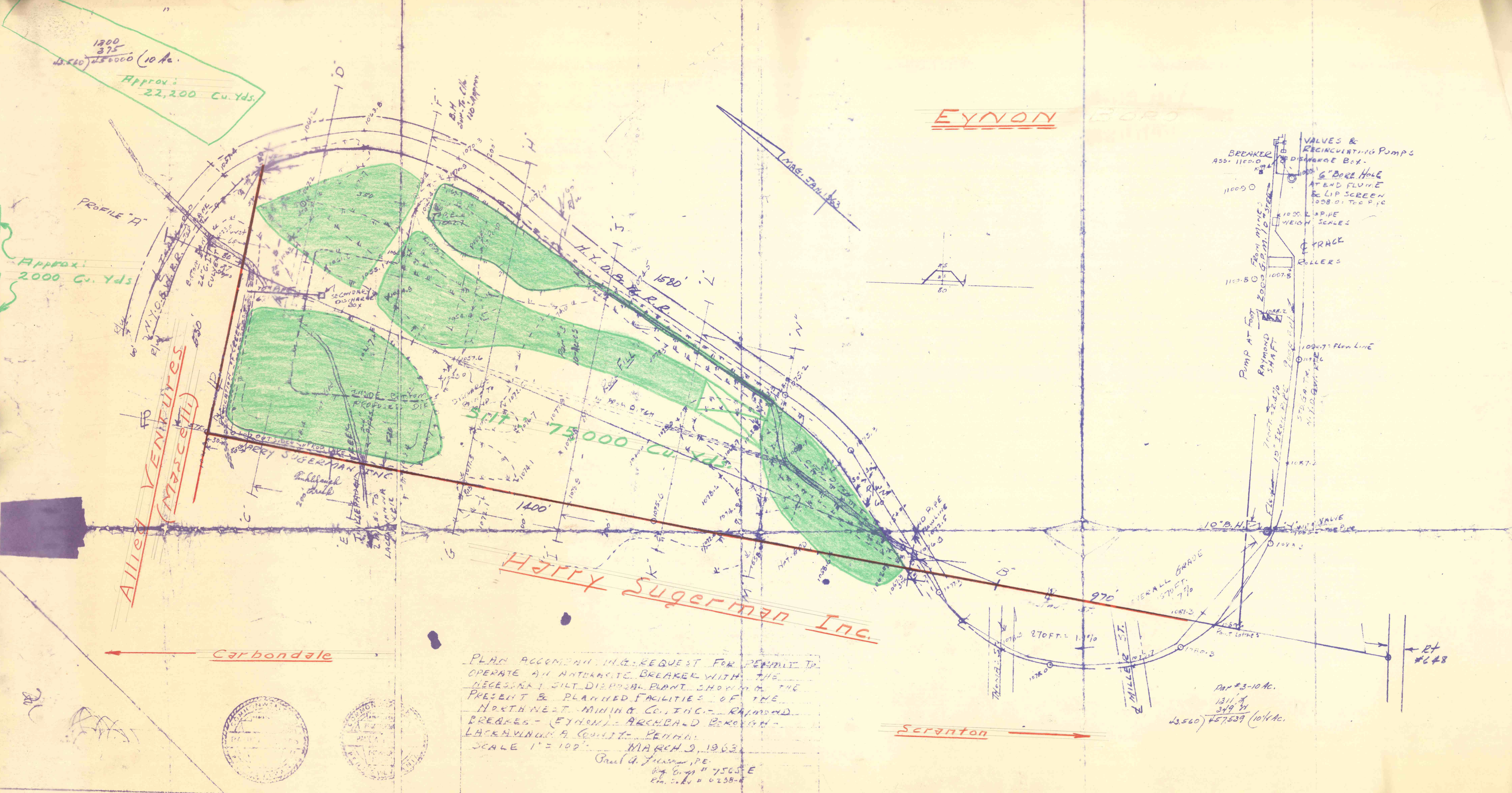
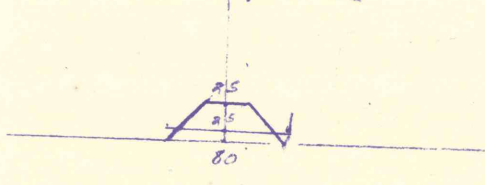
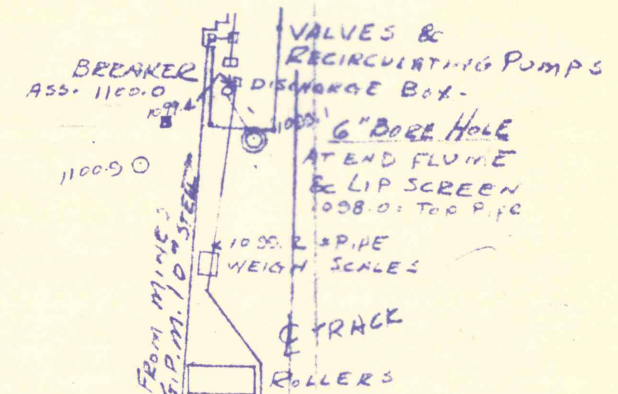

PLAN ACCOMPANYING REQUEST FOR PERMIT TO  
OPERATE AN ANTI-SILT BREAKER WITH THE  
NECESSARY SILT DISPOSAL PLANT SHOWING THE  
PRESENT & PLANNED FACILITIES OF THE  
NORTHWEST MINING CO. INC. - RAYMOND  
BREAKER - (EYNON) - ARCHBOLD BOROUGH -  
LACKAWANNA CO. PA. PENN.  
SCALE 1" = 100' MARCH 9, 1963  
Paul G. Johnson, P.E.  
Reg. No. 7565 E  
Ph. No. 6258-6

Part 3-10 Ac.  
1311 ft.  
349 ft.  
15,560 / 45,539 (10/4 AC.)

