

MARIA HULL

WM.

MILES

APR 2, 1945
AGREED

PILLAR

BARBER

RESERVE FOR PROTECTION OF PUMP CORE HOLES NO EXCAVATING WITHOUT SPECIAL PERMISSION OF M.N. ENGR.

RESERVATION

WM. HULL

See MD 123-509 & 52/646 Pa. 12/1/45

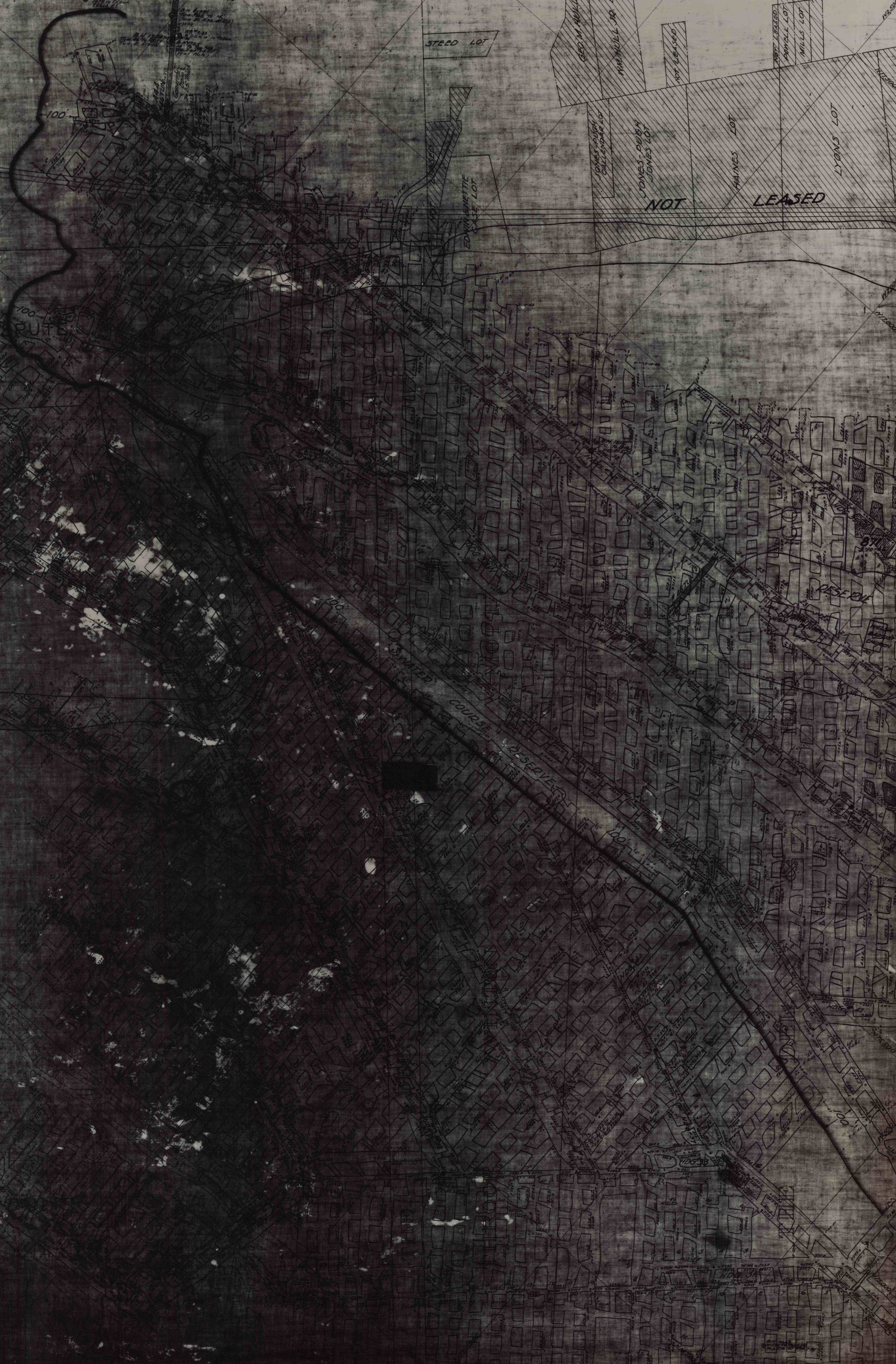

STEAD LOT

EDWINETTE LOT

NOT LEASED

NOT LEASED

LYONS LOT

HULL MILES DISPUTE

COUPLED RESERVOIR

RESERVOIR

