

LOCATION PLAN
SCALE: 1" = 2000

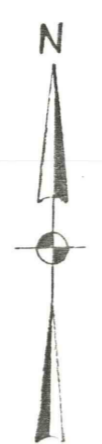
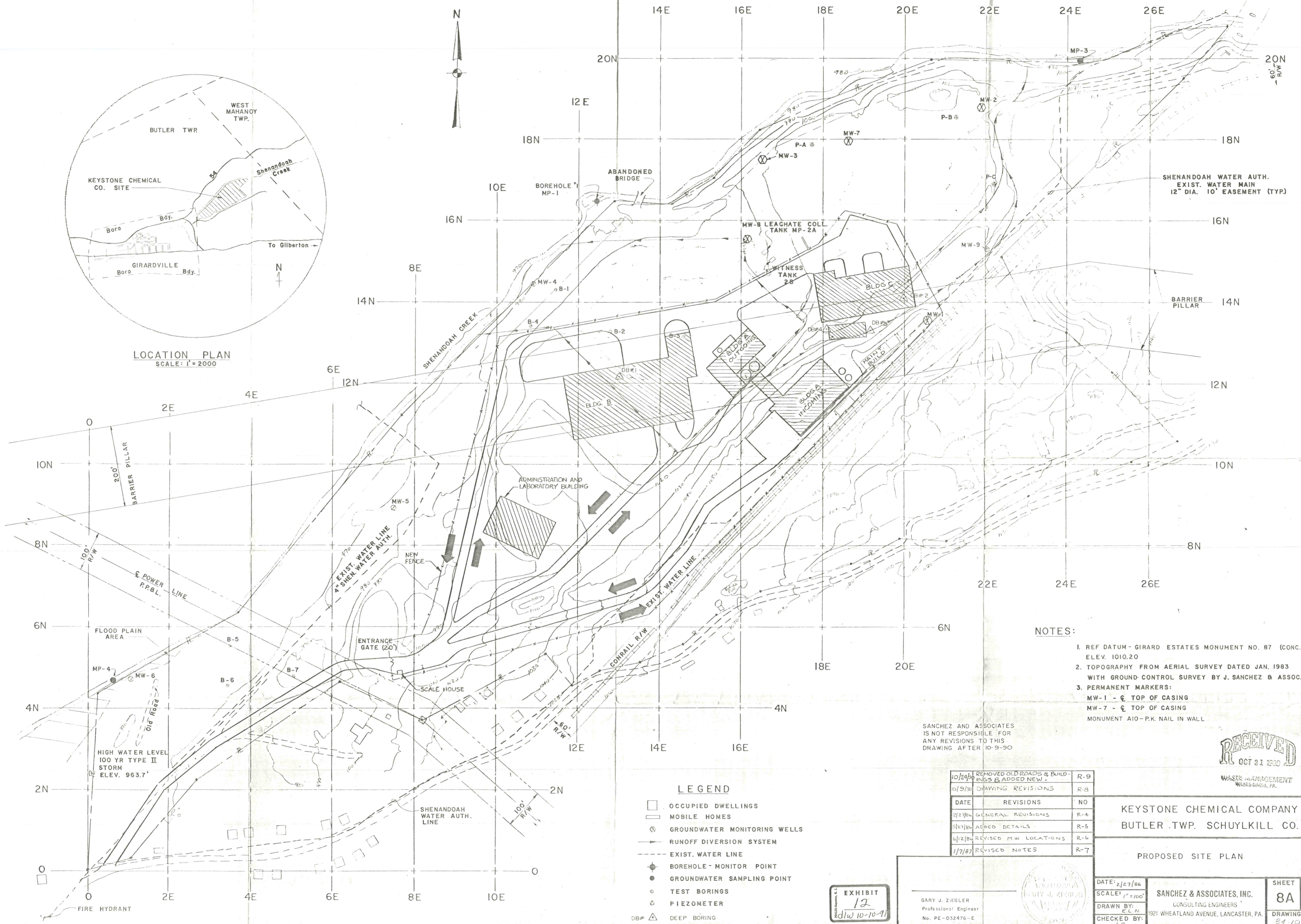

- NOTES:**
- REF DATUM - GIRARD ESTATES MONUMENT NO. 87 (CONC.) ELEV. 1010.20
 - TOPOGRAPHY FROM AERIAL SURVEY DATED JAN. 1983 WITH GROUND CONTROL SURVEY BY J. SANCHEZ & ASSOC.
 - PERMANENT MARKERS:
MW-1 - \odot TOP OF CASING
MW-7 - \odot TOP OF CASING
MONUMENT A10 - P.K. NAIL IN WALL

SANCHEZ AND ASSOCIATES IS NOT RESPONSIBLE FOR ANY REVISIONS TO THIS DRAWING AFTER 10-9-90

- LEGEND**
- \square OCCUPIED DWELLINGS
 - \square MOBILE HOMES
 - \odot GROUNDWATER MONITORING WELLS
 - \rightarrow RUNOFF DIVERSION SYSTEM
 - - - EXIST. WATER LINE
 - \bullet BOREHOLE - MONITOR POINT
 - \bullet GROUNDWATER SAMPLING POINT
 - \odot TEST BORINGS
 - \odot PIEZOMETER
 - DB# \triangle DEEP BORING

DATE	REVISIONS	NO
10/24/84	REMOVED OLD ROADS & BUILDINGS & ADDED NEW	R-9
10/9/84	DRAWING REVISIONS	R-8
2/27/84	GENERAL REVISIONS	R-4
5/27/84	ADDED DETAILS	R-5
6/12/84	REVISED M.W. LOCATIONS	R-6
1/7/87	REVISED NOTES	R-7

KEYSTONE CHEMICAL COMPANY
BUTLER TWP. SCHUYLKILL CO.

PROPOSED SITE PLAN

EXHIBIT
12
dlw 10-10-91

GARY J. ZIEGLER
Professional Engineer
No. PE-032476-E

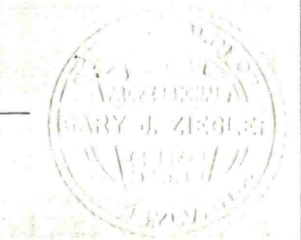

DATE: 2/27/86
SCALE: 1" = 100'
DRAWN BY: E.L.N.
CHECKED BY: J.S.

SANCHEZ & ASSOCIATES, INC.
CONSULTING ENGINEERS
1921 WHEATLAND AVENUE, LANCASTER, PA.

SHEET OF
8A
DRAWING NO.
24-1011

