

- LEGEND**
- OCCUPIED DWELLINGS
 - MOBILE HOMES
 - STORM DRAIN
 - CB CATCH BASIN
 - EXISTING WATER LINE
 - EXISTING DIVERSION TERRACE
 - PROPERTY LINE
 - EXISTING CONTOURS
 - PROPOSED CONTOURS
 - SPOT ELEVATIONS
 - NEW FENCE
 - TRAFFIC FLOW
 - GEOPHYSICAL BORINGS

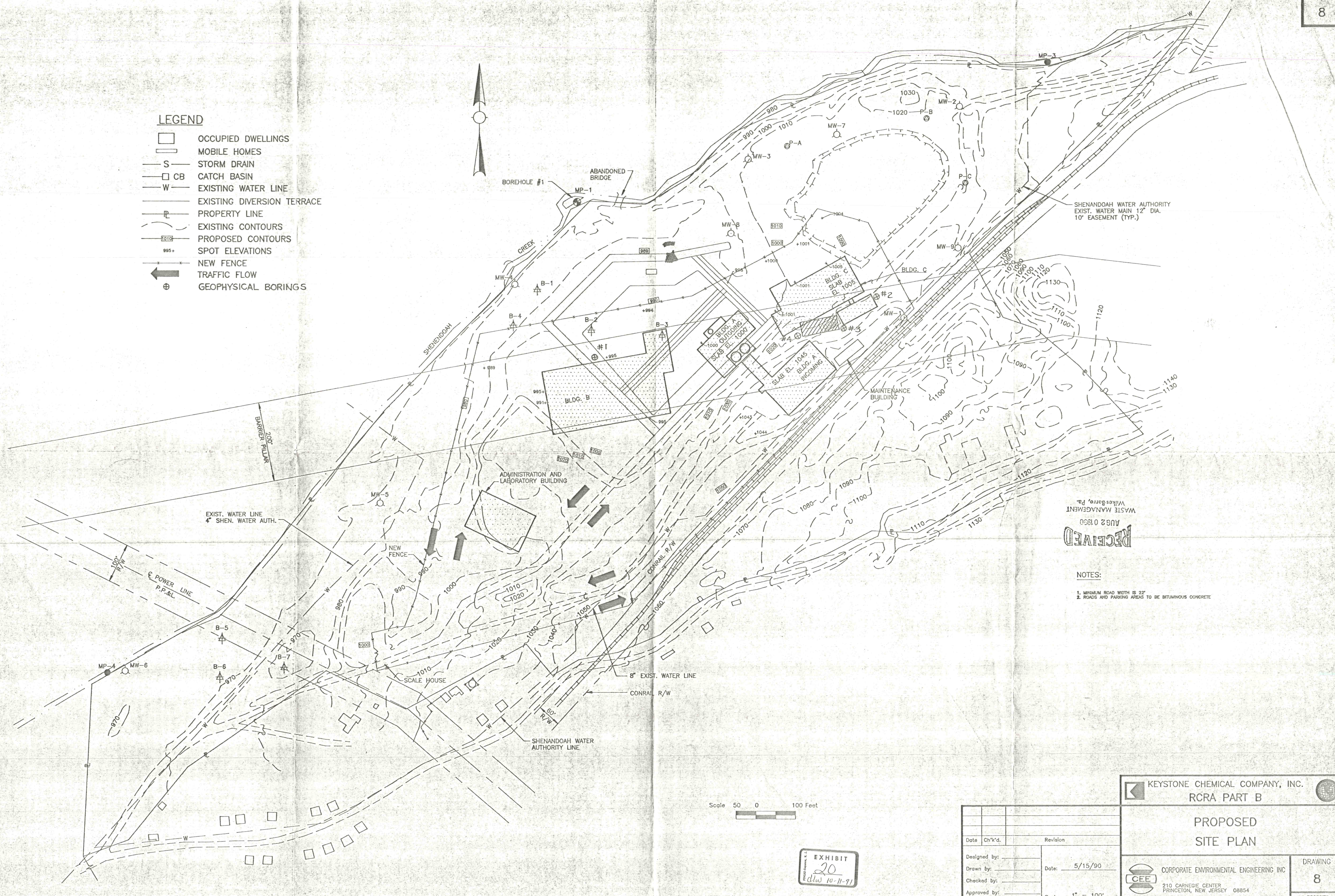

RECEIVED
 AUG 20 1990
 WASTE MANAGEMENT
 Wilkes-Barre, Pa.

- NOTES:**
1. MINIMUM ROAD WIDTH IS 22'
 2. ROADS AND PARKING AREAS TO BE BITUMINOUS CONCRETE

Scale 50 0 100 Feet

EXHIBIT
 20
 d/w 10-11-91

Date	Ch'k'd.	Revision

KEYSTONE CHEMICAL COMPANY, INC.
 RCRA PART B

PROPOSED SITE PLAN

CORPORATE ENVIRONMENTAL ENGINEERING INC.
 210 CARNEGIE CENTER
 PRINCETON, NEW JERSEY 08854

DESIGNED BY: _____
 DRAWN BY: _____ DATE: 5/15/90
 CHECKED BY: _____
 APPROVED BY: _____ SCALE: 1" = 100'

DRAWING
 8
 PROPSITE