

Elevation Top of Water

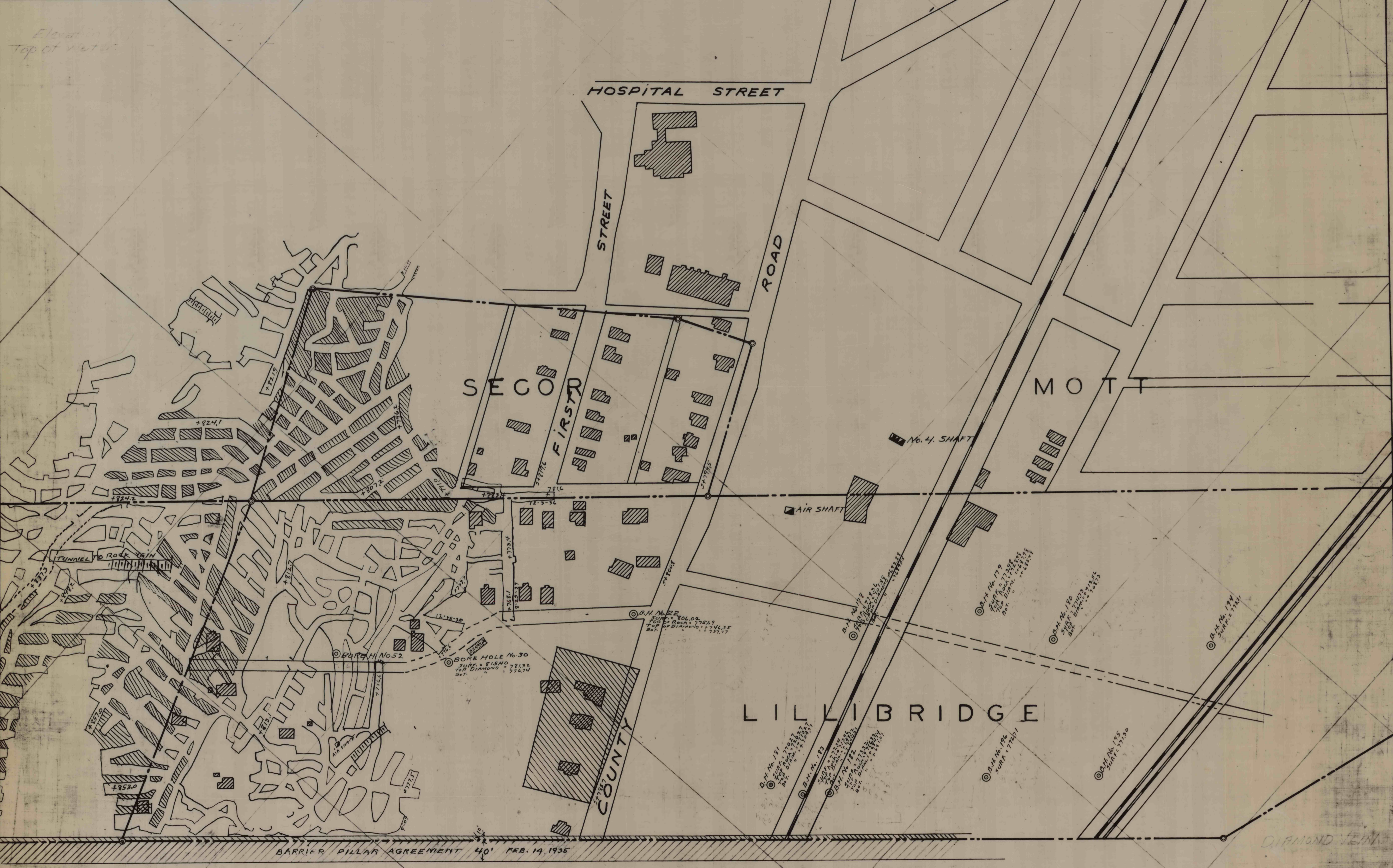

HOSPITAL STREET

STREET

ROAD

SECO
FIRST

MOTT

No. 4. SHAFT

AIR SHAFT

TUNNEL TO ROCK VEIN

BORE HOLE No. 52

BORE HOLE No. 30
SURF = 815.40
TOP OF DIAMOND = 791.32
Bot. " " = 776.74

B.H. No. 22
SURF = 806.02
TOP OF ROCK = 775.69
TOP OF DIAMOND = 746.35
Bot. " " = 737.77

LILLIBRIDGE

COUNTY

BARRIER PILLAR AGREEMENT 40' FEB. 14 1935

DIAMOND VEIN