

MATCH LINE - FOR CONTINUATION SEE DRAWING NO. 2

STATE GAME LAND NO. 264

MATCH LINE - FOR CONTINUATION SEE DRAWING NO. 4

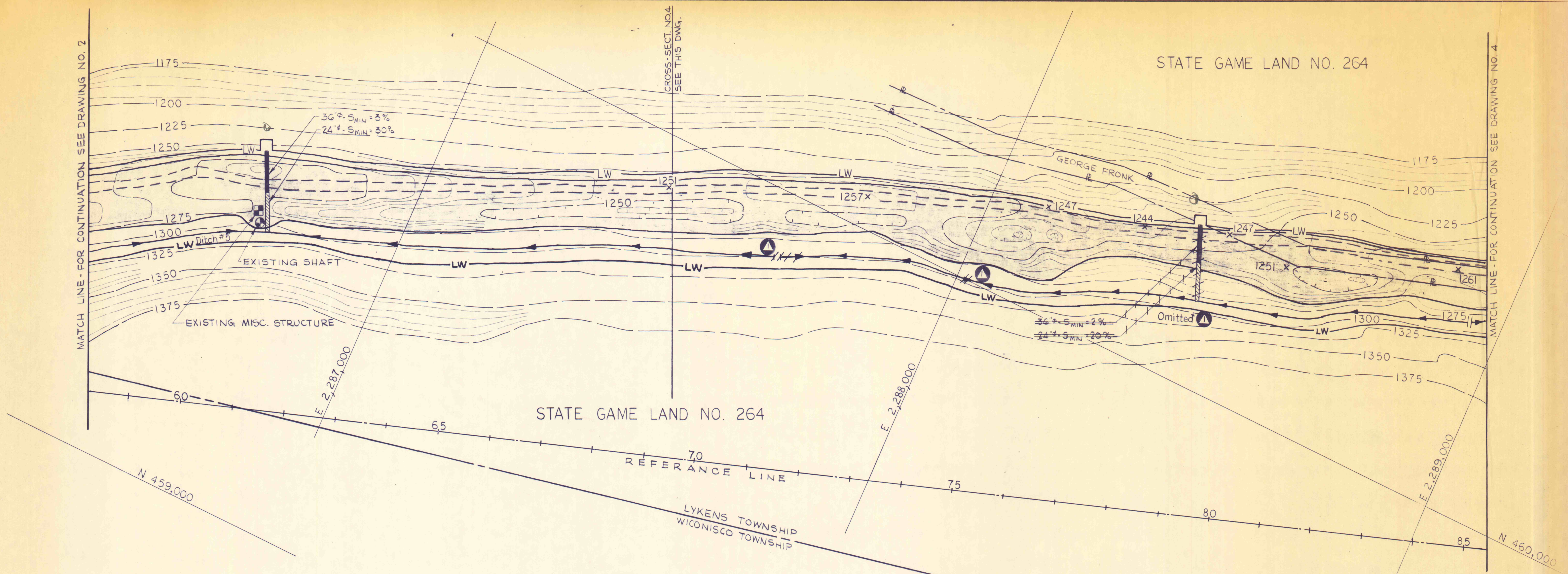

PLAN  
SCALE: 1" = 100'

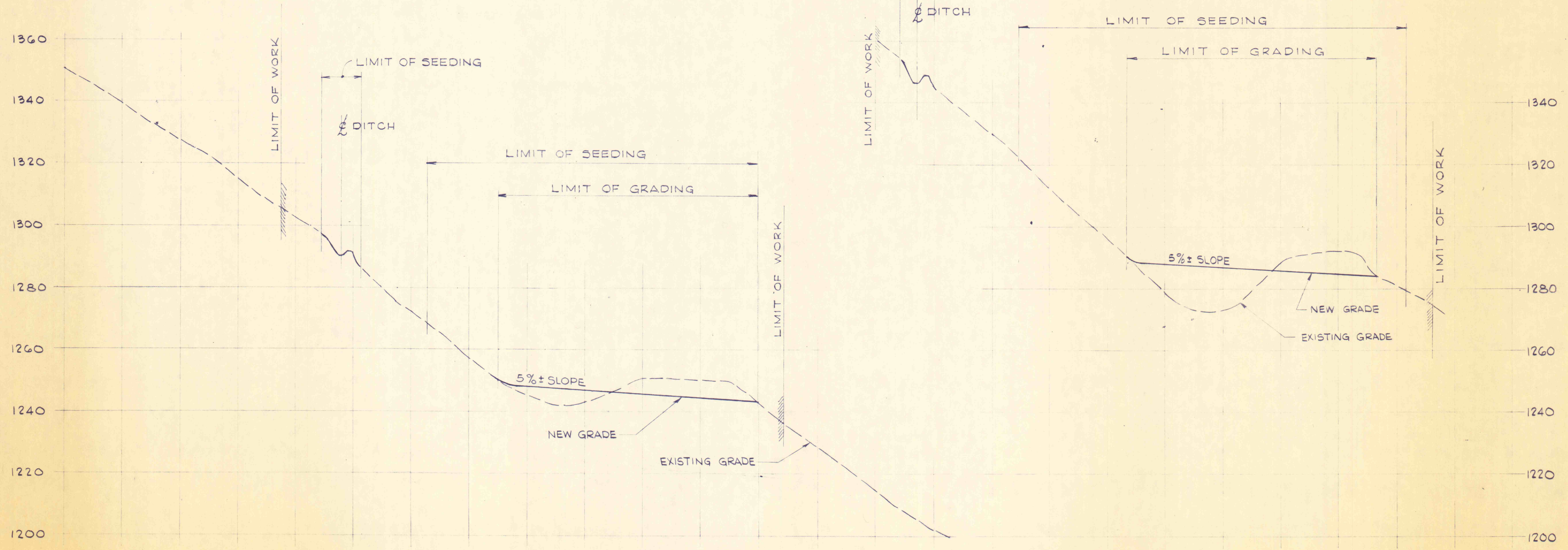

CROSS-SECTION NO. 4  
SCALE: 1" = 20' (HORIZ. & VERT.)  
FOR LOCATION, SEE THIS DRAWING

CROSS-SECTION NO. 1  
SCALE: 1" = 20' (HORIZ. & VERT.)  
FOR LOCATION SEE DWG. NO. 1

FOR LEGEND & NOTES SEE DRAWING NO. 2

NO.	DATE	REVISION	APPR.
2475		As built	
SUBMITTED <i>Thomas Richard</i> PROFESSIONAL			
APPROVED <i>Robert G. R...</i> CHIEF - DIVISION OF MINE DRAINAGE REHABILITATION			
APPROVED <i>...</i> DIRECTOR - BUREAU OF CONSULTING SERVICES			
COMMONWEALTH OF PENNSYLVANIA DEPARTMENT OF ENVIRONMENTAL RESOURCES OFFICE OF ENGINEERING AND CONSTRUCTION			
PROJECT NO. SL 170 STRIP MINE RECLAMATION QUICK START PROJECT "B" STATE GAME LAND NO. 264 WICONISCO CREEK WATERSHED DAUPHIN COUNTY, PENNA			
<b>SANDERS AND THOMAS, INC.</b> CONSULTING ENGINEERS <small>EXECUTIVE OFFICES: POTTSTOWN, PENNSYLVANIA          BRANCH OFFICES: PHILADELPHIA, PA. - LONG ISLAND, N.Y. - MIAMI, FLA.          PITTSBURGH, PA. - BALTIMORE, MD. - LONG BEACH, CALIF. - WASHINGTON, D.C.</small>			
<b>PLAN &amp; CROSS-SECTIONS          NOS. 1 &amp; 4</b>			
DRAWN BY TZ	DATE MAY 4, 1973	DRAWING NO. 3 of 7	
CHECKED BY TB	SCALE AS NOTED		