

STA. 9+95 =  
STA. 9+95

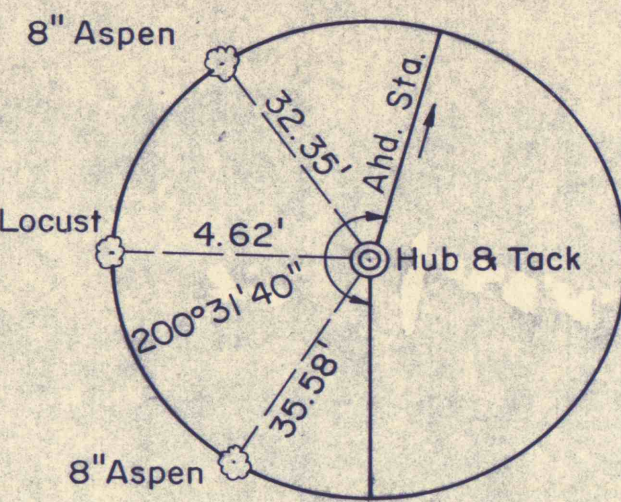

STA. 12+13

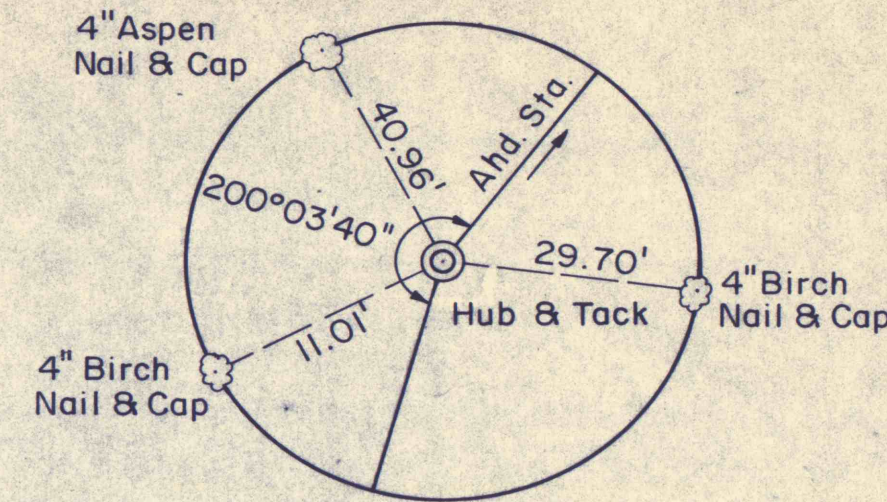

STA. 13+20

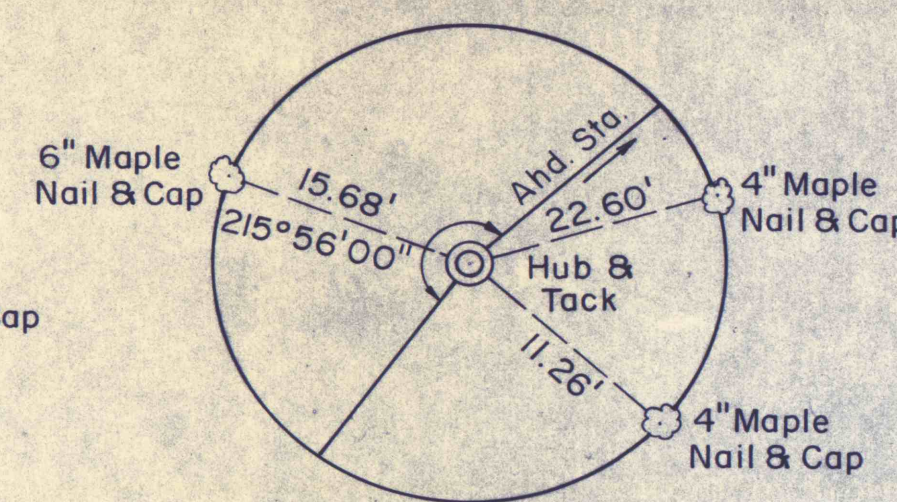

STA. 14+65 =  
STA. 14+80

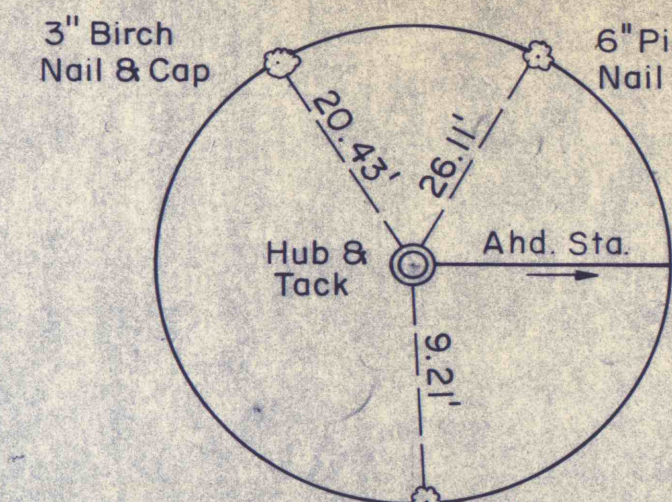

STA. 57+80 =  
STA. 58+00

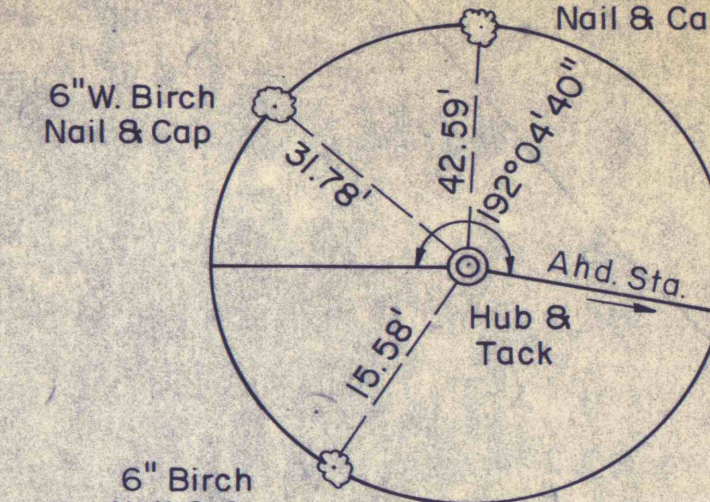

STA. 61+60

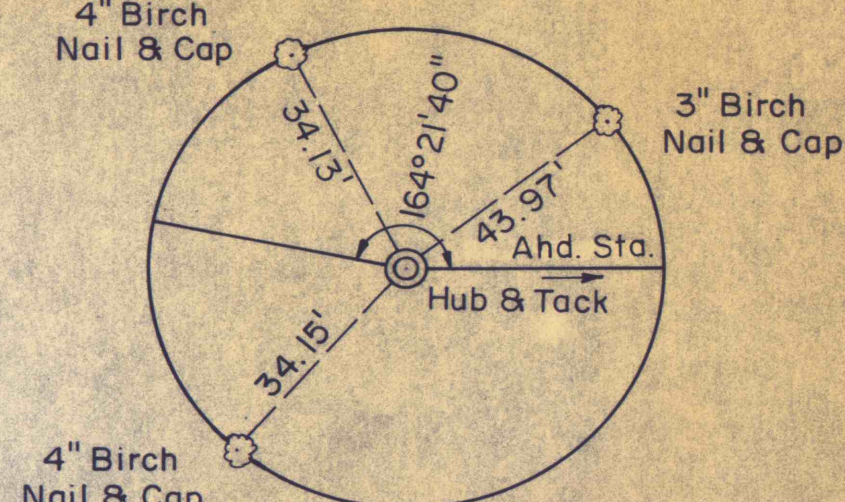

STA. 63+18

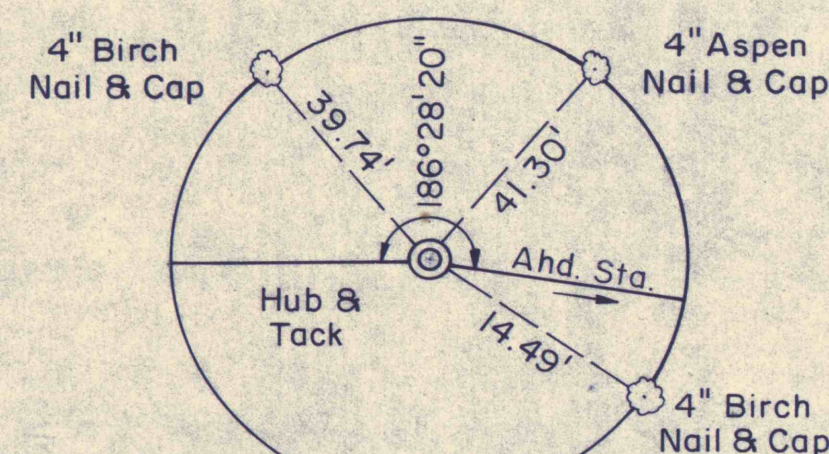

STA. 66+63

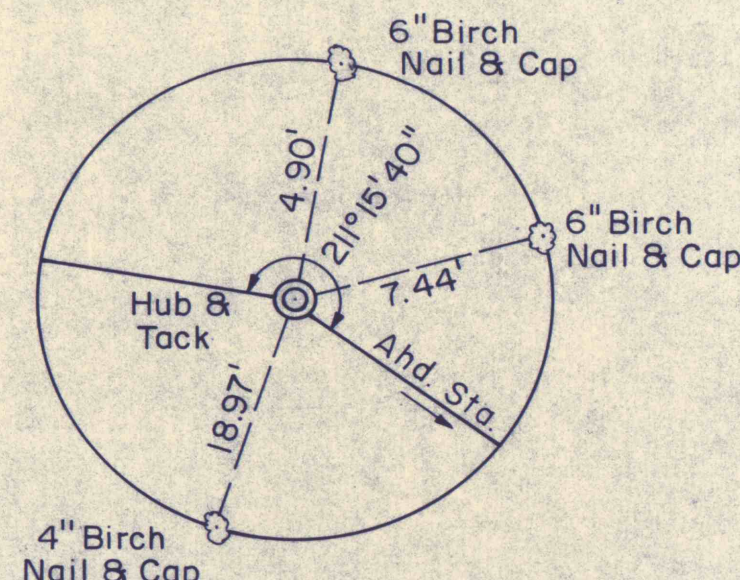

STA. 71+80

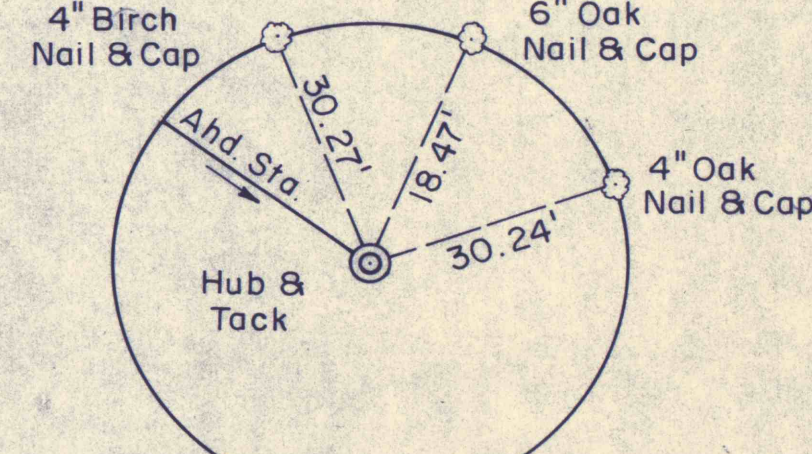

STA. 72+69

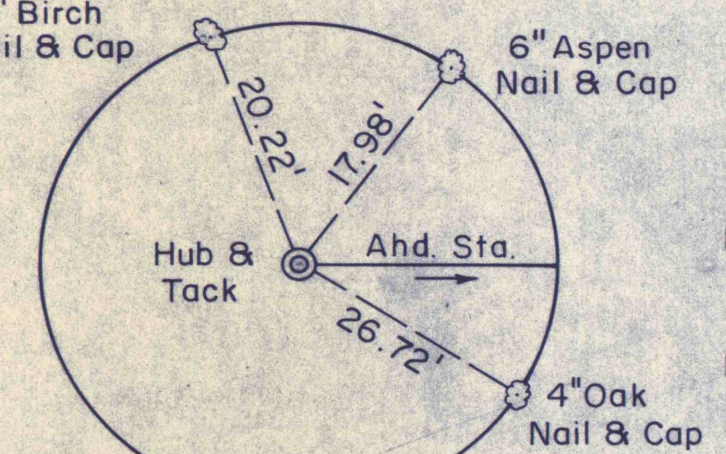

STA. 132+55 =  
STA. 132+62

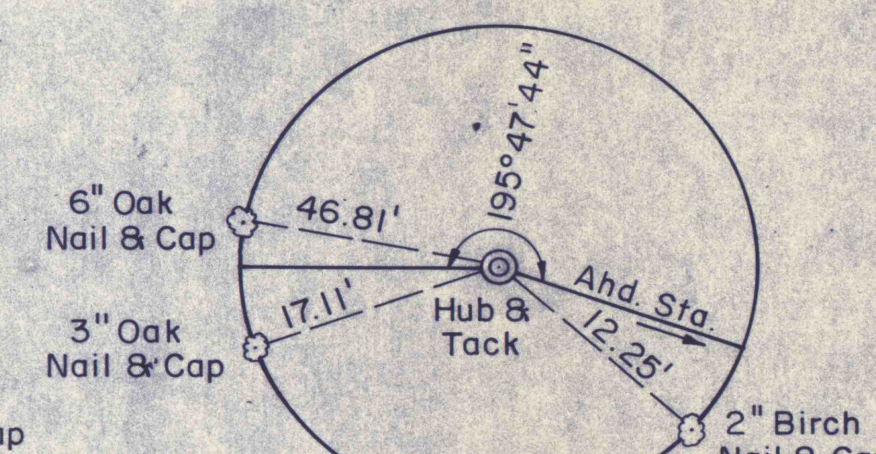

STA. 137+00 =  
STA. C-0+00

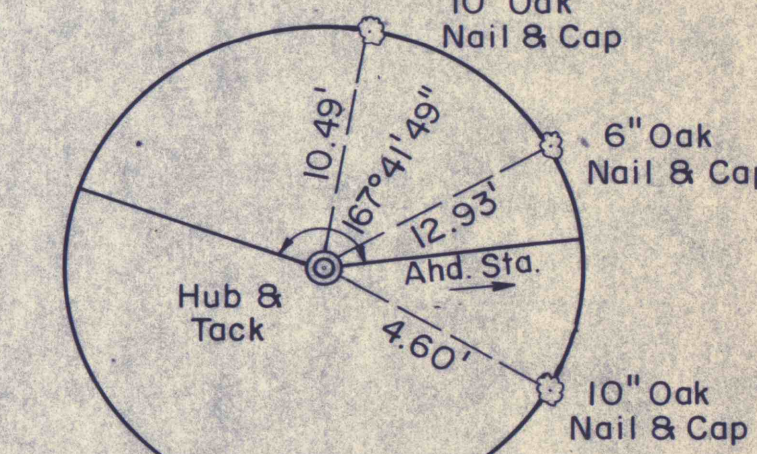

STA. 142+48

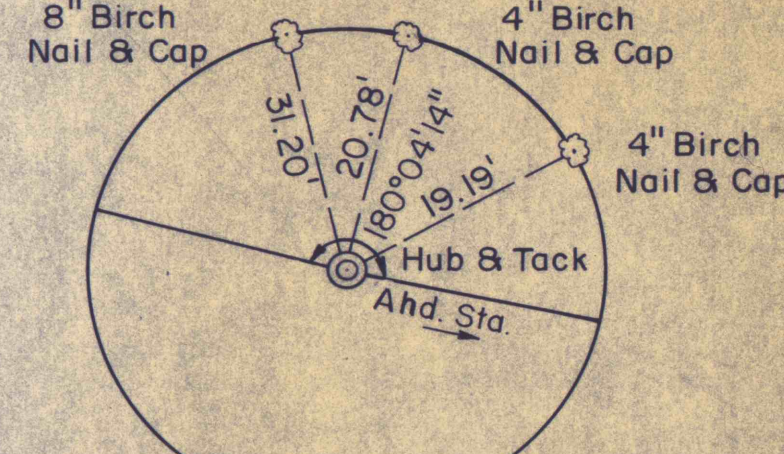

STA. 147+48

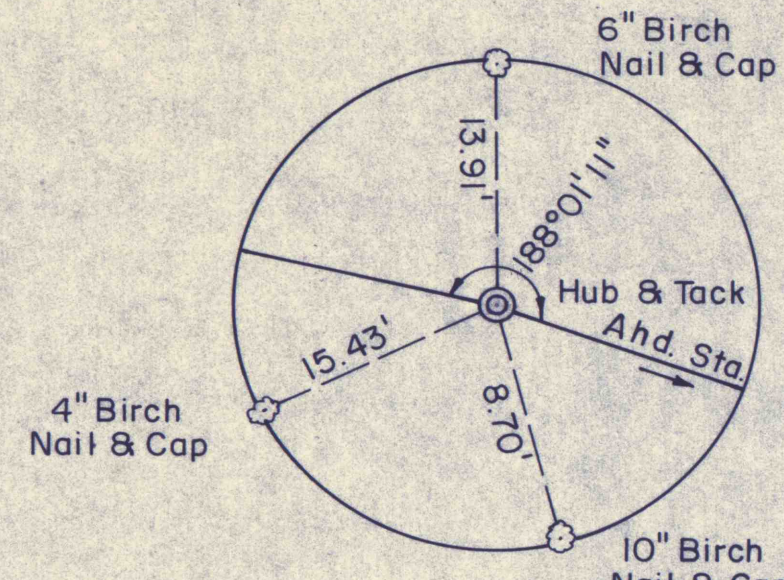

STA. 149+82

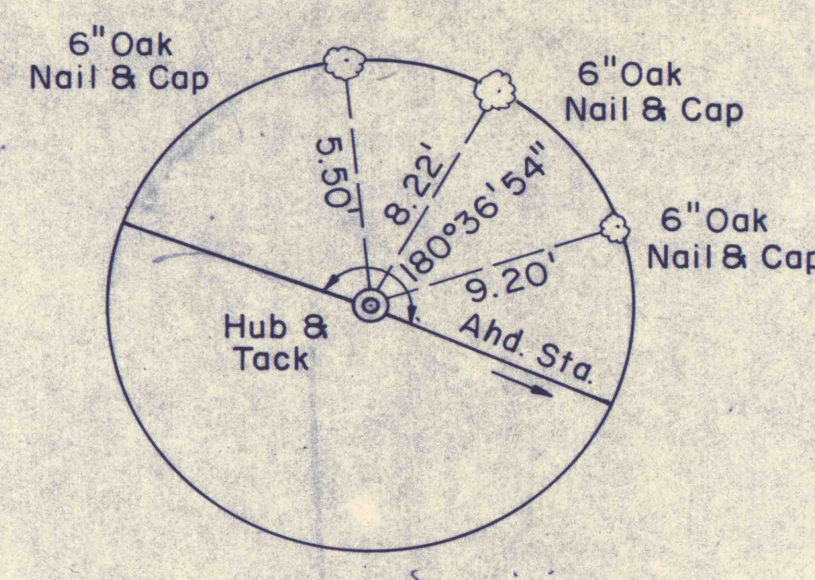

STA. 158+22

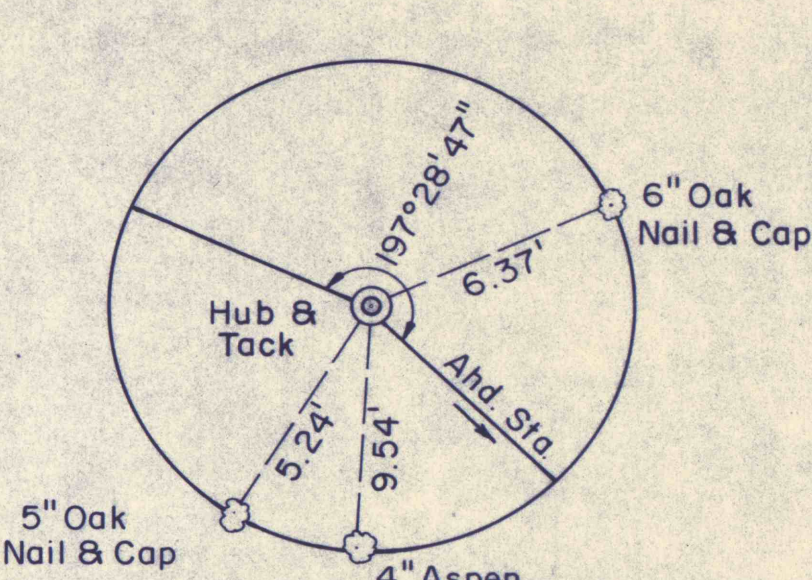

STA. 164+50

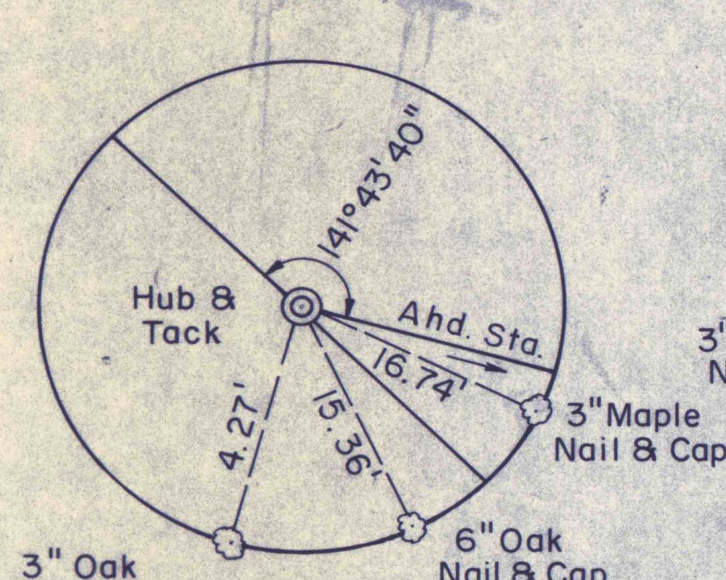

STA. 167+32 =  
STA. E-0+00

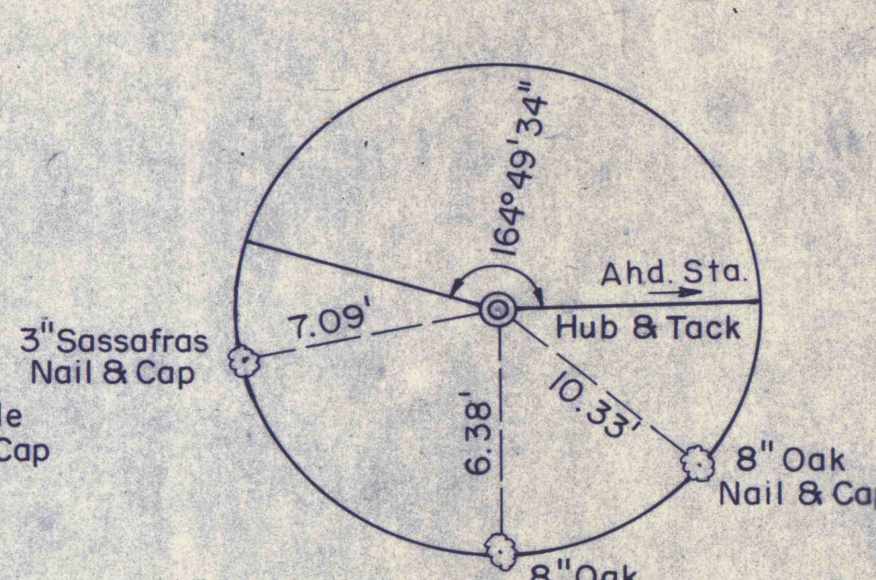

STA. 170+84

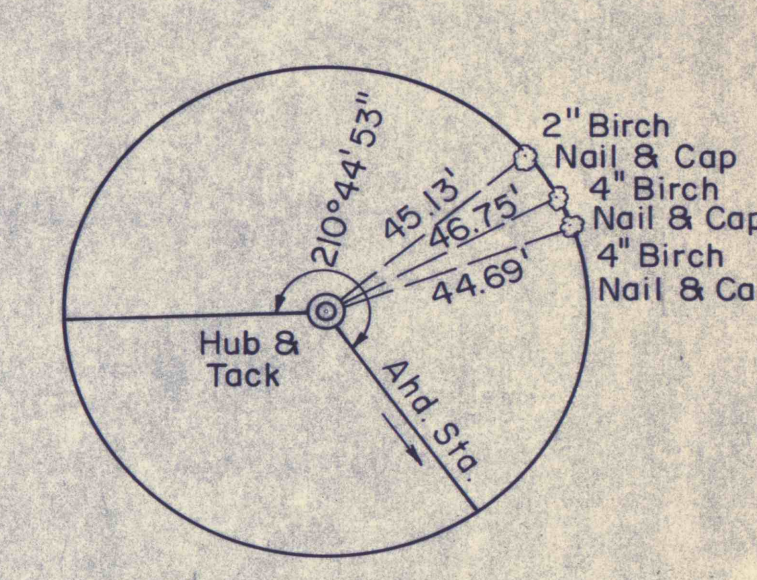

STA. 175+36

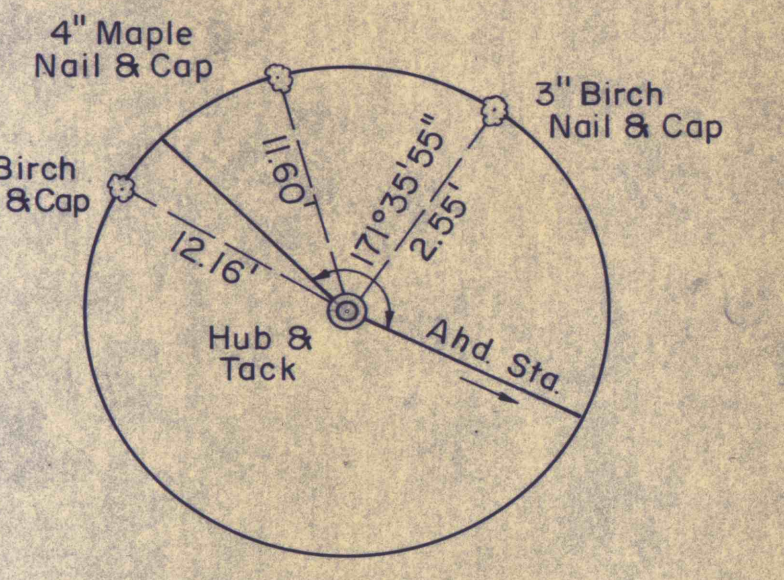

STA. E-3+18

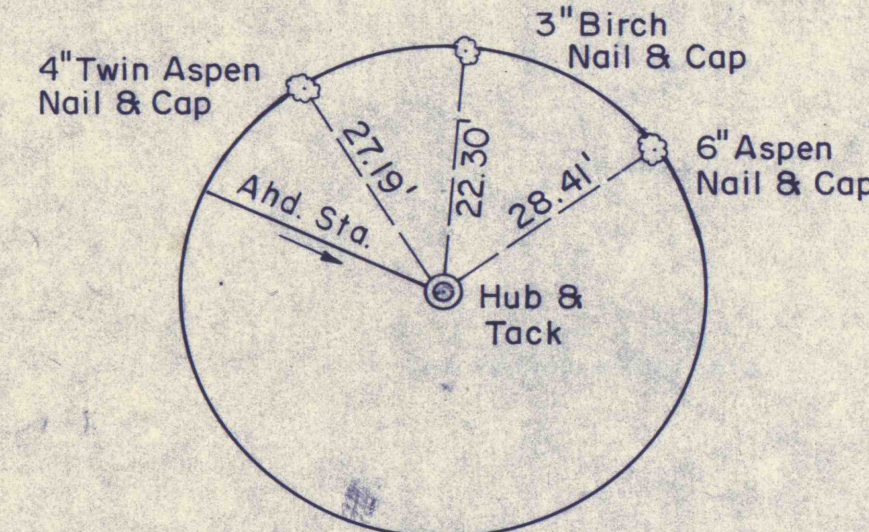

STA. E-7+00

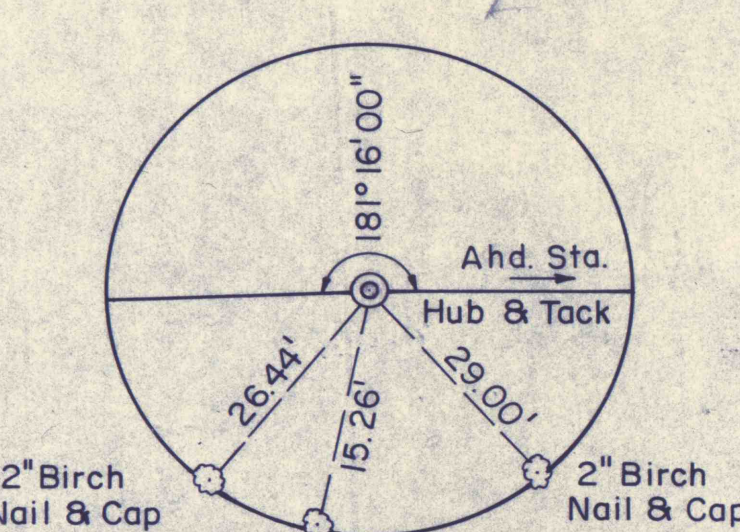

STA. 182+61

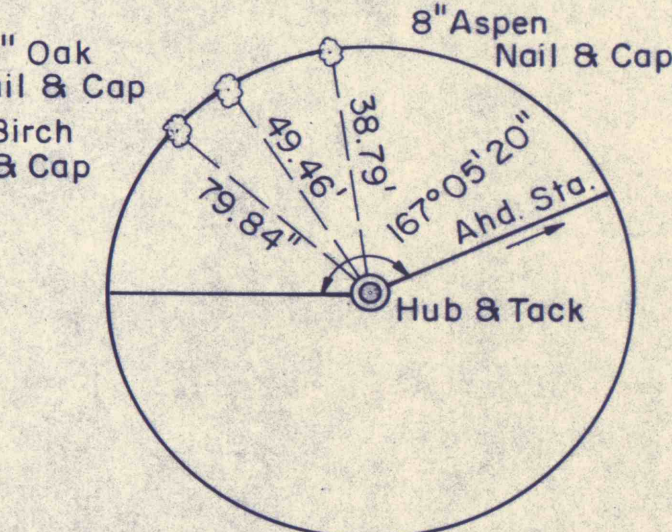

STA. 190+68

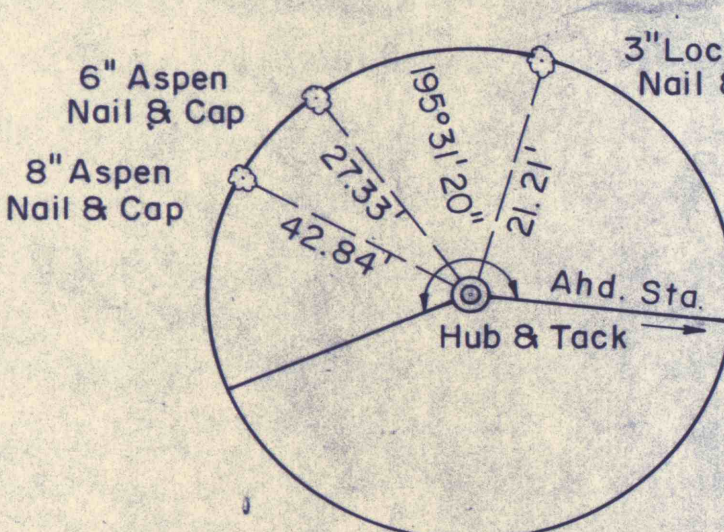

STA. 198+17

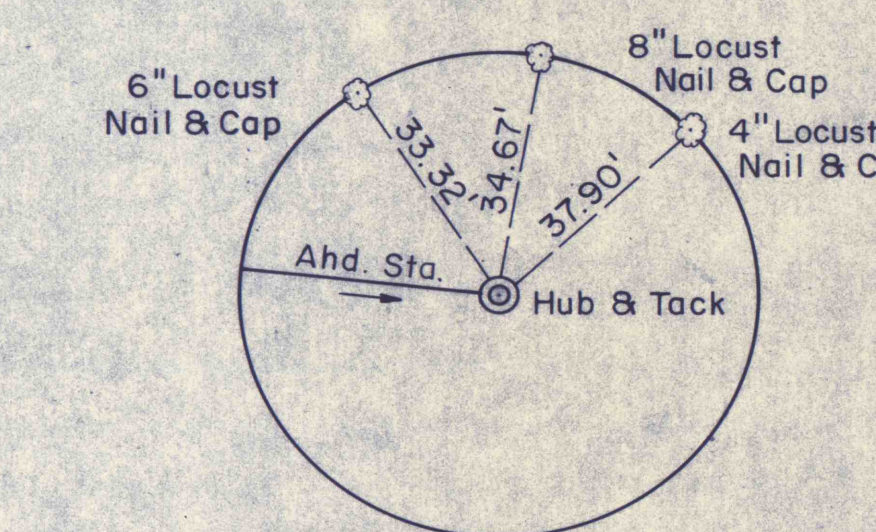

STA. 202+29

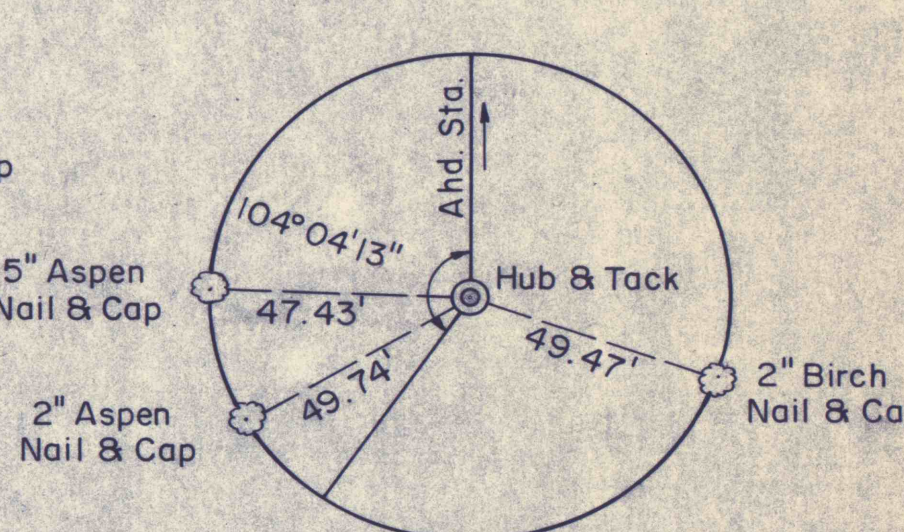

STA. C-4+34

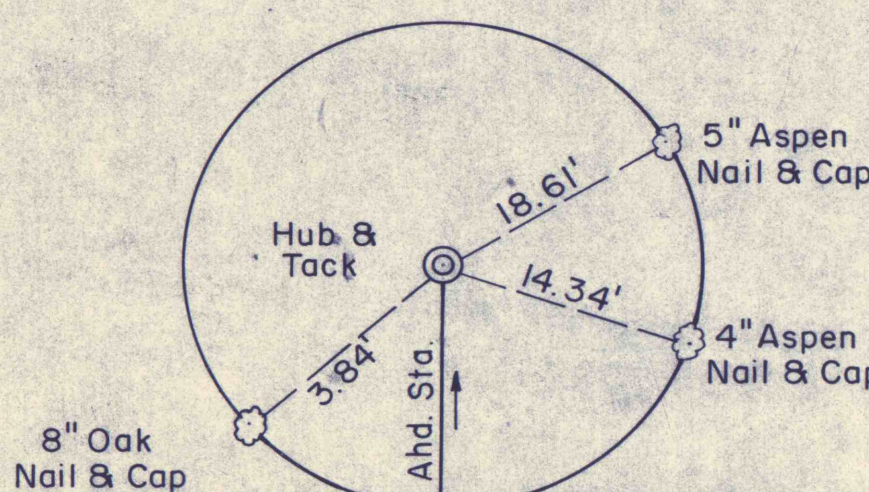

STA. C-8+31

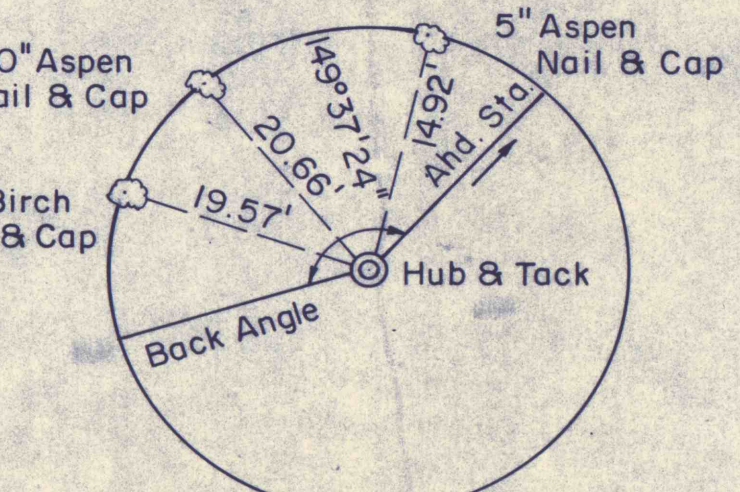

STA. D-0+00 =  
STA. 43+00

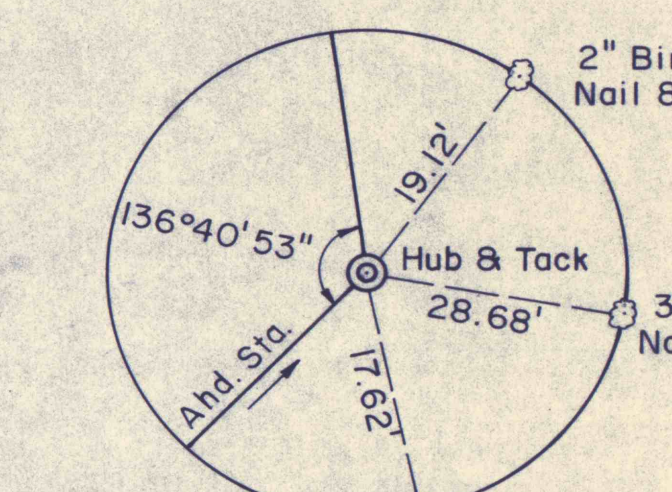

STA. D-6+53

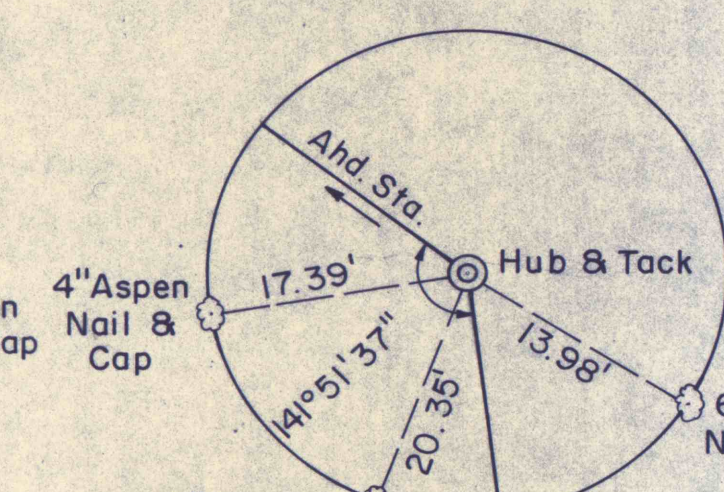

STA. D-8+83

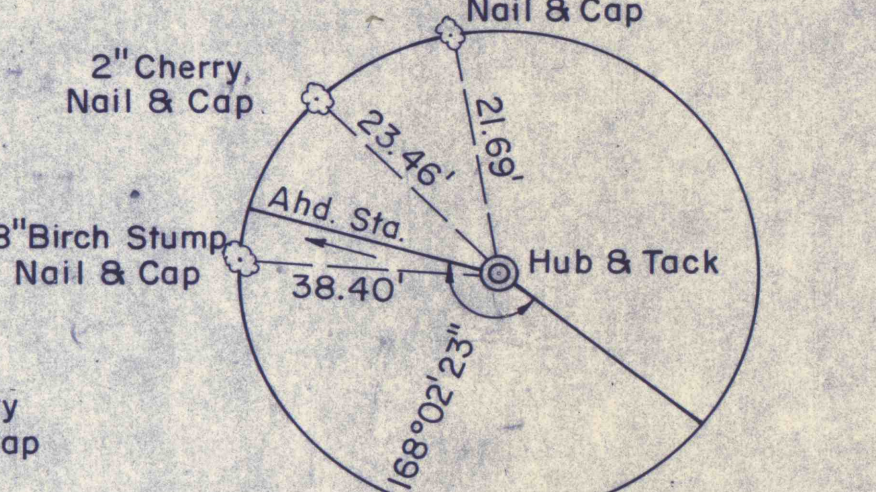

STA. D-12+67

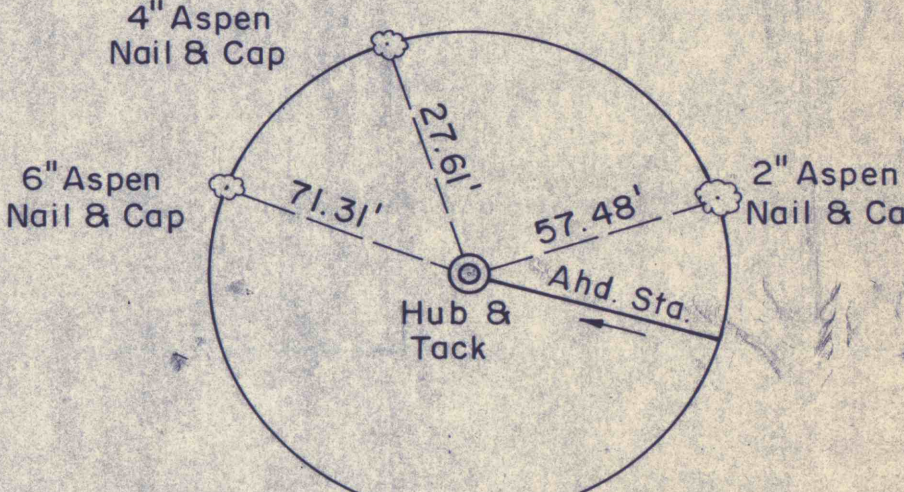

STA. D-17+51

NO.	DATE	REVISION	APPR.
SUBMITTED <i>Richard B. Ulp</i>			
PROFESSIONAL			
APPROVED <i>Robert A. Roman</i>			
CHIEF - DIVISION OF MINE RECLAMATION			
APPROVED <i>Anthony Erdman</i>			
DIRECTOR - BUREAU OF DESIGN			
COMMONWEALTH OF PENNSYLVANIA DEPARTMENT OF ENVIRONMENTAL RESOURCES OFFICE OF RESOURCES MANAGEMENT <b>PROJECT NO. SL 113-5-1</b> <b>MINE DRAINAGE POLLUTION ABATEMENT</b> <b>COAL RUN</b> <b>SHAMOKIN CREEK WATERSHED</b> <b>NORTHUMBERLAND COUNTY, PA.</b>			
ERDMAN, ANTHONY, ASSOCIATES Consulting Eng. Camp Hill, Pa.			
<b>REFERENC</b>			
DRAWN BY	DATE	DRAWN	
GMS	5-9-75		
CHECKED BY	SCALE		
DHC	NO SCALE		