

-   
 B.M. # 21 Elevation 1319.07  
 Spike & Washers in top of 5" Birch Stump  
  
 B.M. # 22 Elevation 1345.99  
 Spike & Washers in top of 3" Birch Stump  
  
 B.M. # 23 Elevation 1361.71  
 Spike & Washers in top of 6" Aspen Stump  
  
 B.M. # 24 Elevation 1365.99  
 X-Cut in top of bolt in Concrete Post  
  
 B.M. # 25 Elevation 1379.88  
 X-Cut on Metal Bar in Concrete Foundation

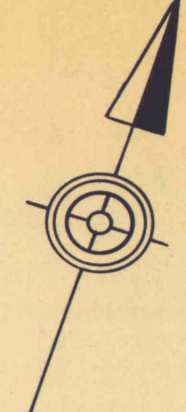

MAIN CHANNEL

NO	DATE	REVISION	APPR.
SUBMITTED			
APPROVED		<i>Richard B. Ulp</i>	
APPROVED		<i>Albert A. Ranieri</i>	
APPROVED		<i>Winters</i>	

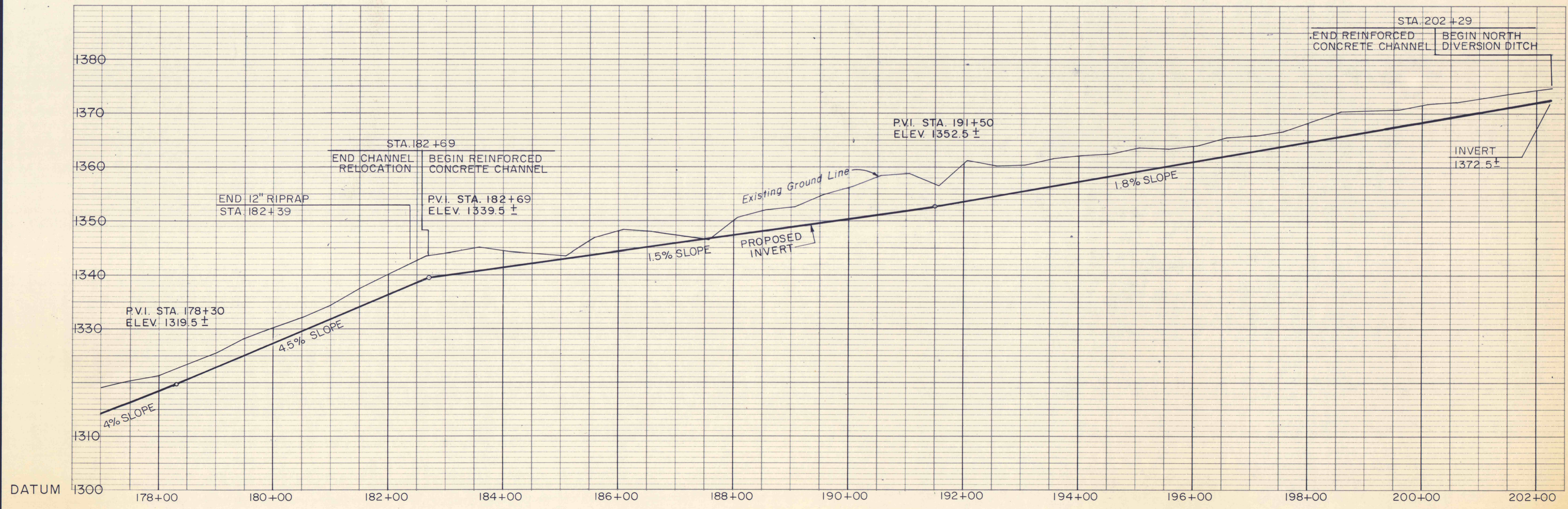
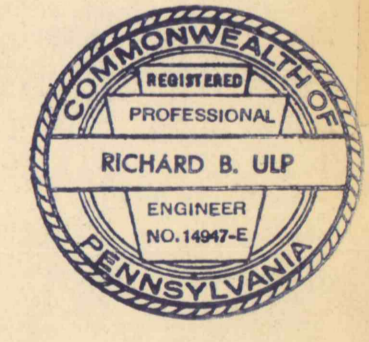

COMMONWEALTH OF PENNSYLVANIA  
 DEPARTMENT OF ENVIRONMENTAL RESOURCES  
 OFFICE OF RESOURCES MANAGEMENT  
  
**PROJECT NO. SL 113-5-1**  
  
**MINE DRAINAGE POLLUTION ABATEMENT  
 COAL RUN  
 SHAMOKIN CREEK WATERSHED  
 NORTHUMBERLAND COUNTY, PA.**  
  
 ERDMAN, ANTHONY, ASSOCIATES  
 Consulting Engineers  
 Camp Hill, Pa. Rochester, N.Y.

**PLAN & PROFILE**

DRAWN BY GMS	DATE 5-9-75	DRAWING NO. 18 of 28
CHECKED BY DHC	SCALE 1"=10' VERT 1"=100' HOR.	