

B.M. # 8 Elevation 1003.76  
Spike & Washers in top of 6" Birch Stump

B.M. # 9 Elevation 1029.03  
Spike & Washers in top of 4" Birch Stump

B.M. # 10 Elevation 1068.90  
Spike & Washers in top of 8" Birch

B.M. # 11 Elevation 1102.86  
Spike & Washers in top of 3" Locust Stump

Match to Sheet 4

Match to Sheet 10

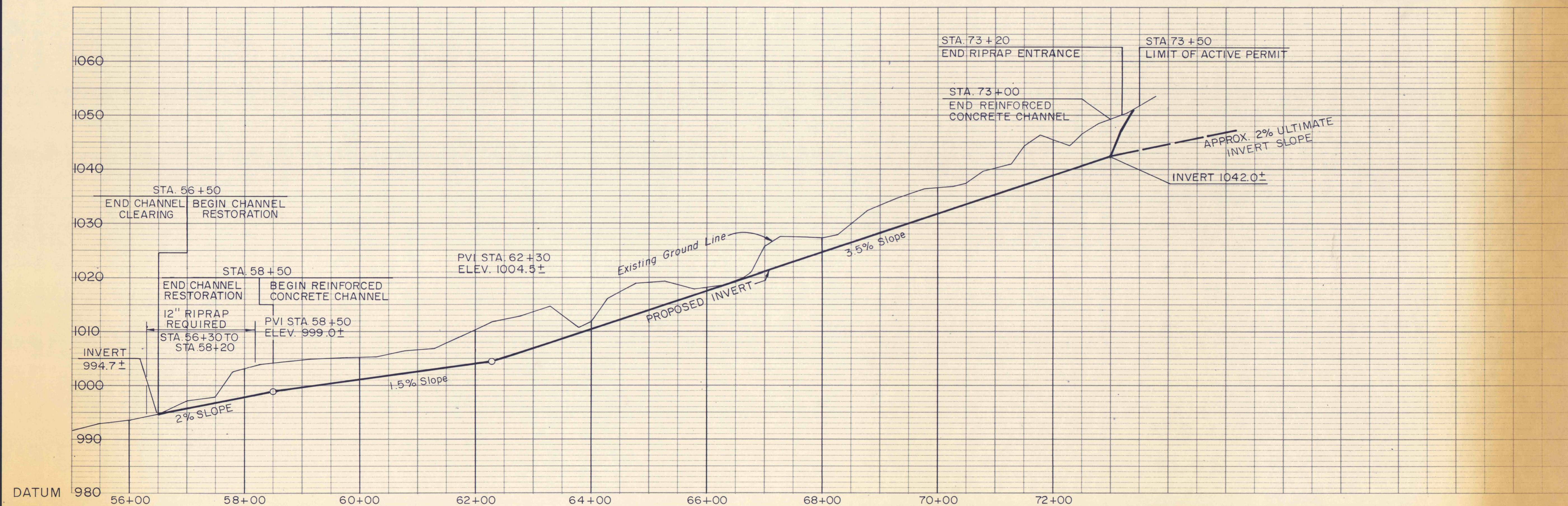

NO.	DATE	REVISION	APPR.

COMMONWEALTH OF PENNSYLVANIA  
DEPARTMENT OF ENVIRONMENTAL RESOURCES  
OFFICE OF RESOURCES MANAGEMENT

PROJECT NO. SL 113-5-1

MINE DRAINAGE POLLUTION ABATEMENT  
COAL RUN  
SHAMOKIN CREEK WATERSHED  
NORTHUMBERLAND COUNTY, PA.

ERDMAN, ANTHONY, ASSOCIATES  
Consulting Engineers  
Camp Hill, Pa. Rochester, N.Y.

MAIN CHANNEL

PLAN & PROFILE

DRAWN BY: GMS DATE: 5-9-75 DRAWING NO.: 9 of 28

CHECKED BY: DHC SCALE: 1" = 100' HOR