

NOTE:  
BOLD CONTOURS INDICATE  
REVISIONS TO ORIGINAL  
MAPPING TO REFLECT  
EXISTING TOPOGRAPHY

B.M. # 6 Elevation 959.17  
□ - Cut on Southeast Corner of  
South Parapet of Concrete Bridge

B.M. # 7 Elevation 980.46  
○ - Drill hole in top of Southeast  
Corner of Concrete Foundation

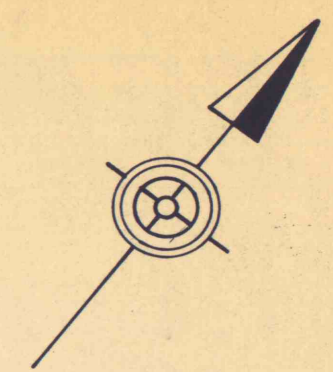

CURVE D-1	CURVE D-2	CURVE D-3
P.C. Sta. D - 0+00 C.L. = Sta. 0+60 along Back Tangent, 35' Rt.	P.C. Sta. D - 4+58 C.L. = Sta. 4+08 E., 30' Lt.	P.C. Sta. D - 15+00 C.L. = Sta. 12+21 E., 24' Lt.
P.T. Sta. D - 2+00 C.L. = Sta. 1+55 E., 10' Lt.	P.T. Sta. D - 11+80 C.L. = Sta. 12+21 E., 24' Lt.	P.T. Sta. D - 16+65 C.L. = Sta. 12+21 E., 24' Lt.
T = 101'	T = 458'	T = 84'
Δ = 25°	Δ = 90°	Δ = 33°
R = 458'	R = 458'	R = 286'

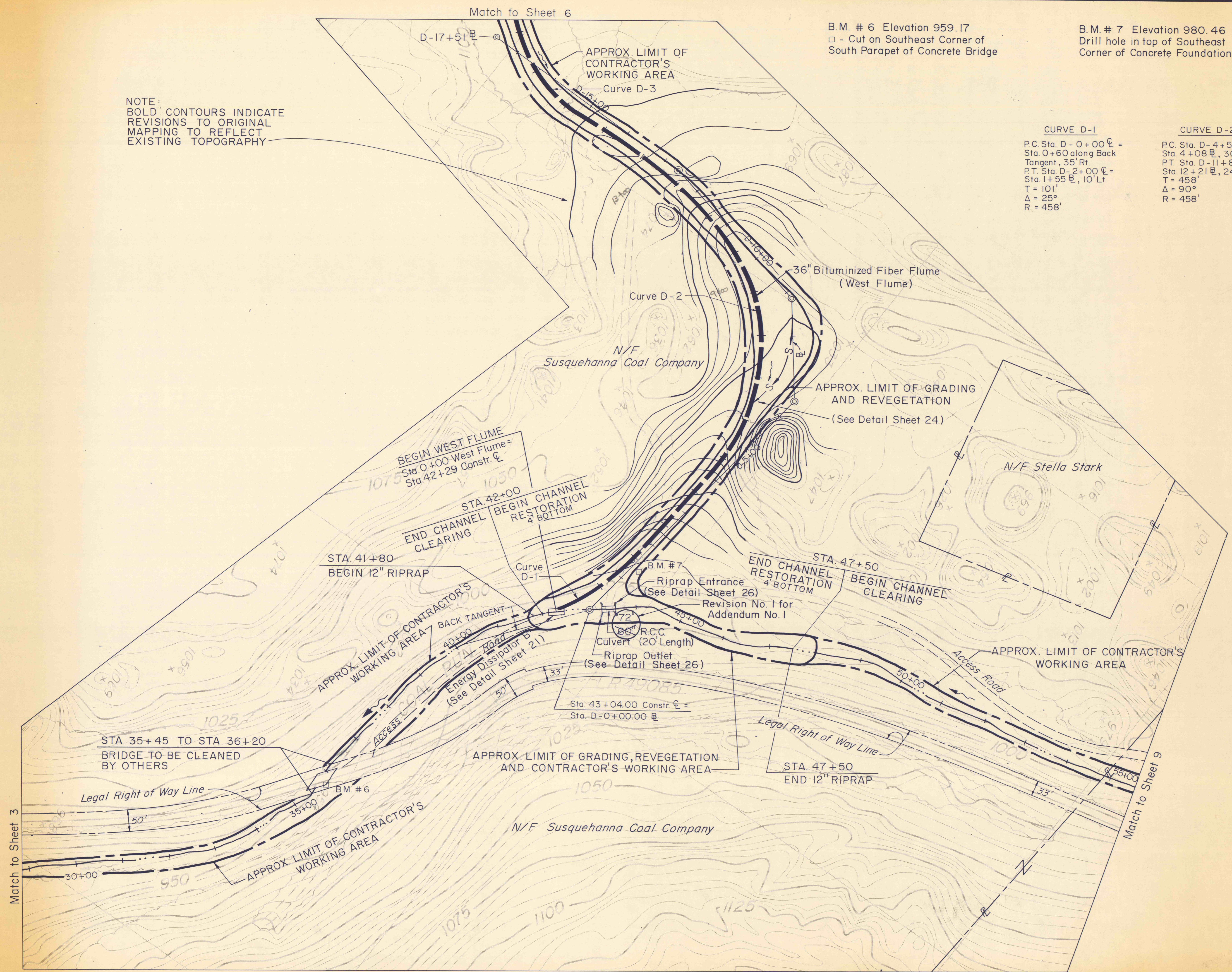

NO.	DATE	REVISION	APPR.
1	5-29-75	Changed 60" R.C.C. Culvert to 72"	RFC

SUBMITTED: *Richard B. Ulf*  
PROFESSIONAL

APPROVED: *Oliver C. Roman*  
CHIEF - DIVISION OF MINE RECLAMATION

APPROVED: *Richard B. Ulf*  
DIRECTOR - BUREAU OF DESIGN

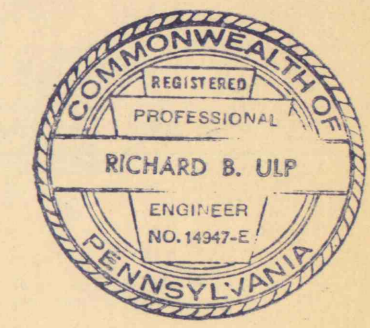

COMMONWEALTH OF PENNSYLVANIA  
DEPARTMENT OF ENVIRONMENTAL RESOURCES  
OFFICE OF RESOURCES MANAGEMENT

PROJECT NO. SL 113-5-1

MINE DRAINAGE POLLUTION ABATEMENT  
COAL RUN  
SHAMOKIN CREEK WATERSHED  
NORTHUMBERLAND COUNTY, PA.

ERDMAN, ANTHONY, ASSOCIATES  
Consulting Engineers  
Camp Hill, Pa. Rochester, N.Y.

PLAN

DRAWN BY GMS	DATE 5-9-75	DRAWING NO. 4 of 28
CHECKED BY DHC	SCALE 1" = 100'	