

Bench Mark Elev. 955.20  
 Chiseled and Painted  $\square$   
 NE Corner Old Concrete Foundation  
 70' Left of Culvert, Sta. 20+10

- (A) Proposed Route for Access to Work Area
- (1) ~~344~~ <sup>340</sup> L.F. 6 Ft. Bottom Riprapped Channel
- (2) ~~300~~ <sup>210</sup> L.F. 18" Half Section, Bituminous Fiber Pipe
- (3) ~~1001~~ <sup>1001</sup> L.F. 6 Ft. Bottom Reinforced Concrete Flume with Concrete Energy Dissipators
- (4) ~~550~~ <sup>531</sup> L.F. 24" Half Section, Bituminous Fiber Pipe
- (5) ~~400~~ <sup>406</sup> ~~430~~ <sup>434</sup> L.F. 2 Ft. Bottom Diversion Ditch
- (6) ~~240~~ <sup>210</sup> ~~200~~ <sup>200</sup> L.F. 2 Ft. Bottom Diversion Ditch
- (7) ~~95~~ <sup>95</sup> L.F. Channel Diversion Plug
- (8) ~~100~~ <sup>100</sup> ~~136~~ <sup>136</sup> L.F. 2 Ft. Bottom Diversion Ditch
- (9) ~~88~~ <sup>88</sup> L.F. Channel Diversion Plug

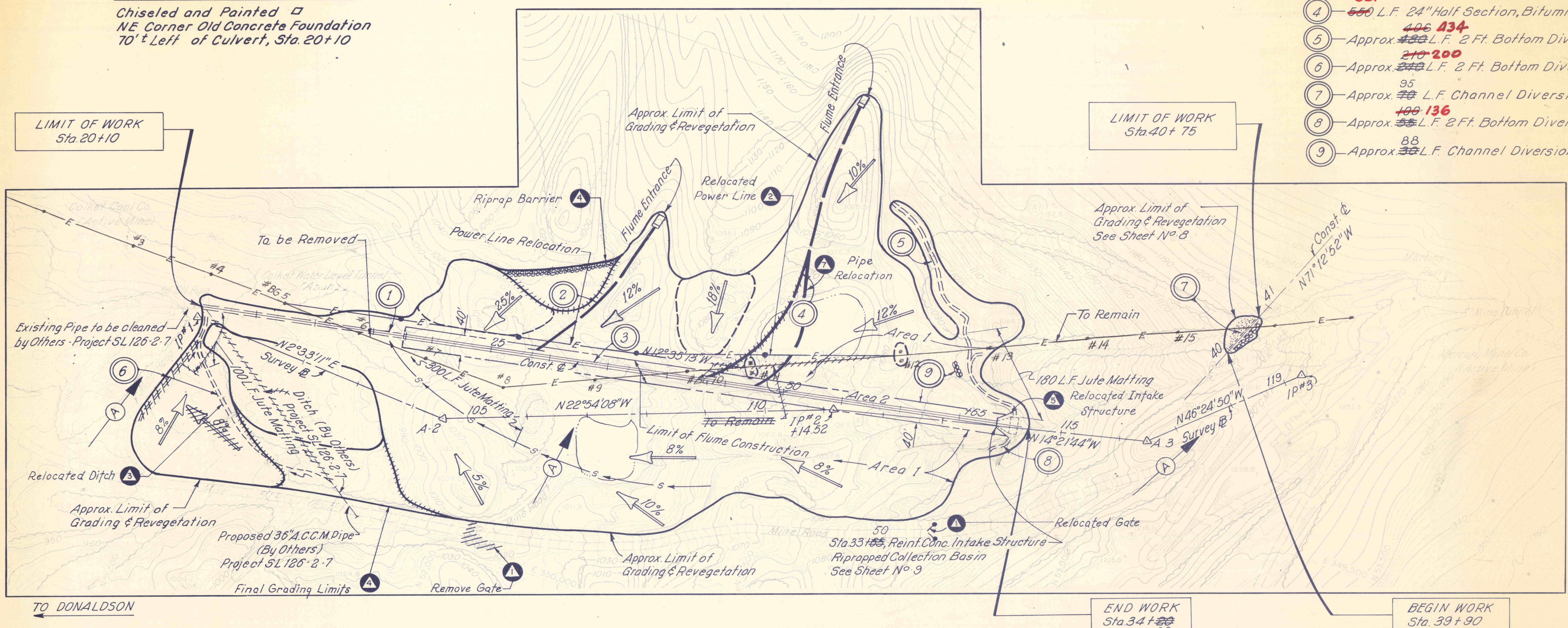

(A)	11-5-75	AS BUILT (PIPE RELOCATION)	
(A)	11-5-75	AS BUILT (QUANTITY REVISIONS)	
(A)	11-5-75	AS BUILT (RELOCATED INTAKE STRUCTURE)	
(A)	11-5-75	AS BUILT (FINAL GRADING LIMITS)	
(A)	11-5-75	AS BUILT (RELOCATED DITCH)	
(A)	11-5-75	AS BUILT (RELOCATED POWER LINE)	
(A)	11-5-75	AS BUILT (REMOVE GATE, RELOCATED GATE)	
NO	DATE	REVISION	APPR.

SUBMITTED: Norman E. Mutchler  
 PROFESSIONAL  
 APPROVED: [Signature]  
 CHIEF - DIVISION OF MINE RECLAMATION  
 APPROVED: [Signature]  
 DIRECTOR - BUREAU OF DESIGN

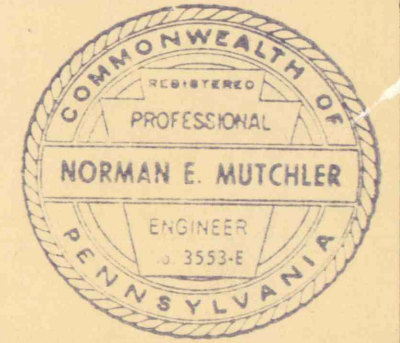

COMMONWEALTH OF PENNSYLVANIA  
 DEPARTMENT OF ENVIRONMENTAL RESOURCES  
 OFFICE OF RESOURCES MANAGEMENT  
 PROJECT NO. SL-126-2-9  
 MINE DRAINAGE  
 POLLUTION ABATEMENT  
 MARTIN'S RUN  
 SWATARA CREEK WATERSHED  
 SCHUYLKILL COUNTY  
 BERGER ASSOCIATES, INC.  
 Consulting Engineers  
 P.O. Box 1943 Harrisburg, Penna.

**SITE GRADING PLAN**  
 DRAWN BY: JS DATE: JULY 8, 1974 DRAWING NO.:  
 CHECKED BY: MW SCALE: 1" = 100' 3 OF 11

