

Bench Mark Elev. 955.20
 Chiseled and Painted \square
 NE Corner Old Concrete Foundation
 70' Left of Culvert, Sta. 20+10

- ④ Proposed Route for Access to Work Area
- ① 340 L.F. 6 Ft. Bottom Ripped Channel
- ② 300 L.F. 18" Half Section, Bituminous Fiber Pipe
- ③ 1015 L.F. 6 Ft. Bottom Reinforced Concrete Flume with Concrete Energy Dissipators
- ④ 550 L.F. 24" Half Section, Bituminous Fiber Pipe
- ⑤ Approx. 480 L.F. 2 Ft. Bottom Diversion Ditch
- ⑥ Approx. 240 L.F. 2 Ft. Bottom Diversion Ditch
- ⑦ Approx. 70 L.F. Channel Diversion Plug
- ⑧ Approx. 55 L.F. 2 Ft. Bottom Diversion Ditch
- ⑨ Approx. 30 L.F. Channel Diversion Plug

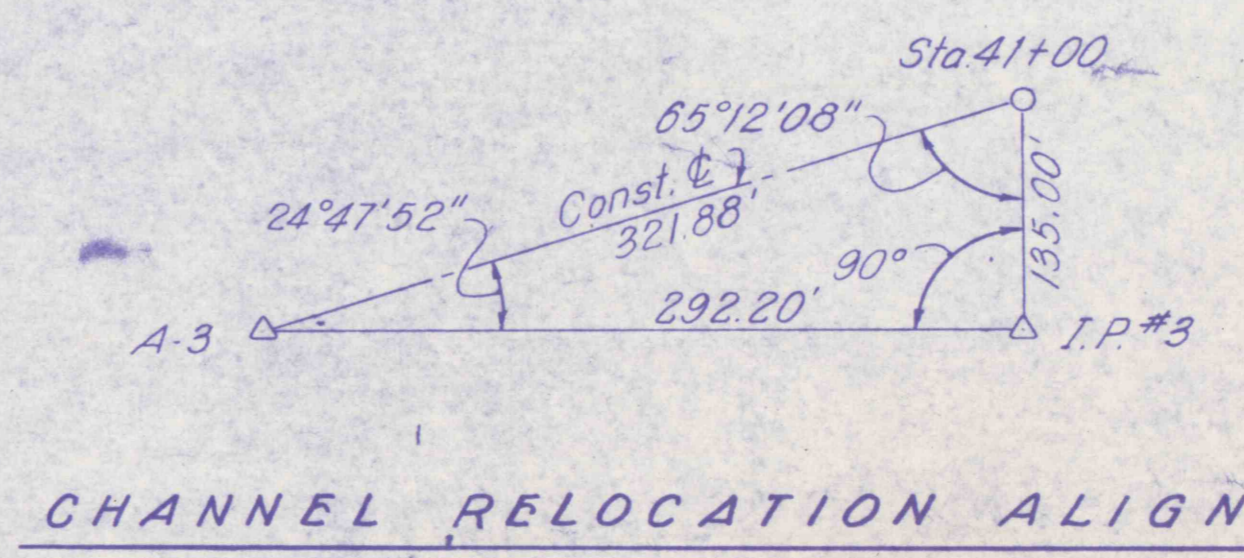
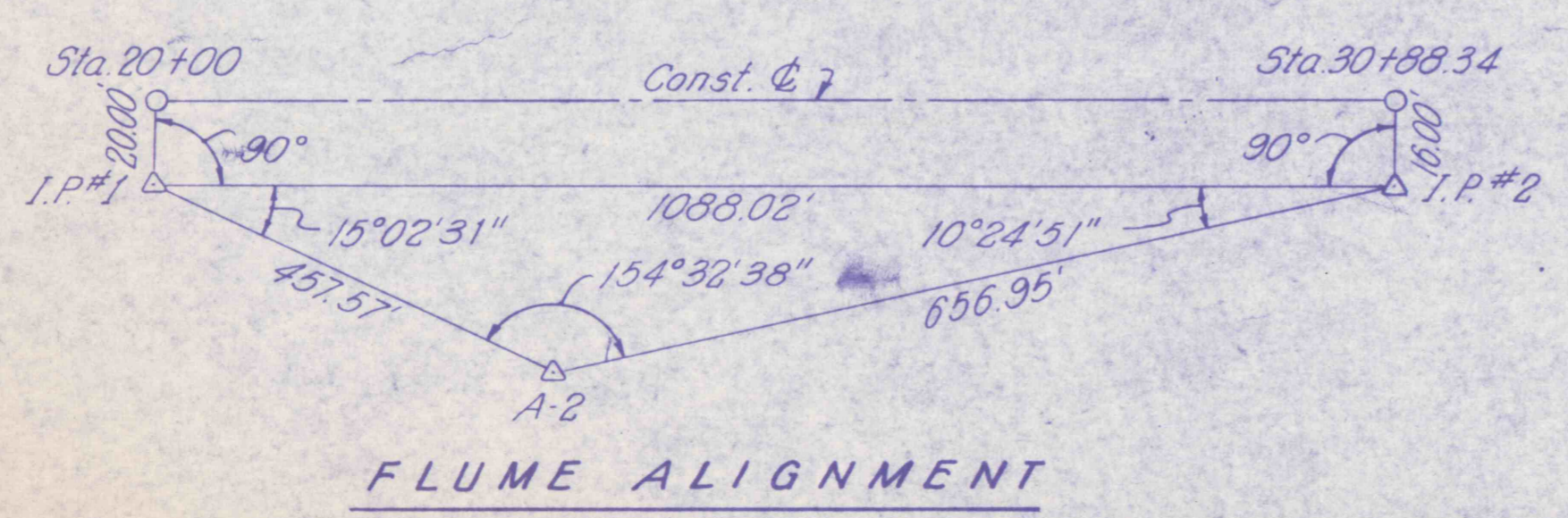
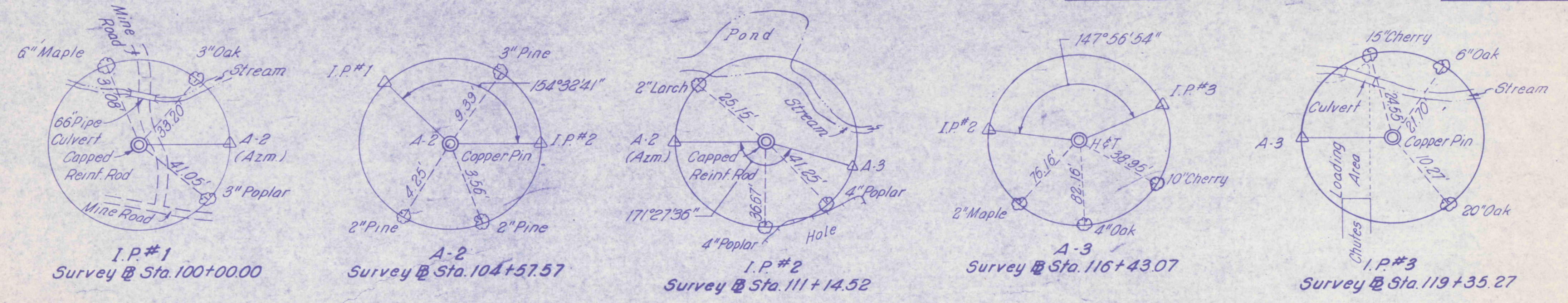
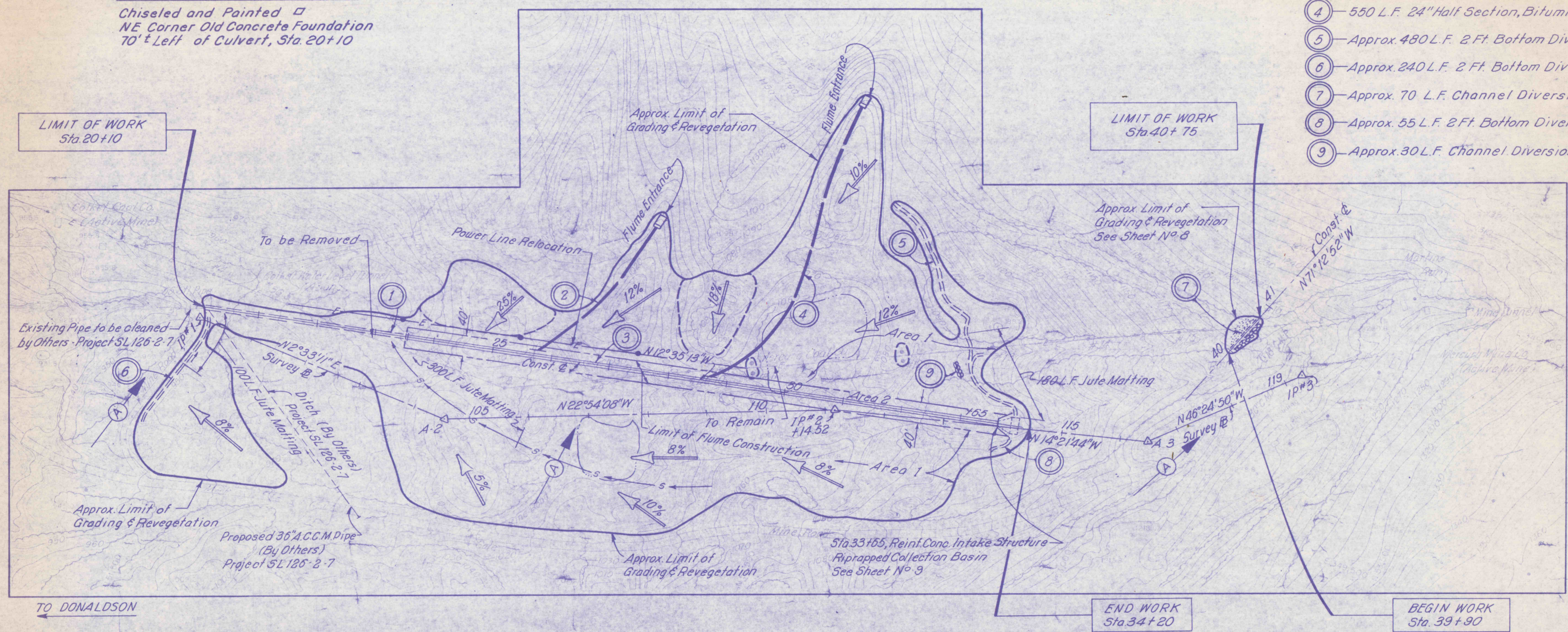

NO.	DATE	REVISION	APPR.

SUBMITTED
 Norman E. Mutchler
 PROFESSIONAL
 APPROVED
 Robert A. Raman
 CHIEF - DIVISION OF MINE RECLAMATION
 APPROVED
 Dupenego
 DIRECTOR - BUREAU OF DESIGN



COMMONWEALTH OF PENNSYLVANIA
 DEPARTMENT OF ENVIRONMENTAL RESOURCES
 OFFICE OF RESOURCES MANAGEMENT
 PROJECT NO. SL-126-2-9
 MINE DRAINAGE
 POLLUTION ABATEMENT
 MARTIN'S RUN
 SWATARA CREEK WATERSHED
 SCHUYLKILL COUNTY
 BERGER ASSOCIATES, INC.
 Consulting Engineers
 P.O. Box 1943 Harrisburg, Penna.

SITE GRADING PLAN
 DRAWN BY JS DATE JULY 8, 1974 DRAWING NO. 3 OF 11
 CHECKED BY MW SCALE 1" = 100'