

MATCH LINE - FOR CONTINUATION SEE DRAWING NO. 4

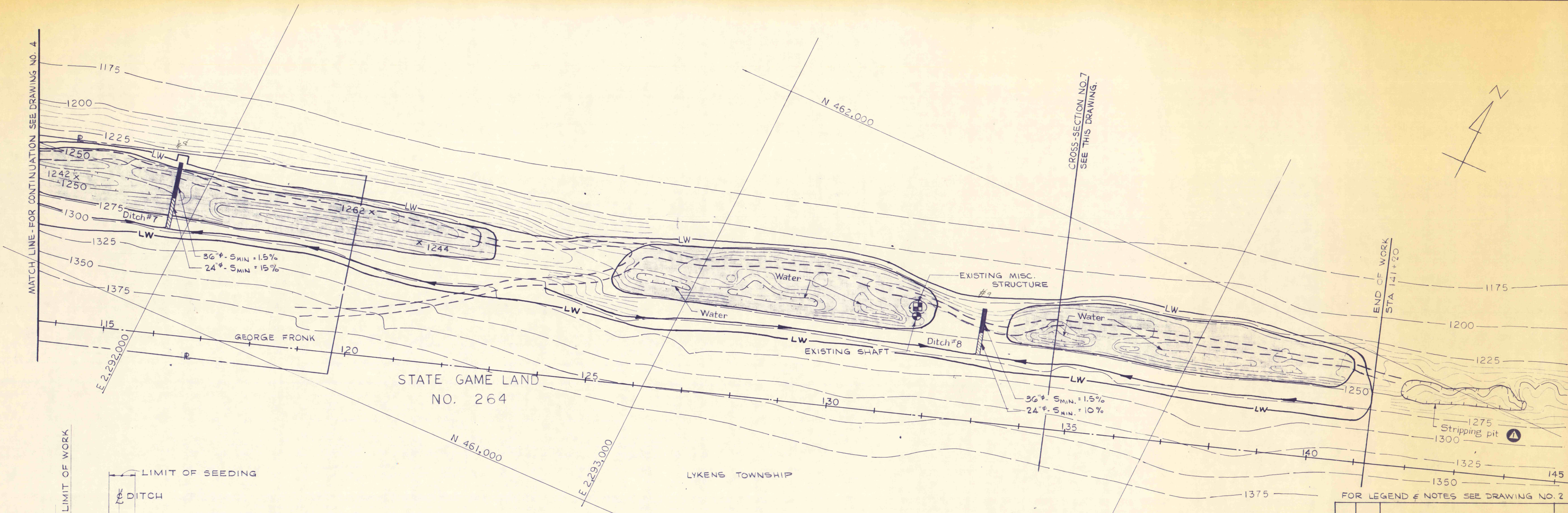

PLAN
SCALE: 1"=100'

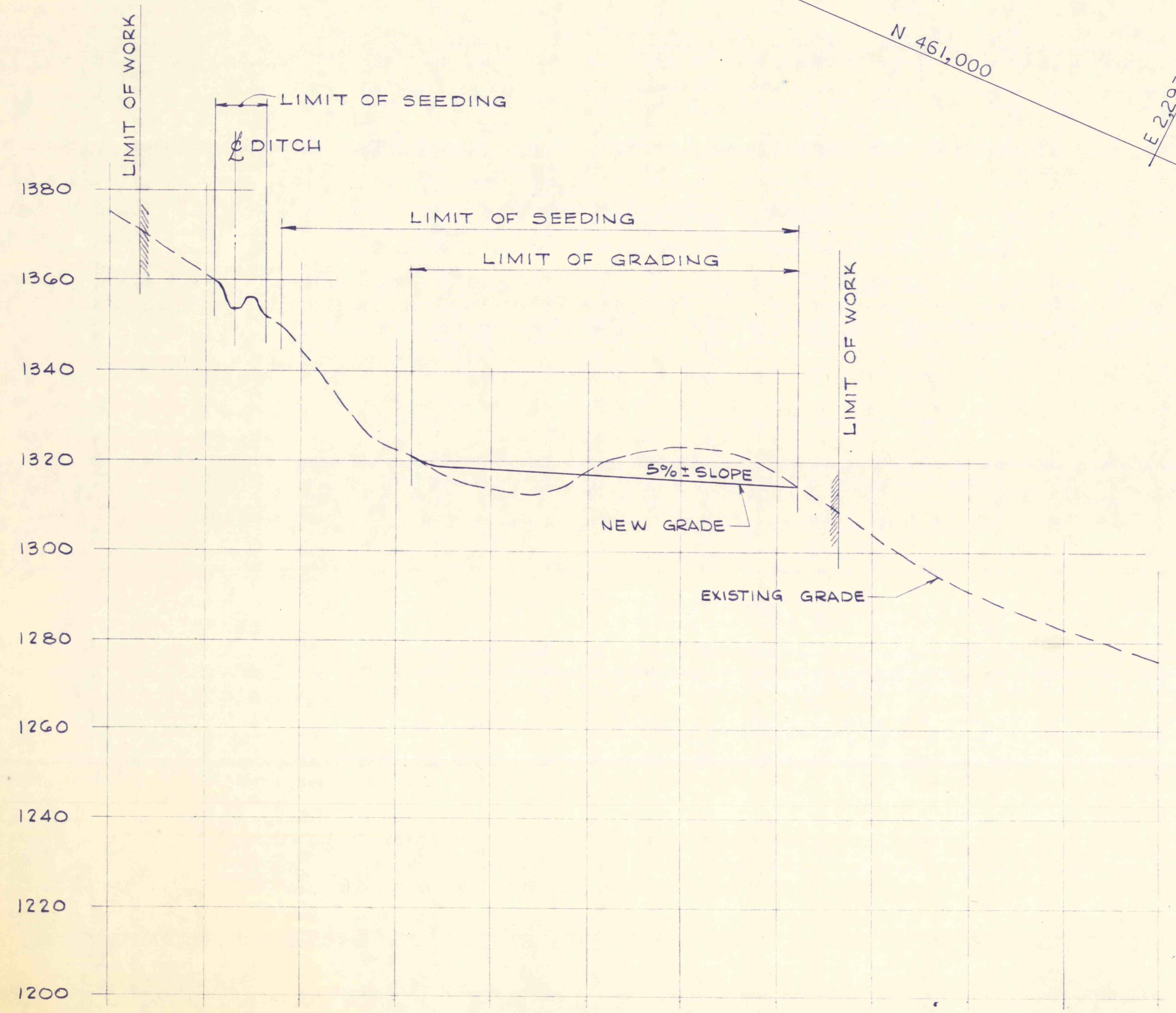

CROSS-SECTION NO. 2
SCALE: 1"=20' (HORIZ. & VERT.)
FOR LOCATION SEE DRAWING NO. 2

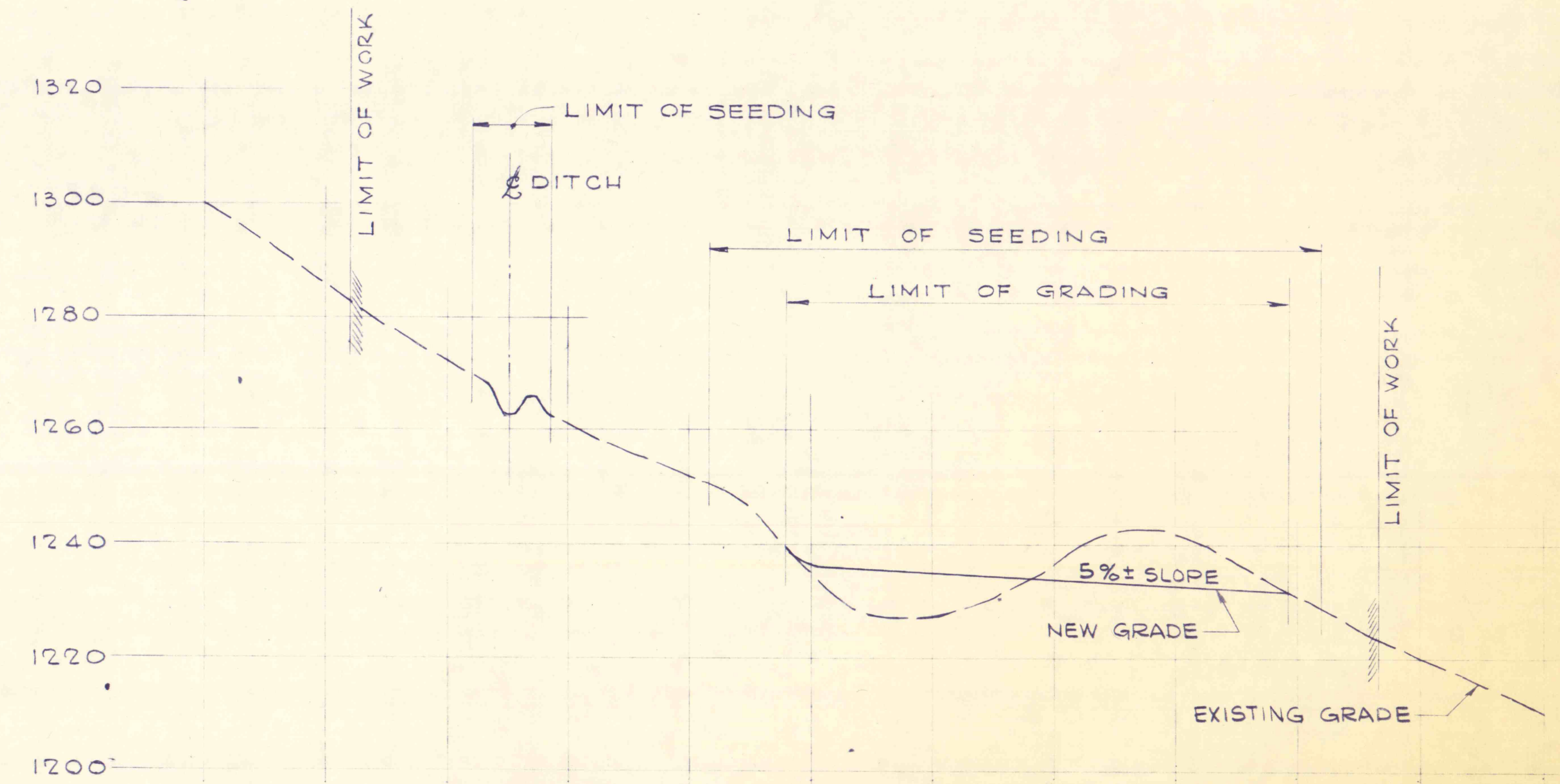

CROSS-SECTION NO. 7
SCALE: 1"=20' (HORIZ. & VERT.)
FOR LOCATION SEE THIS DRAWING.

FOR LEGEND & NOTES SEE DRAWING NO. 2

NO.	DATE	REVISION	APPR.
1	9-24-75	As built	
SUBMITTED			
<i>Thomas Richard Babacz</i> PROFESSIONAL			
APPROVED			
<i>Robert C. Ranieri</i> CHIEF - DIVISION OF MINE DRAINAGE REHABILITATION			
APPROVED			
<i>John Perreco</i> DIRECTOR - BUREAU OF CONSULTING SERVICES			

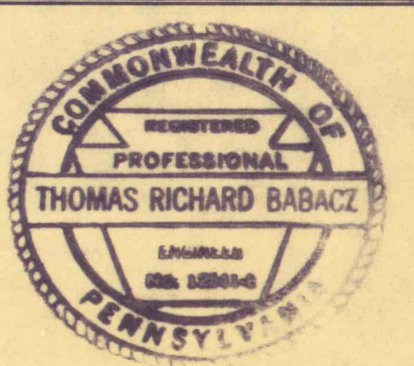

COMMONWEALTH OF PENNSYLVANIA
DEPARTMENT OF ENVIRONMENTAL RESOURCES
OFFICE OF ENGINEERING AND CONSTRUCTION

PROJECT NO. SL 170
STRIP MINE RECLAMATION
QUICK START PROJECT "B"
STATE GAME LAND NO. 264
WICONISCO CREEK WATERSHED
DAUPHIN COUNTY, PENNA.

SANDERS AND THOMAS, INC.
CONSULTING ENGINEERS
EXECUTIVE OFFICES: POTTSTOWN, PENNSYLVANIA
BRANCH OFFICES: PHILADELPHIA, PA. - LONG ISLAND, N.Y. - MIAMI, FLA.
PITTSBURGH, PA. - BALTIMORE, MD. - LONG BEACH, CALIF. - WASHINGTON, D.C.

**PLAN & CROSS-SECTIONS
NOS. 2 & 7**

DRAWN BY	DATE	DRAWING NO.
TZ	MAY 4, 1973	5 of 7
CHECKED BY	SCALE	
TS	AS NOTED	