

B O U L E V A R D A V E .

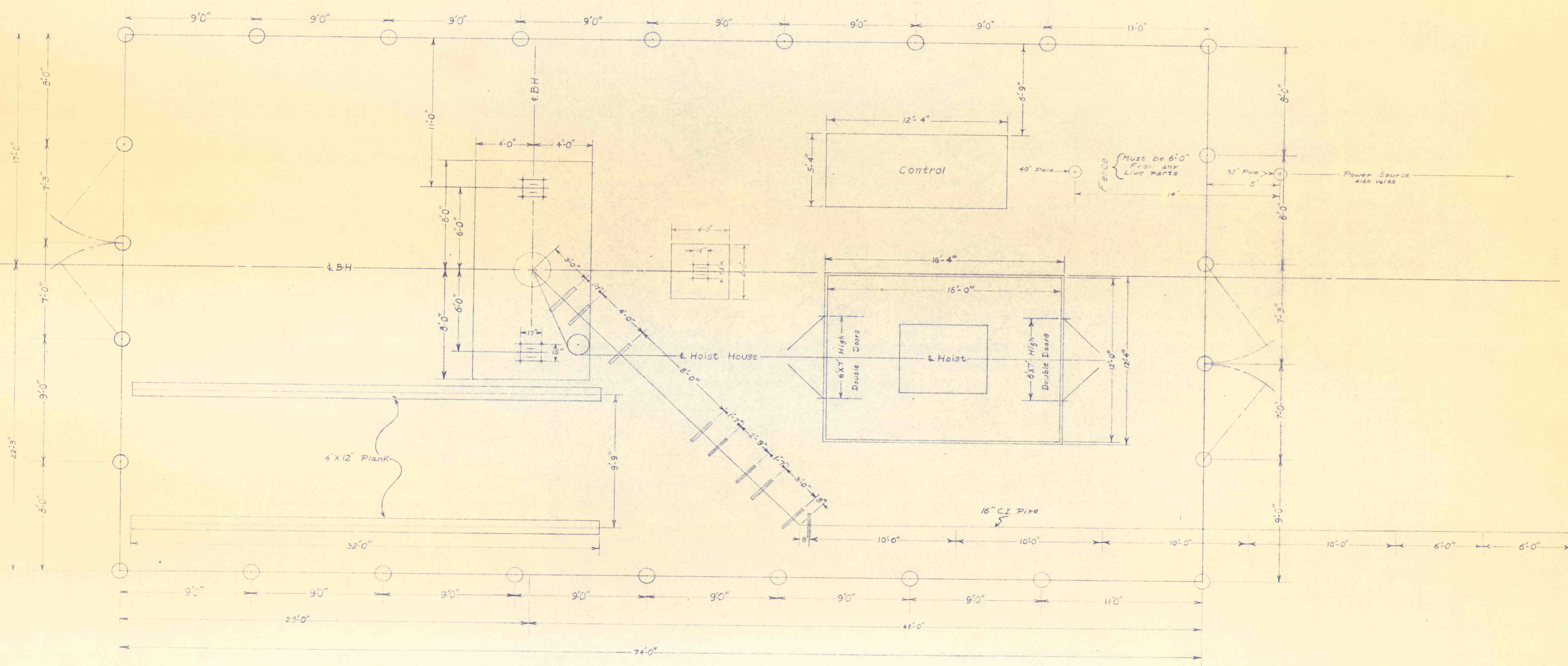
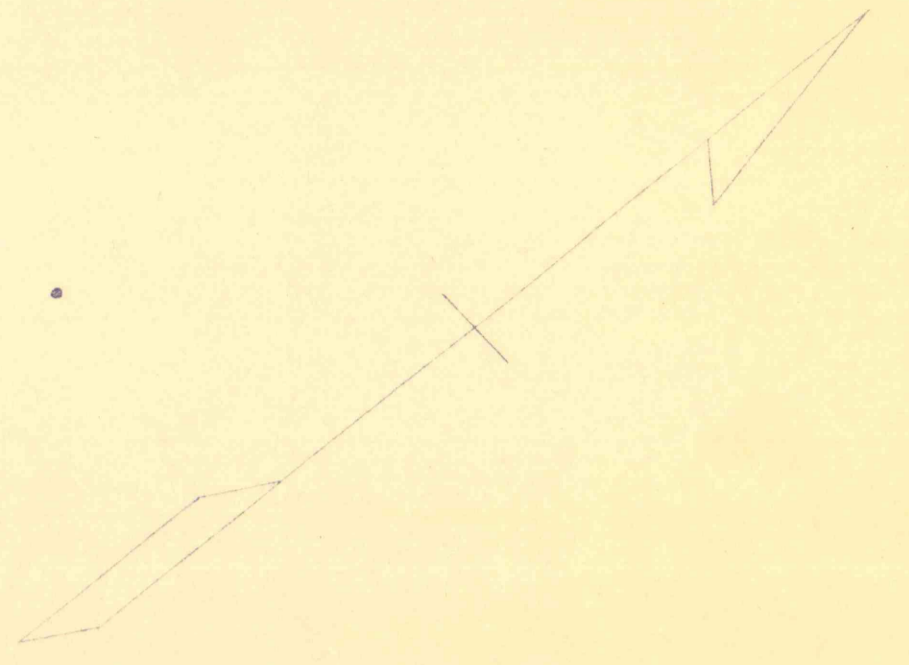

GENERAL ARRANGEMENT-PLAN  
of Proposed  
DEEP WELL PUMP INSTALLATION  
Situated at  
MARVINE COLLIERY  
in  
CITY OF SCRANTON, LACKAWANNA COUNTY, PENNA.  
DEPARTMENT OF MINES AND MINERAL INDUSTRIES  
30 East Union Street, Wilkes-Barre, Penna.  
Scale: 1/4"=1'  
February 24, 1927  
Plan No-1  
Drawn By Pete Wilgus

F-18-93

E-18-93