

LEGEND

- GENERAL CULTURAL FEATURES**
 - SHOPPING CENTER
 - INDUSTRIAL PARK
 - APARTMENT COMPLEX
 - MOBILE HOME PARK
 - STATE PARK OF COUNTY, MUNICIPALITY
 - AMUSEMENT PARK
 - HARBORBOURNE BASE COURSE SPEEDWAY
 - TOLL BOOTH
 - ROADSIDE REST AREA
 - SCHOOL, COLLEGE OR UNIVERSITY
 - CLUBHOUSE OR OTHER RECREATION INSTITUTION
 - CEMETERY
 - COURTHOUSE WITH CEMETERY ADJACENT
 - HOSPITAL
 - CORRECTIONAL INSTITUTION
 - COUNTY FARM
 - STATE HIGHWAY GARAGE
 - STATE POLICE STATION
 - FIRE STATION
 - POST OFFICE
 - MUNICIPAL BUILDING
 - RADIO OR TELEVISION TOWER
- COMMUNITY CENTERS**
 - STATE CAPITAL
 - COURT SEAT
 - OTHER COMMUNITIES
- MISCELLANEOUS MAP FEATURES**
 - HORIZONTAL CONTROL STATION
 - BENCHMARK WITH ELEVATION
 - LATITUDE AND LONGITUDE LINE
 - BOUNDARY MONUMENT
- AERONAUTICAL FEATURES**
 - MILITARY AIRFIELD
 - AIRPORT COMPLETE FACILITIES
 - AIRPORT LIMITED FACILITIES
 - SEAPLANE BASE
 - HELIPORT
 - AIRWAY BEACON
- ROADWAY STRUCTURES**
 - HIGHWAY BRIDGE
 - LONG BRIDGE OR VIADUCT
 - COVERED BRIDGE
 - TRUSS BRIDGE
 - SUSPENSION BRIDGE
 - ARCH BRIDGE
 - TRUSS BRIDGE
 - RAILROAD BRIDGE
 - DAM WITH ROAD
 - HIGHWAY TUNNEL
 - LEVEE OR DIKE WITH ROAD
- DRAINAGE FEATURES**
 - RIVER OR WIDE STREAM
 - STREAM
 - INTERMITTENT STREAM
 - WIDE STREAM WITH DAM
 - LAKE POND OR RESERVOIR WITH DAM
 - LOCK WITH DAM
 - SWAMP OR MARSH
 - FERRY, TOLL, FT., FERRY, FT.
 - FORD
- RAILROADS**
 - STANDARD GAUGE RAILROAD
 - NARROW GAUGE RAILROAD
 - ELECTRIC RAILROAD
 - RAILROAD OVERPASS
 - RAILROAD UNDERPASS
 - GRADE CROSSING
 - RAILROAD TUNNEL
 - RAILROAD STATION
 - ABANDONED RAILROAD
 - ABANDONED RAILROAD
- BOUNDARIES**
 - STATE LINE
 - COUNTY LINE
 - TOWNSHIP LINE
 - INCORPORATED CITY
 - INCORPORATED BOROUGH
 - UNINCORPORATED URBAN CONTRACT LINE
 - ENLARGED FIRST LINE
 - FEDERAL OR STATE LAND LINE
 - INDICATES FIRST CLASS TOWNSHIP
- ROAD AND HIGHWAY FEATURES**
 - INTERSTATE TRAFFIC ROUTE NUMBER
 - U.S. TRAFFIC ROUTE NUMBER
 - PENNSYLVANIA TRAFFIC ROUTE NUMBER
 - PENNSYLVANIA LEGISLATIVE ROUTE NUMBER
 - COUNTY ROAD
 - TOWNSHIP ROAD NUMBER
 - LOCAL ROAD IN FIRST OR SECOND STREET
 - DIVIDED HIGHWAY
 - CONCRETE OR BRICK ROAD
 - BITUMINOUS ROAD
 - GRAVEL OR STONE ROAD
 - GRAVEL OR STONE ROAD
 - GRAVEL AND GRAINED ROAD
 - PRIMITIVE ROAD
 - UNPAVED ROAD

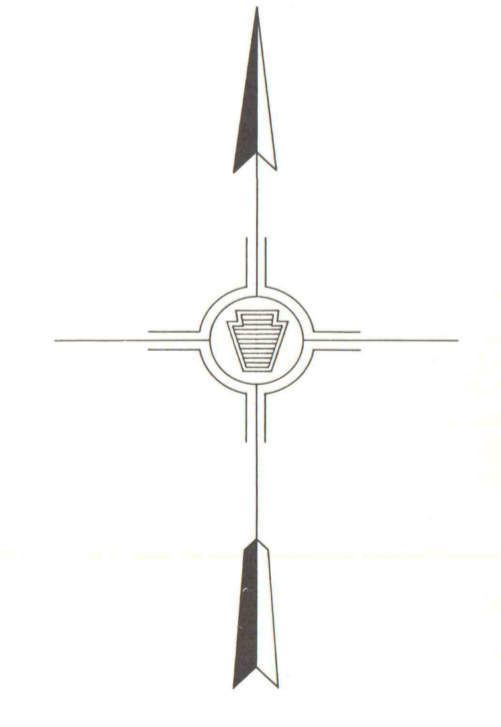
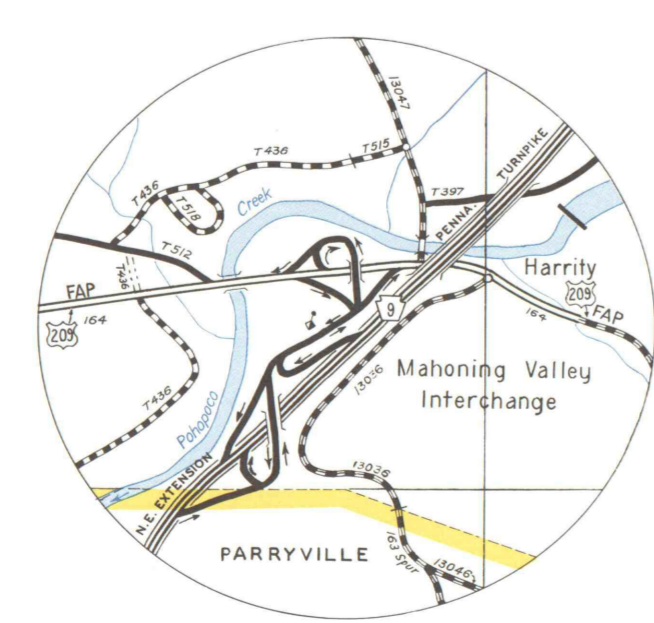
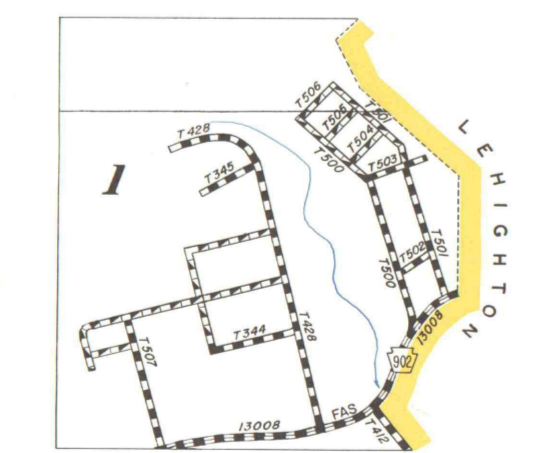
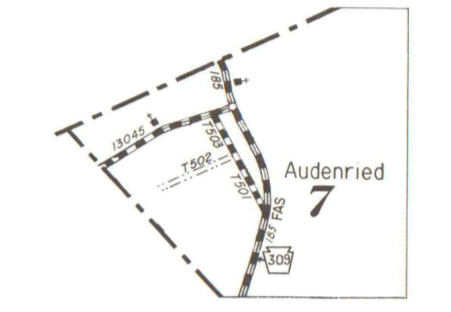
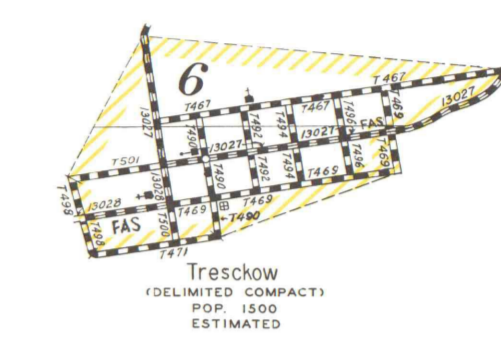
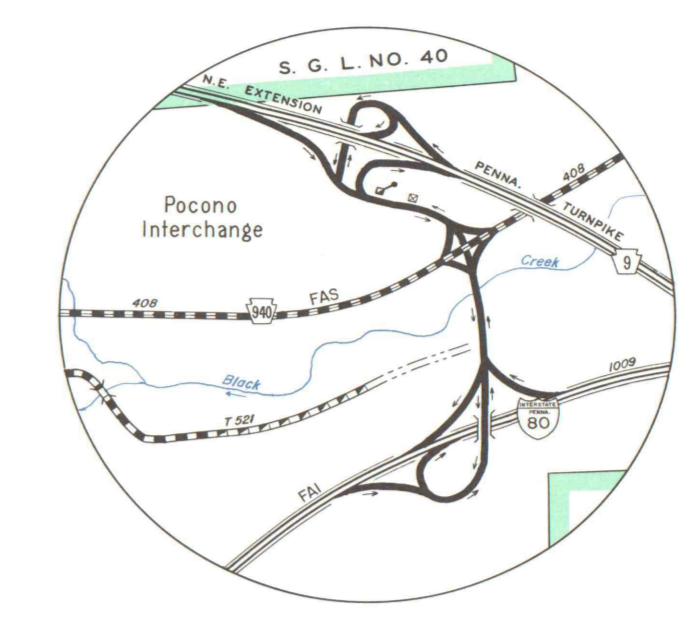
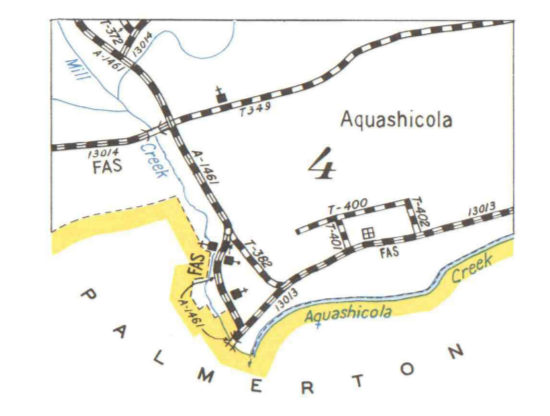
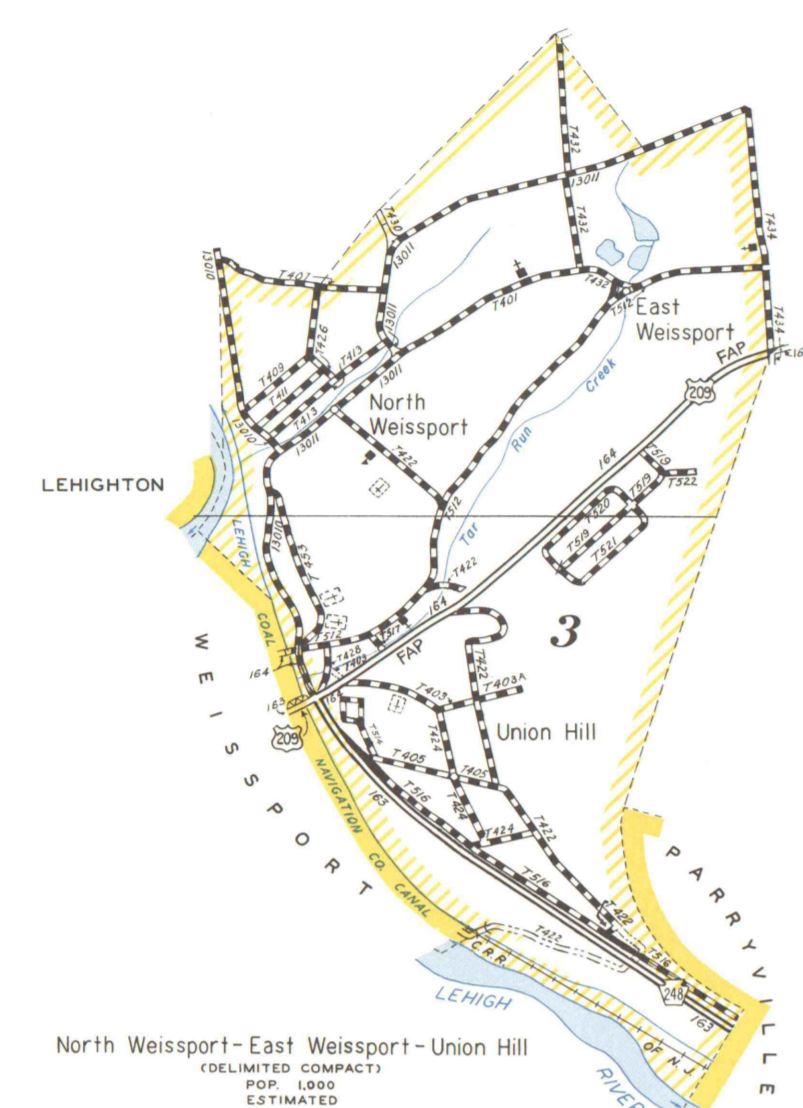
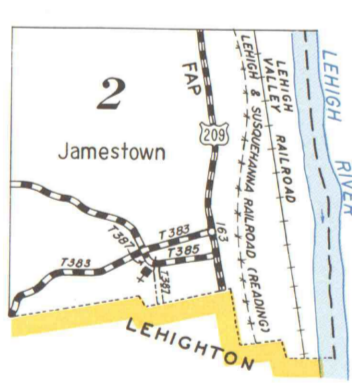
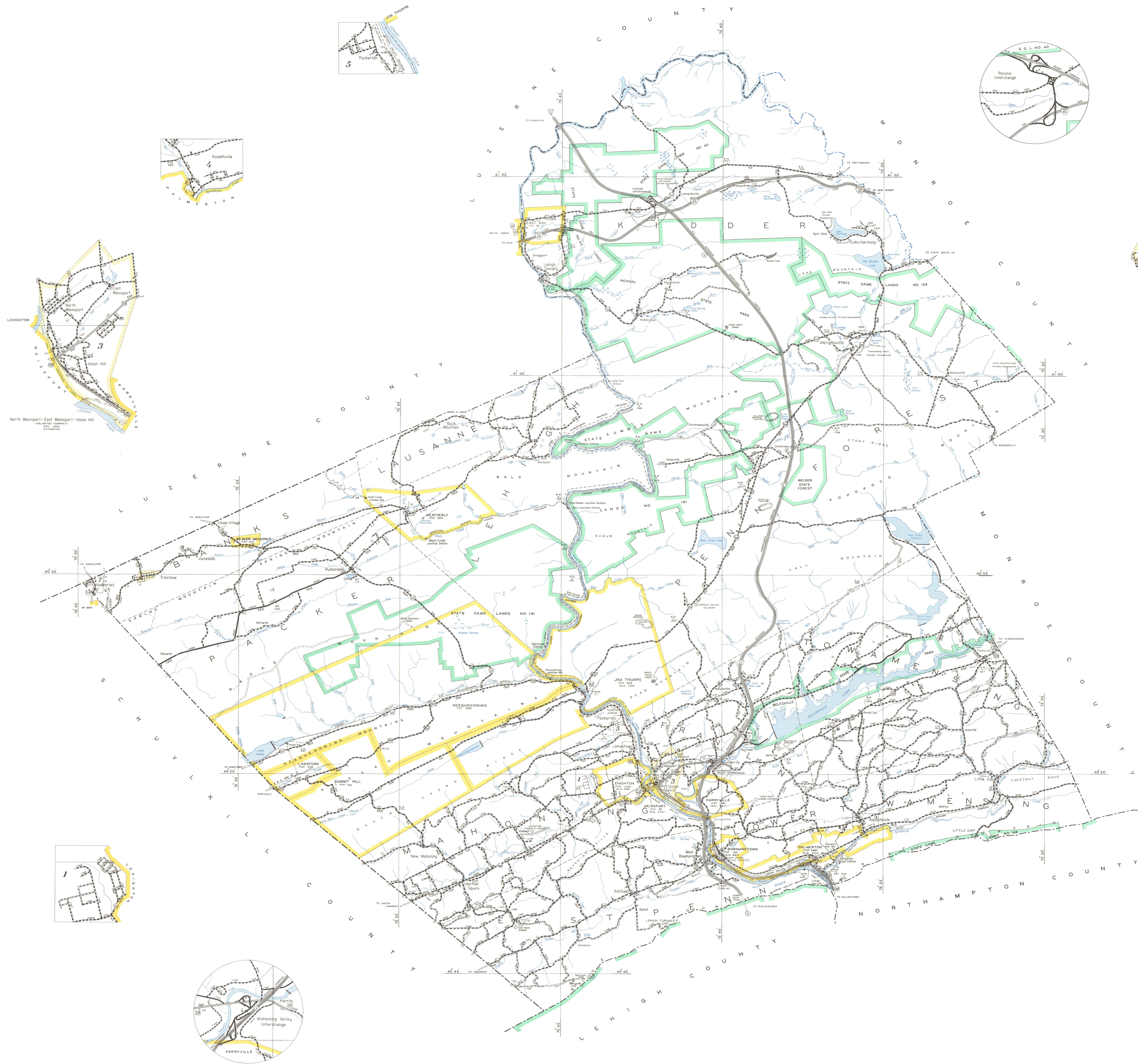

GENERAL HIGHWAY MAP
CARBON COUNTY
 PENNSYLVANIA

PREPARED BY THE
 PENNSYLVANIA DEPARTMENT OF TRANSPORTATION
 IN COOPERATION WITH THE
 U.S. DEPARTMENT OF TRANSPORTATION
 FEDERAL HIGHWAY ADMINISTRATION
 DATA OBTAINED FROM
 STATE-WIDE HIGHWAY PLANNING SURVEY

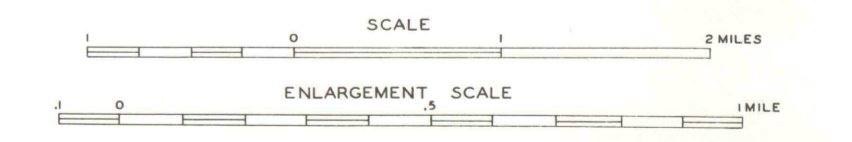

1974

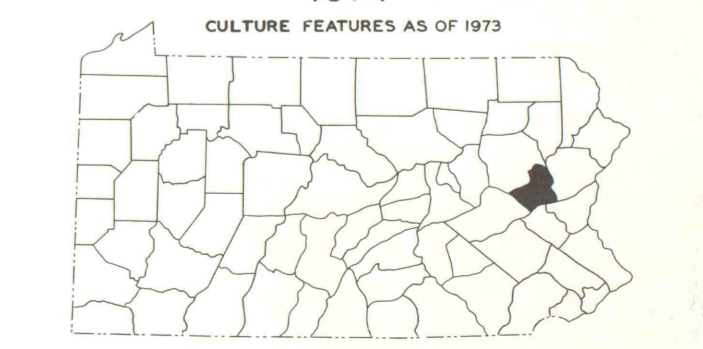

POPULATION OF COUNTY, 1970 CENSUS, 50,973
 AREA OF COUNTY, 1,400 SQUARE MILES

COPIES OF THIS MAP ARE AVAILABLE AT VARIOUS OFFICES

PROFESSIONAL ENGINEER'S SEAL AND REGISTERED PROFESSIONAL SURVEYOR'S SEAL