

1:15,000  
 (S-1)  
 Mt. Carmel (W. Central) (C-3)  
 2000 foot  
 1:15,000  
 1:15,000  
 1:15,000

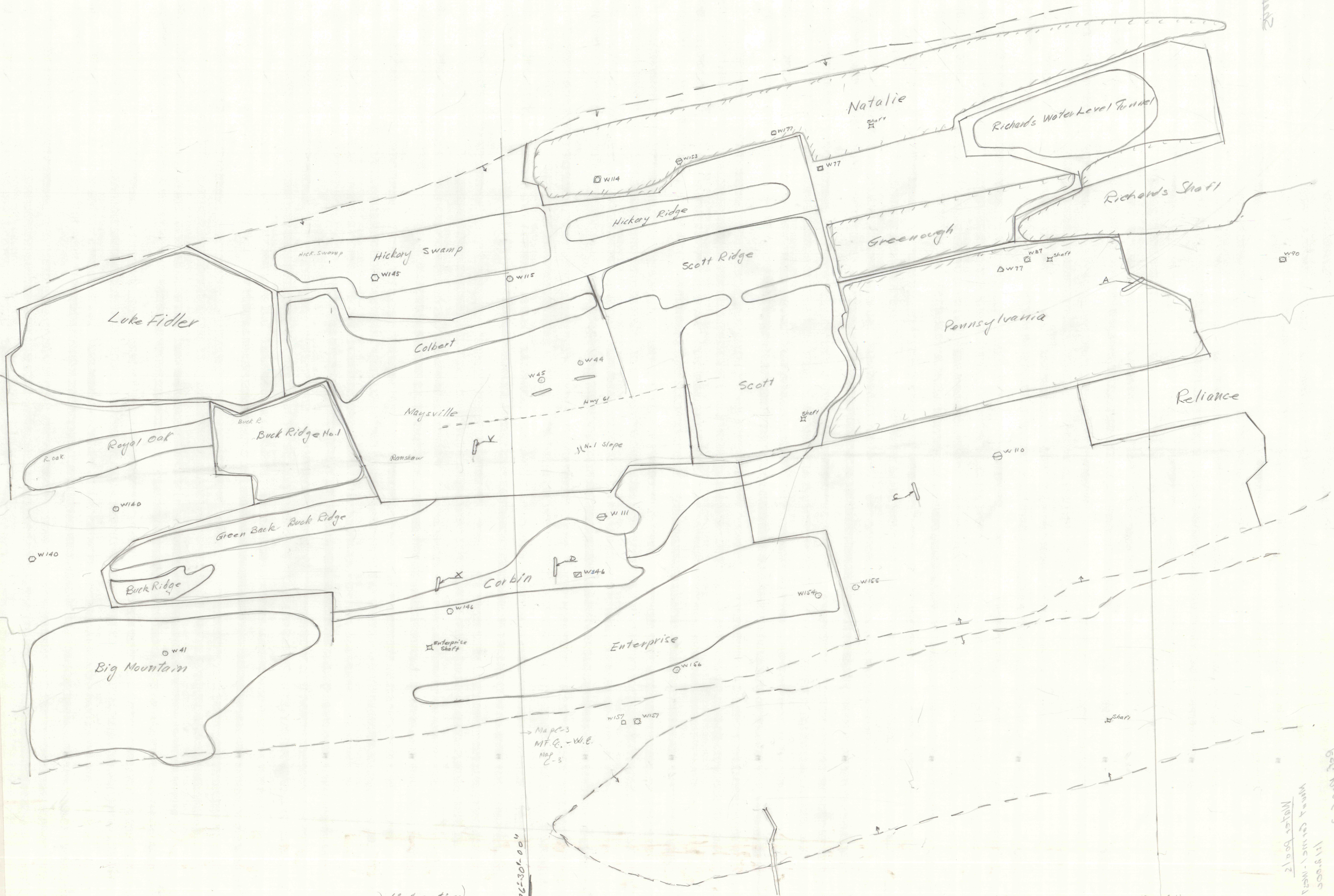

Shamokin-E. (C-16) (bad portion)

76°30'00"  
 76°30'00"  
 76°30'00"

Mount Carmel (W. Central) (C-3)  
 See 34W 1:6000 scale

C-3  
 M.F.C. - W.C.  
 W.C. 76-26-15"

1:15,000

Mt. Carmel (SE)  
 C-12

See Map C-3  
 1:15,000  
 Mount Carmel - West  
 Major 00012