

**LEGEND**

W	WATER LINE
N	YARD HYDRANT
S	SANITARY LINE
●	SANITARY MANHOLE
---	STORM DRAIN LINE
T.D.	TILE DRAIN LINE
▭	CATCH BASIN
—	HEADWALL
AW	ACID WATER LINE
UT	EXISTING UTILITY POLES
---	PROPERTY LINE
X	CHAIN LINK FENCE
▭	CONCRETE PAVING
▭	BITUMINOUS PAVING
---	CENTERLINE
SD	SPRINKLE DRAIN LINE
SH	SODIUM HYDROXIDE LINE

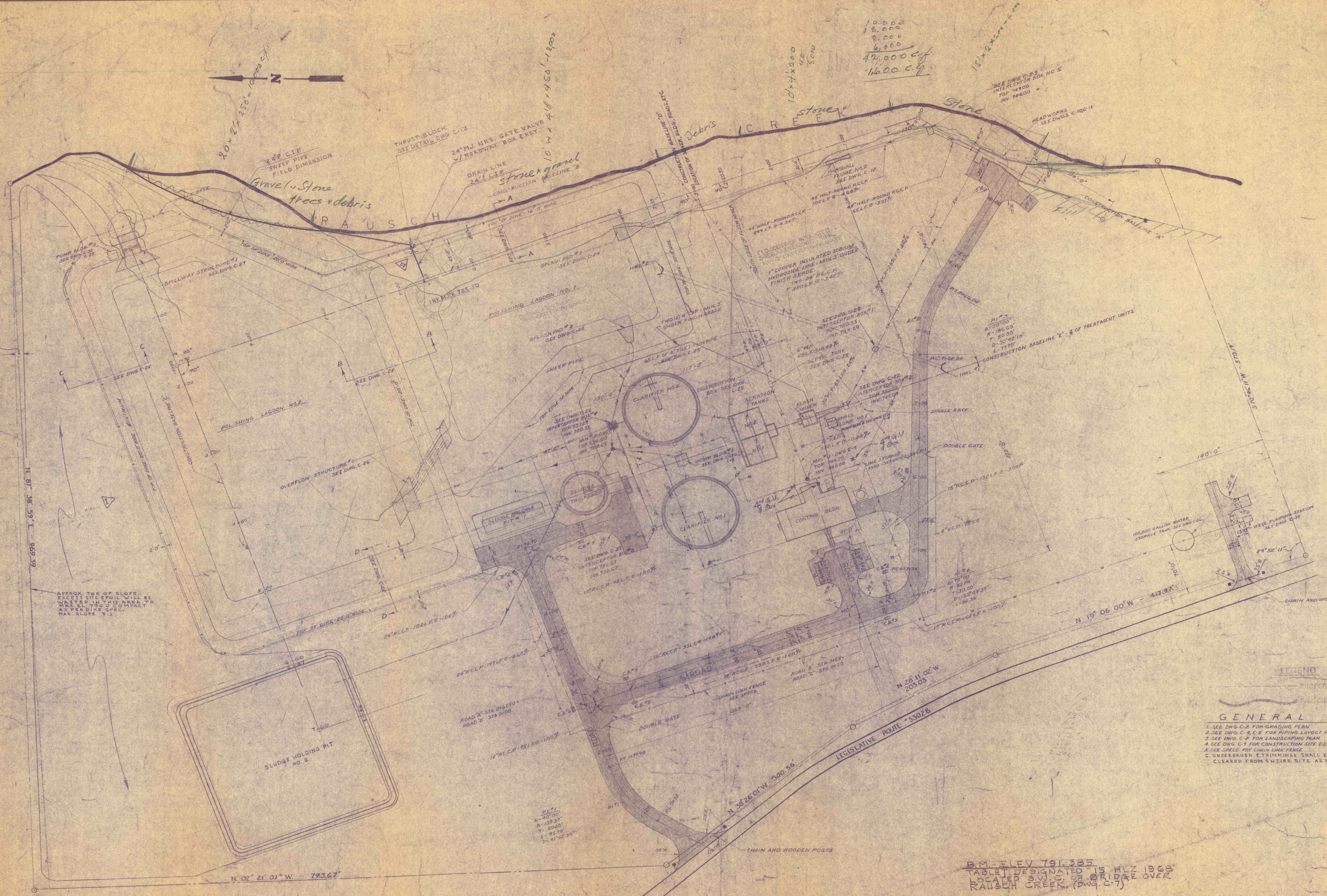

APPROX. TOP OF SLOPE  
SINCE THIS SLOPE WILL BE  
WASHER IN THE AREA TO  
AS BEING SPECIFIED  
MAX. SLOPE 3:1

**LEGEND**

PROPERTY LINE

RAUSCH CREEK EXISTING STREAM BED

**GENERAL NOTES**

1. SEE DWG. C-2 FOR GRADING PLAN
2. SEE DWG. C-4, C-5 FOR PIPING LAYOUT PLAN
3. SEE DWG. C-6 FOR LANDSCAPING PLAN
4. SEE DWG. C-7 FOR CONSTRUCTION SITE DETAILS
5. SEE SPECS FOR CHAIN LINK FENCE
6. UNDER BRUSH & TRIMMING SHALL BE  
CLEARED FROM ENTIRE SITE AS PER SPECS.

BM ELEV 791.385  
TABLE DESIGNATED 15 HLZ 1968  
LOCATED S.W. C. OF BRIDGE OVER  
RAUSCH CREEK (DWG. C-7)

II	CH-8	DELETED CONC. VALVE BOX LEB
I	CH-7	DELETED CONC. WALL LEB
<b>REVISIONS</b>		
<b>PLOT PLAN</b>		
CONSTRUCTION OF TREATMENT FACILITIES OF ACID MINE DRAINAGE <b>RAUSCH CREEK WATERSHED</b> SCHUYLKILL COUNTY PENNSYLVANIA		JOB NO: 4000 DATE: 11/19/68 SCALE: 1"=40'-0" DRAWN: R.G.S. APPROVED: T.H. O'NEILL
ANTHRACITE RESEARCH & DEVELOPMENT CO. INC. CONSULTING ENGINEERS POTTSVILLE PENNSYLVANIA		TAMAQUA <b>C-1</b>

