

REALTY CO.

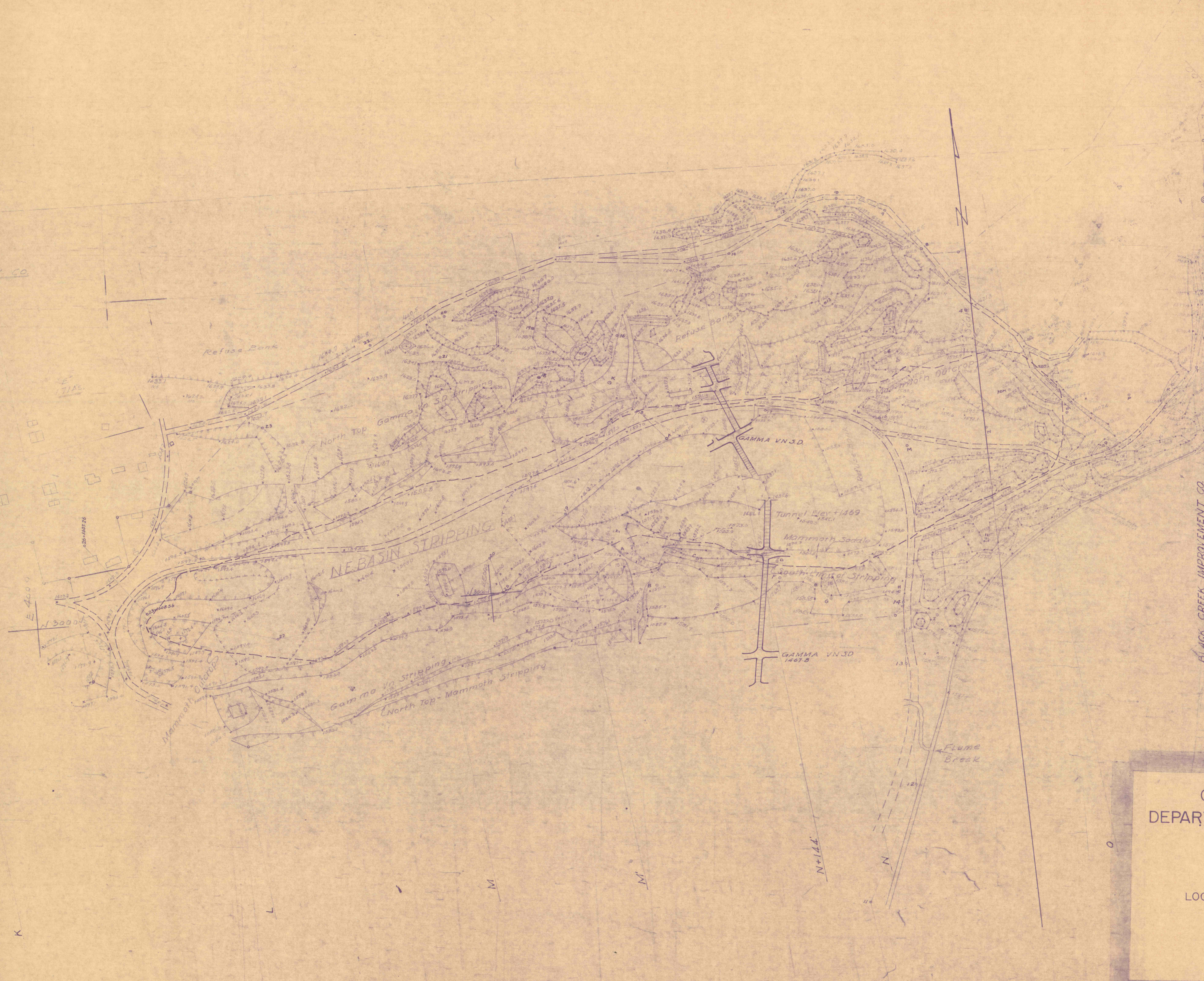

COMMONWEALTH OF PENNSYLVANIA
 DEPARTMENT OF MINES AND MINERAL INDUSTRIES
 PROJECT No. AS-43
 SURFACE MAP
 SHOWING
 LOCATION OF PROPOSED PROJECT FOR SURFACE FLOODING
 PARDEESVILLE MINE AND BREAKER REFUSE FIRE
 VICINITY OF
 VILLAGE OF PARDEESVILLE, HAZLE TOWNSHIP
 LUZERNE COUNTY, PENNSYLVANIA
 SCALE 1"=100' MARCH 1967