

THIRD STREET

10° 36.2'

CARROL ST

3RD ST

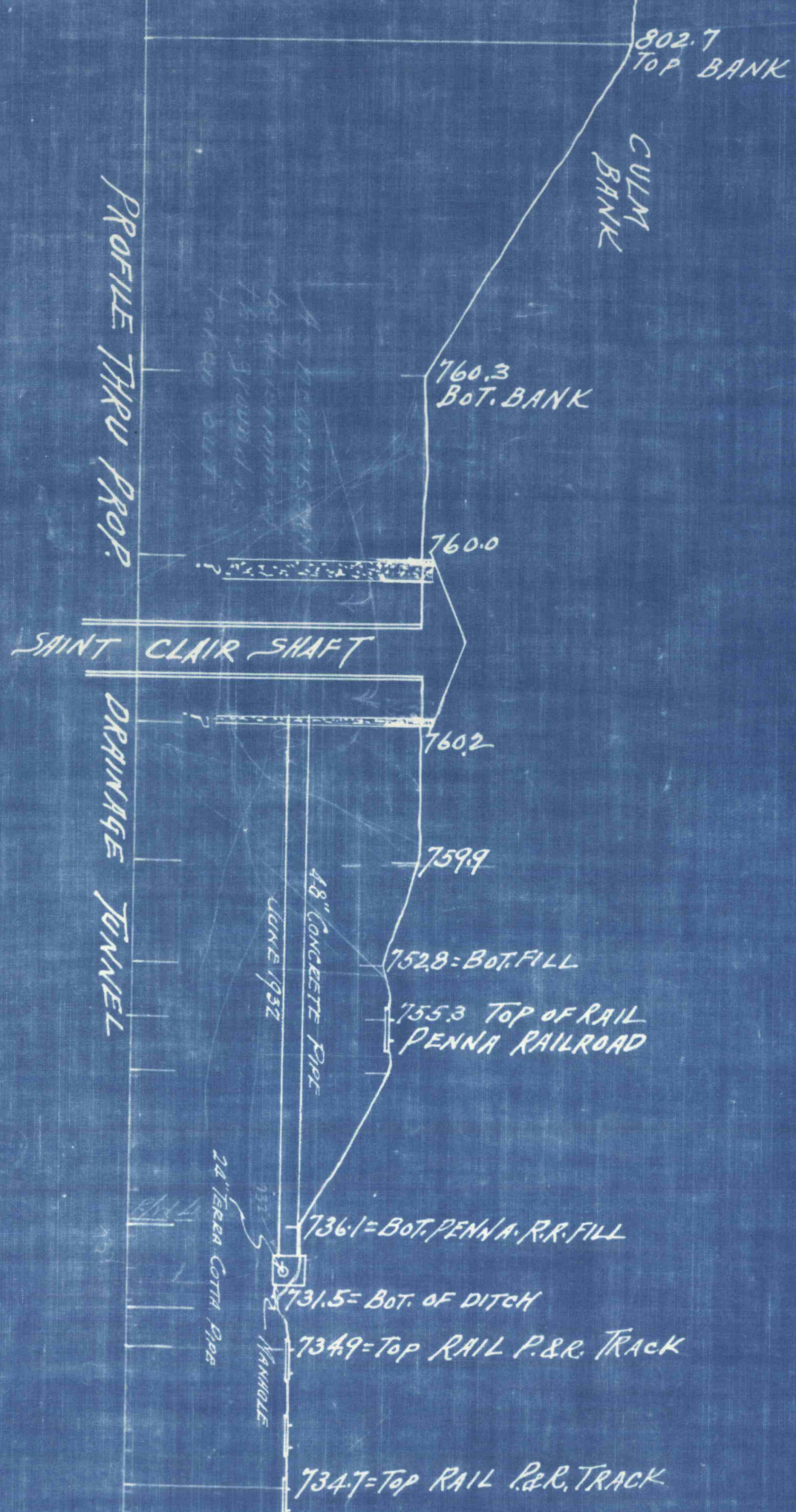
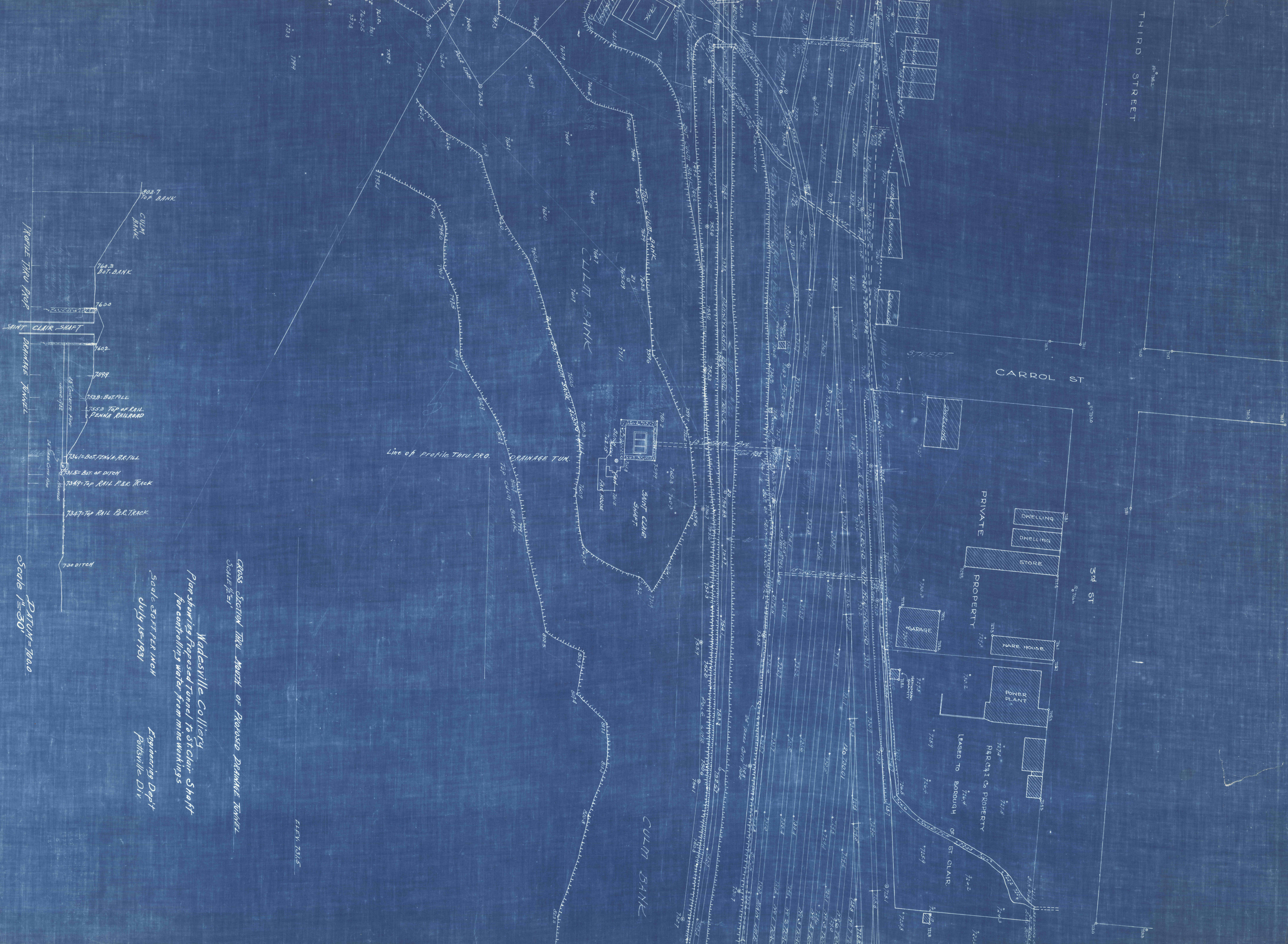

CROSS SECTION THRU MAINT OF PROPOSED DRAINAGE TUNNEL
 SCALE 1"=25'
 Wadesville Colliery
 Plan showing Proposed Tunnel to St. Clair Shaft
 for controlling water from mine workings
 Scale 50 FT PER INCH
 July 15-1931
 Engineering Dept
 Pottsville Div

DATUM = 700.0
Scale 1"=30'

ELEV. 731.5