

CURVE NO. 4
 P.I. No. 4=8+86.12
 $\Delta = 41^\circ 30'$
 $D = 86^\circ 49' 50''$
 $R = 64.5'$
 $T = 25.0'$
 $L = 48.0'$
 $E = 4.5'$

CURVE NO. 3
 P.I. No. 3=6+59.99
 $\Delta = 45^\circ 40' \text{ Rt.}$
 $D = 16^\circ 00'$
 $R = 358.10'$
 $T = 150.17'$
 $L = 285.37'$
 $E = 30.44'$

CURVE NO. 1
 P.I. No. 1=1+66.96
 $\Delta = 9^\circ 00' \text{ Lt}$
 $D = 15^\circ 00'$
 $R = 381.97'$
 $T = 30.06'$
 $L = 60.00'$
 $E = 1.18'$

CURVE NO. 2
 P.I. No. 2=2+72.42
 $\Delta = 48^\circ 40'$
 $D = 35^\circ 00'$
 $R = 163.70'$
 $T = 74.02'$
 $L = 139.02'$
 $E = 15.95'$

TEMPORARY BENCH MARKS		
No.	Elevation	Location and Description
1	1131.72	9" Nail in 12" sassafras 35' Lt. of Sta. 9+06
2	1220.02	Railroad spike in P.P.L pole # EX-T-3-36 300' upstream of Sta. 0+00

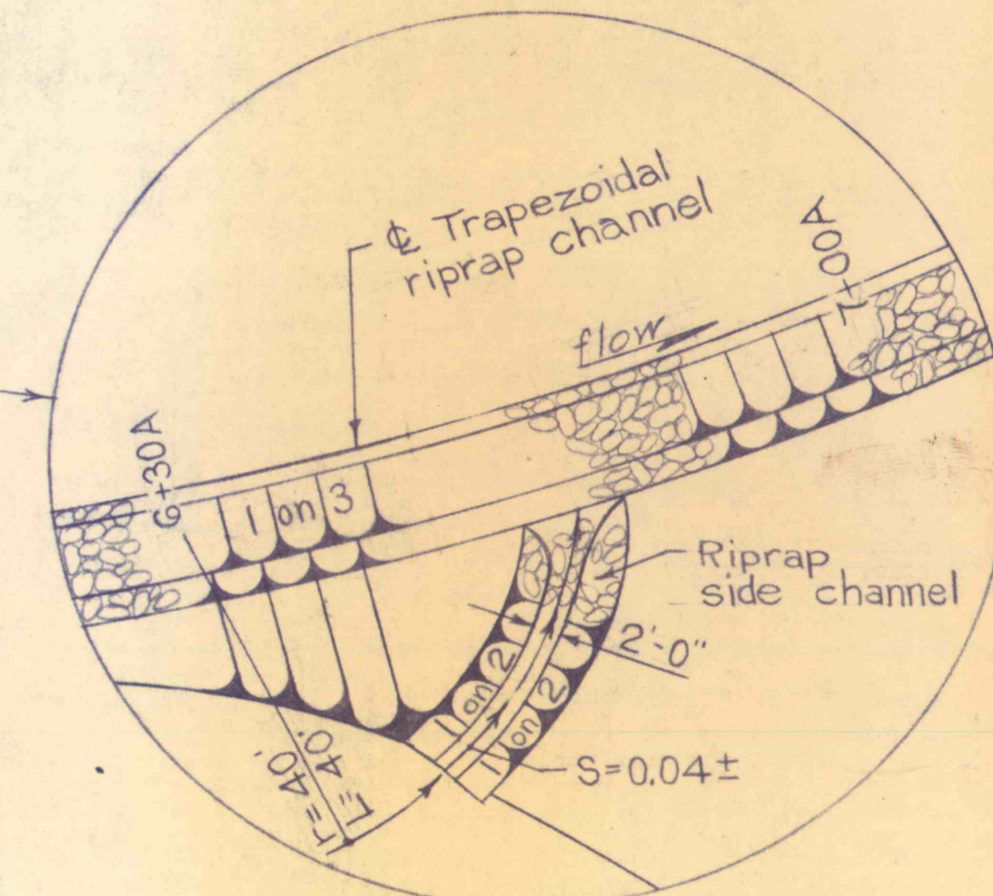
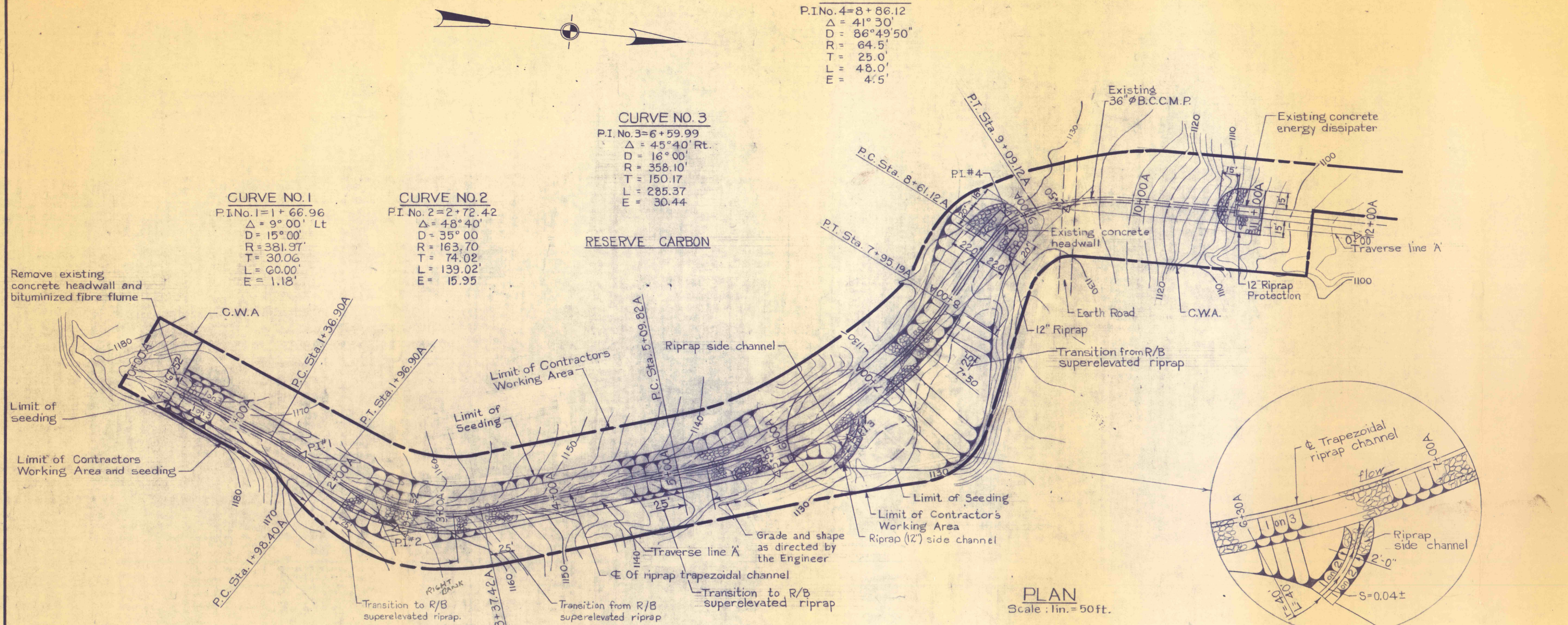

NOTES:
 1. For General Notes see Dwg. No. 3.
 2. For Cross sections and Details see Dwg. No's. 6 and 7.
 3. For Concrete Notes see Dwg. No. 7.

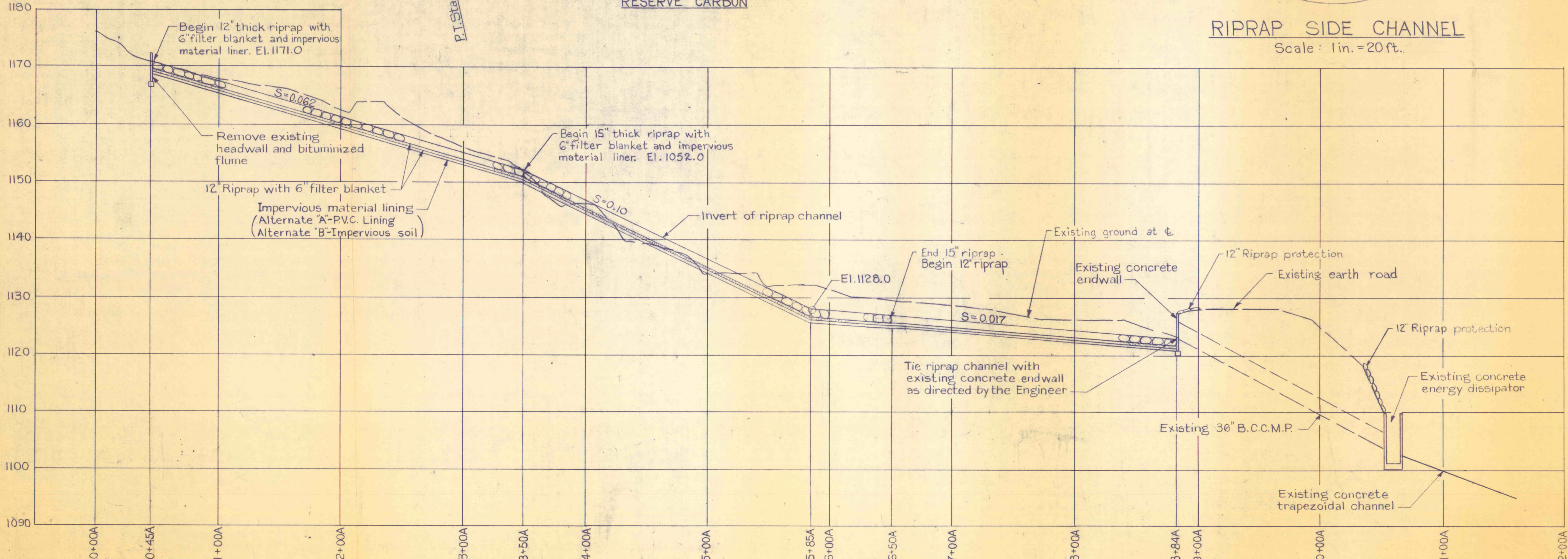

PROFILE ALONG C
 Scale: (Vert. : 1 in. = 10 ft.)
 (Hor. : 1 in. = 50 ft.)

RIPRAP SIDE CHANNEL
 Scale: 1 in. = 20 ft.

NO.	DATE	REVISION	APPR.
SUBMITTED <i>R. Rao</i> PROJECT CO-ORDINATOR			
APPROVED <i>Albert A. Ranieri</i> CHIEF - DIVISION OF MINE RECLAMATION			
APPROVED <i>Joe Penozo</i> DIRECTOR - BUREAU OF DESIGN			
COMMONWEALTH OF PENNSYLVANIA DEPARTMENT OF ENVIRONMENTAL RESOURCES OFFICE OF RESOURCES MANAGEMENT			
CONTRACT NO. SL 113-2-3F			
MINE DRAINAGE POLLUTION ABATEMENT REMEDIAL WORK SHAMOKIN CREEK WATERSHED			
NORTHUMBERLAND CO. PENNSYLVANIA			
DITCH A PLAN AND PROFILE			
DRAWN BY <i>AMandy</i> CHECKED BY <i>KRM</i>	DATE <i>9/27/76</i> SCALE As shown	DRAWING NO. 4 of 7	