

Deleted from Project

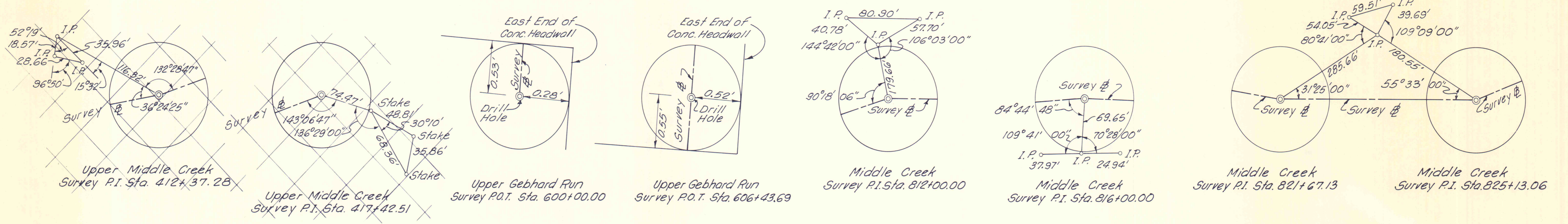

Deleted from Project

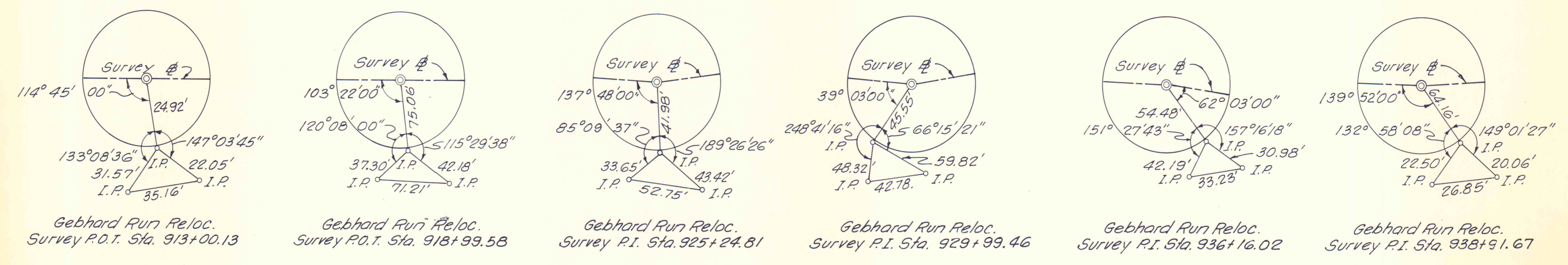
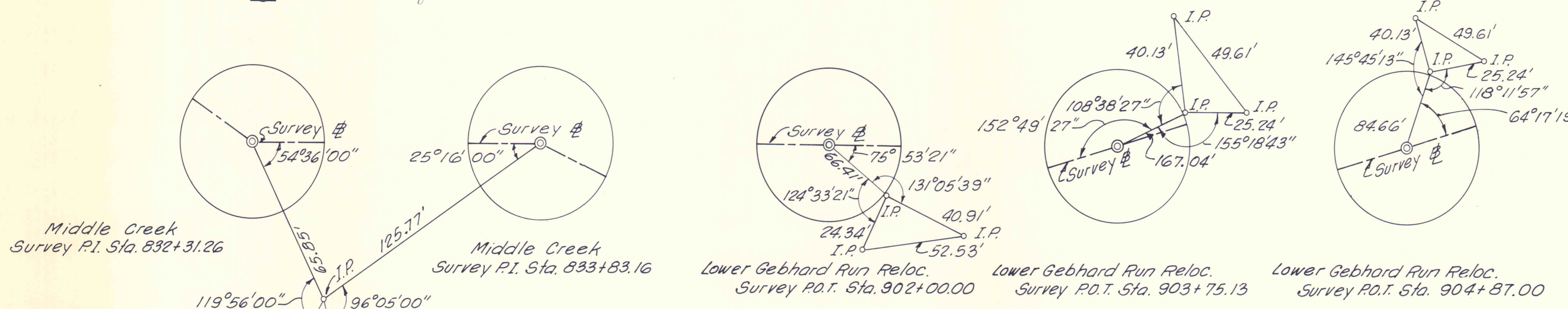

1-13-77	AS BUILT		
NO	DATE	REVISION	APPR.
SUBMITTED <i>Norman E. Mutchler</i>			
PROFESSIONAL			
APPROVED <i>Robert A. Ransau</i> CHIEF - DIVISION OF MINE DRAINAGE REHABILITATION			
APPROVED <i>Jim Mego</i> DIRECTOR - BUREAU OF CONSULTING SERVICES			
COMMONWEALTH OF PENNSYLVANIA DEPARTMENT OF ENVIRONMENTAL RESOURCES OFFICE OF ENGINEERING AND CONSTRUCTION			
PROJECT NO. SL-126-2-7			
MINE DRAINAGE POLLUTION ABATEMENT SWATARA CREEK WATERSHED SCHUYLKILL COUNTY			
BERGER ASSOCIATES, INC. Consulting Engineers			
P.O. Box 1943		Harrisburg, Penna.	
PERMANENT REFERENCES			
DRAWN BY	DATE	DRAWING NO.	
J.S.	APR. 17, 1973	23 of 43	
CHECKED BY	SCALE		
M.W.	NO SCALE		