

LEGEND

- FARM UNITS, DWELLINGS, ETC.
- FARM UNIT (FROM SHORT NUMBER OF UNITS)
- DWELLING OR OTHER TYPE DWELLING (THREE ROOMS)
- COMBINED DWELLING AND STORE
- DWELLING, BUSINESS AND POST OFFICE
- DWELLING, BUSINESS AND FILLING STATION
- DWELLING, BUSINESS, FILLING STATION AND POST OFFICE
- BARRETT'S OR DOMESTIC
- SEASONAL OR SUMMER COLONY DWELLING
- SEASONAL DWELLINGS CLOSELY SPACED
- MOTEL OR INN
- CHURCH OR OTHER RELIGIOUS INSTITUTION
- CENTER
- CHURCH WITH CEMETERY ADJACENT
- FRESH AIR ROOM OR REST HOME
- HOSPITAL
- TOLL HOUSE
- WATER STORAGE FOR FIRE PROTECTION
- GROUP OF MIXED CULTURAL FEATURES
- INDUSTRIAL
- STORE OR SMALL BUSINESS ESTABLISHMENT
- BUSINESS AND FILLING STATION
- BUSINESS, FILLING STATION AND POST OFFICE
- FACTORY OR INDUSTRIAL PLANT
- MINERAL SHED OR SHED
- OIL OR GAS WELL
- GAS TANK
- FILLING STATION (NOT MIXED WITH OTHER BUSINESS)
- PUMPING STATION (ON OR NEAR ROAD)
- SEASONAL INDUSTRY (SUMMER OR FALL, WOOD MILL)
- ROAD STAND FARM PRODUCE SALES
- WAREHOUSE (GENERAL)
- QUARRY
- QUARRY PIT
- QUARRY
- MILL OR OVER
- WATER POWERED MILL
- STOCK POND OR LOADING PEN
- EDUCATIONAL AND CORRECTIONAL INSTITUTIONS
- SCHOOLHOUSE
- CONSOLIDATED OR LARGE SCHOOL
- OTHER EDUCATIONAL INSTITUTIONS
- PUBLIC LIBRARY
- MUSEUM
- TOWN HALL, GRANGE OR COMMUNITY HALL
- ZOOLOGICAL GARDEN
- COUNTY PRISON FARM
- CORRECTIONAL INSTITUTION
- PUBLIC SERVICE FACILITIES
- POST OFFICE
- STATE GARAGE
- POLICE STATION
- FIRE ENGINE HOUSE
- GARBAGE OR RUBBISH DUMP
- INCINERATOR
- WATER SUPPLY TOWER
- POWER PLANT
- POWER SUBSTATION
- FILTER PLANT
- RADIO STATION (WITH CALL LETTERS)
- RADIO RANGE STATION
- RECREATION OR RECREATION
- ATHLETIC FIELD
- BATHING BEACH OR SWIMMING POOL
- CAMP SITE
- CAMP OR LODGE
- SMALL PARK (RECREATION, AMUSEMENT, OR SPORTS)
- RODENT SPRING
- FOREST RANGER STATION
- GUARD OR WARDEN STATION
- OBSERVATION OR LOOKOUT TOWER
- PROMENADE BEACH AND LOOKOUT TOWER
- FISH HATCHERY
- GOLF COURSE OR COUNTRY CLUB
- POLO GROUNDS
- RECREATION
- AMUSEMENT PARK OR HALL
- FARNSWORTH RACE COURSE, SYSTEM
- DRIVE-IN THEATRE
- STATE WILD RECREATION AREA, HISTORIC SITE
- MISCELLANEOUS MAP FEATURES-NATURAL FEATURES
- ARROYO
- ARROYO
- TRANSLATION STATION
- FORE ARMY CAMP OR BARRACKS
- BENCH MARK
- LONGITUDE AND LONGITUDE LINE
- PROMENADE ELEVATION WITH NAME
- SINK OR DEPRESSION
- AIRWAYS AND AIRPORTS
- MILITARY FIELD
- AIRPORT COMPLETE FACILITIES (COMMERCIAL OR MILITARY)
- AIRFIELD LIMITED FACILITIES
- LANDING AREA OR STRIP (MILITARY OR CIVIL)
- AIRFIELD LIGHT BEACON (MILITARY)
- SEAPLANE BASE, MILITARY
- SEAPLANE BASE, CIVIL
- AIRPORT (GENERAL)
- RAILROADS
- RAILROAD
- RAILROAD (NARROW GAUGE)
- ELECTRIC INTERURBAN OR SUBURBAN RAILROAD
- RAILROAD ABANDONED TRACK RETAINED
- RAILROAD STATION
- RAILROAD CROSSING
- RAILROAD ABOVE
- RAILROAD BELOW
- RAILROAD BRIDGE AND TUNNEL
- STANDARD GAUGE RAILROAD (ON STEETS OR BRIDGE)
- NARROW GAUGE RAILROAD (ON STEETS OR BRIDGE)
- ELECTRIC RAILROAD
- NAVIGATION AND DRAINAGE
- SHIP AND BARGE LINES ON NATURAL STREAMS
- FRIGID FOUNTAIN AND TOLL FERRY
- NAVIGABLE STREAM (NON-RAILROAD)
- HEAD OF NAVIGATION (NON-RAILROAD)
- HEAD OF NAVIGATION (RAILROAD)
- CANAL
- ABANDONED CANAL
- DAM WITH LOCK
- INTERMITTENT STREAM
- NARROW STREAM
- WIDE STREAM
- WIDE STREAM WITH DAM
- LAKE, RESERVOIR OR POND
- LAKE, RESERVOIR OR POND WITH DAM
- MARSH OR SWAMP LAND
- BOUNDARIES
- STATE LINE
- COUNTY LINE
- CORPORATE LINE
- UNINCORPORATED CONTACT LINE
- ENLARGEMENT INSET LINE
- STATE GAME REFUGE LINE
- STATE GAME LAND LINE
- STATE FOREST LAND LINE
- OTHER STATE OR FEDERAL PUBLIC LAND LINE
- CITY, BOROUGH OR VILLAGE CENTERS
- COUNTY SEAT
- OTHER CITIES AND VILLAGES
- INCORPORATED CITIES OR BOROUGH
- UNINCORPORATED URBAN COMPACT
- STRUCTURES
- HIGHWAY BRIDGE (OVER HIGHWAY)
- SMALL BRIDGES CLOSELY SPACED
- COVERED BRIDGE
- DRYBRIDGE
- SUSPENSION
- ARCH
- TRESS OR GIDER
- CANTILEVER BRIDGE
- DAM WITH ROAD
- HIGHWAY BRIDGE SEPARATION
- LEVEE OR ONE WITH ROAD
- LEVEE OR ONE WITH ROAD
- FOUR ROAD WITH ROAD
- OVERHEAD INDUSTRIAL STRUCTURE
- ROADS AND ROADWAY FEATURES
- FEDERAL PRIMARY HIGHWAY SYSTEM
- FEDERAL SECONDARY HIGHWAY SYSTEM
- FEDERAL AND URBAN HIGHWAY SYSTEM
- TRAFFIC CIRCLE
- U.S. TRAFFIC ROUTE NUMBER
- PENNSYLVANIA TRAFFIC ROUTE NUMBER
- PENNSYLVANIA LEGISLATIVE ROUTE NO.
- PENNSYLVANIA TOWNSHIP ROUTE NUMBER
- POINTS BETWEEN WHICH DISTANCES ARE MEASURED INDICATED
- SIDE ROADS AND STREETS IN UNINCORPORATED
- URBAN COMPACTS AND EXTENSIONS OF LOCAL
- ROADS WITHIN MUNICIPALITIES
- UNPAVED ROAD
- GRAVEL OR STONE ROAD
- GRAVEL AND DRAINED ROAD
- GRAVEL OR STONE ROAD
- BITUMINOUS ROAD (ONE WAY)
- CONCRETE OR BRICK ROAD
- DIVIDED HIGHWAY

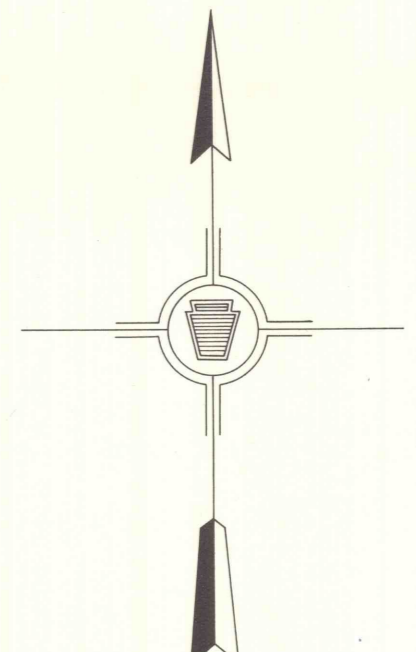
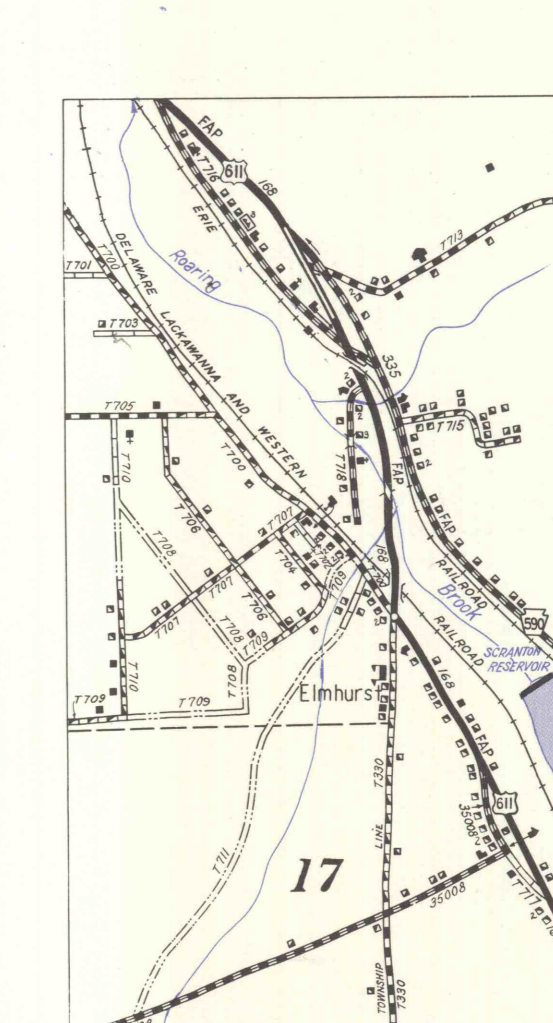
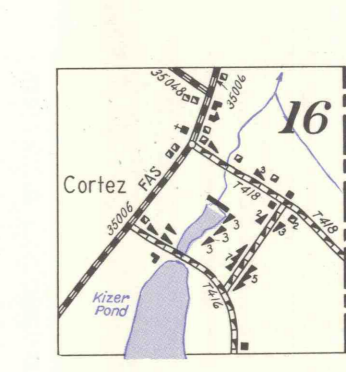
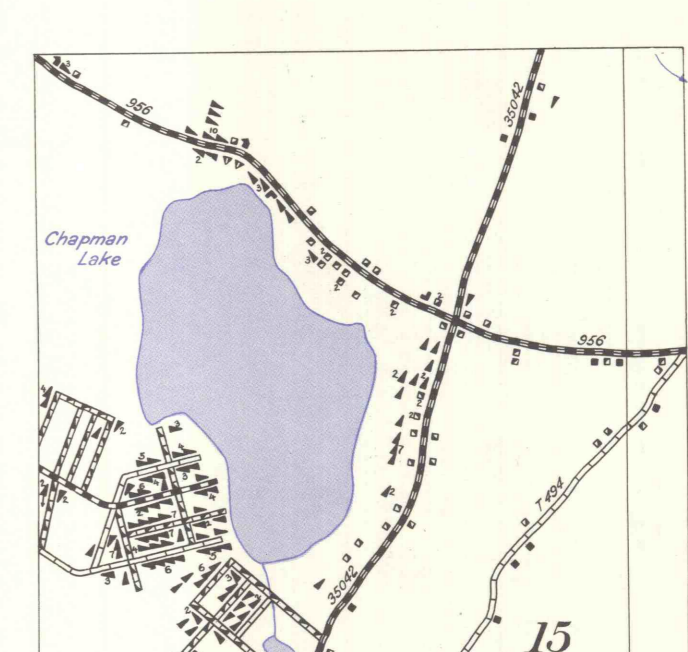
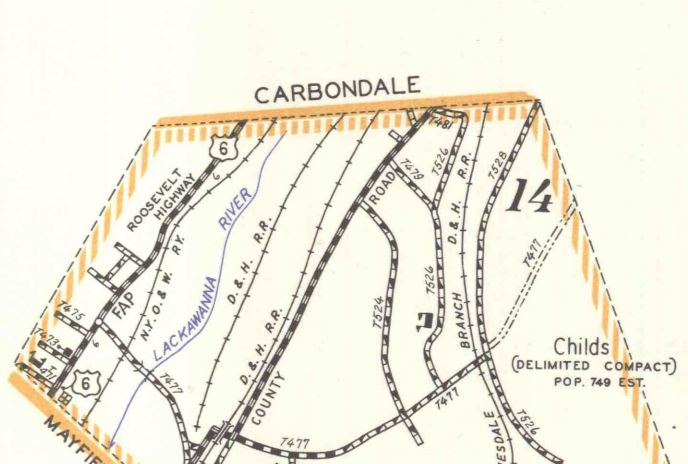
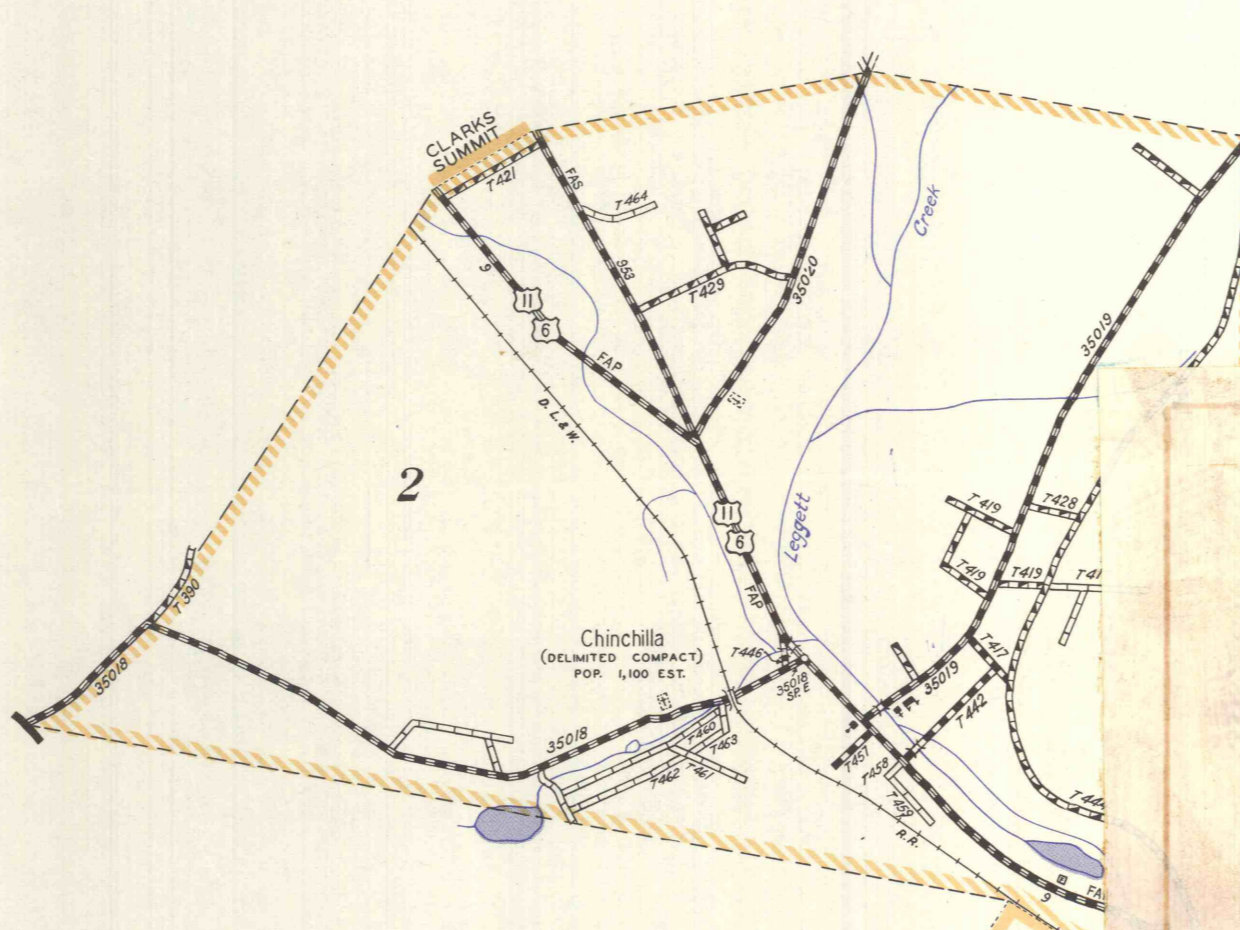
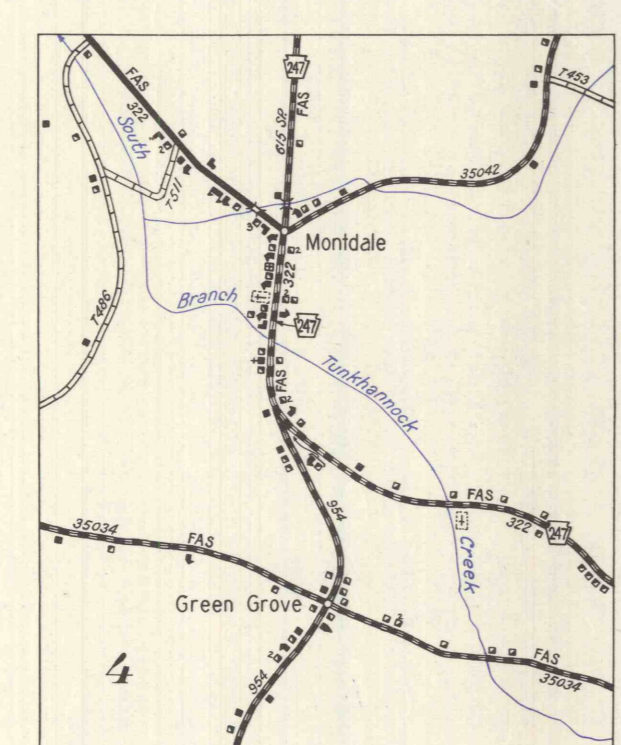
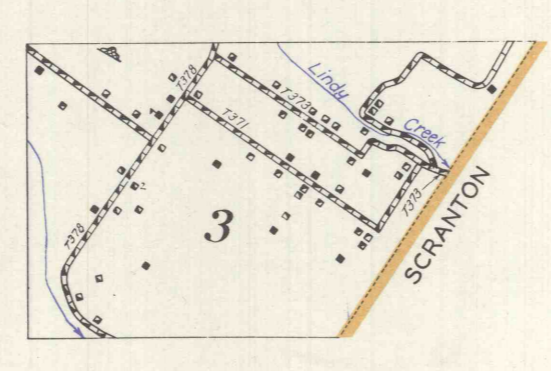
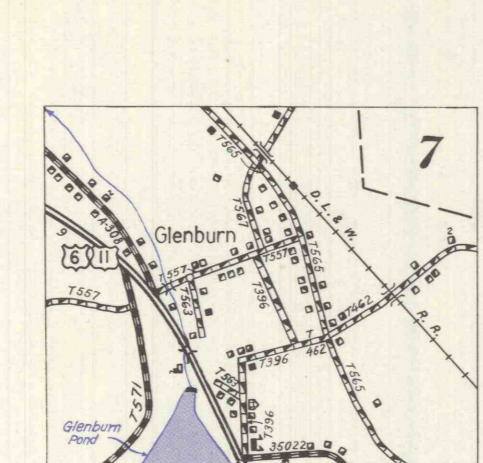
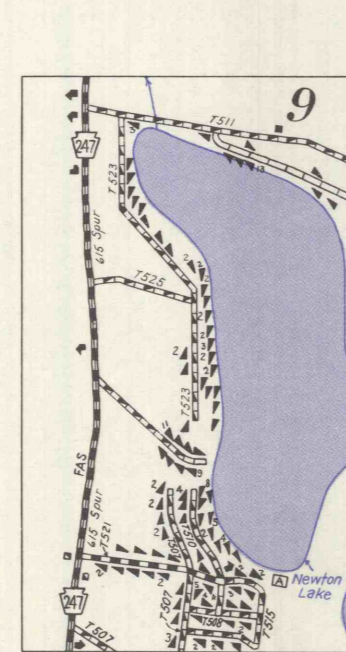
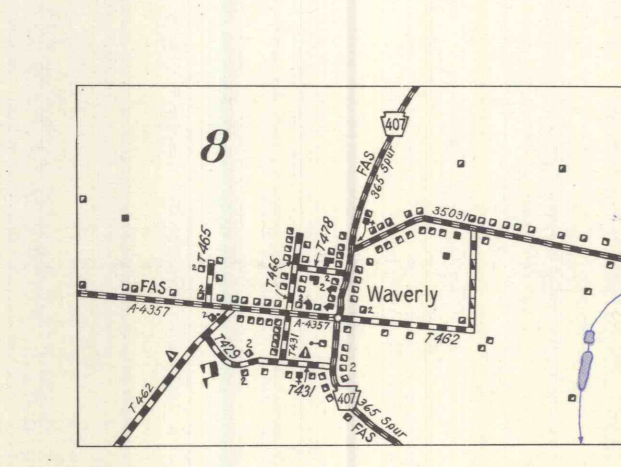
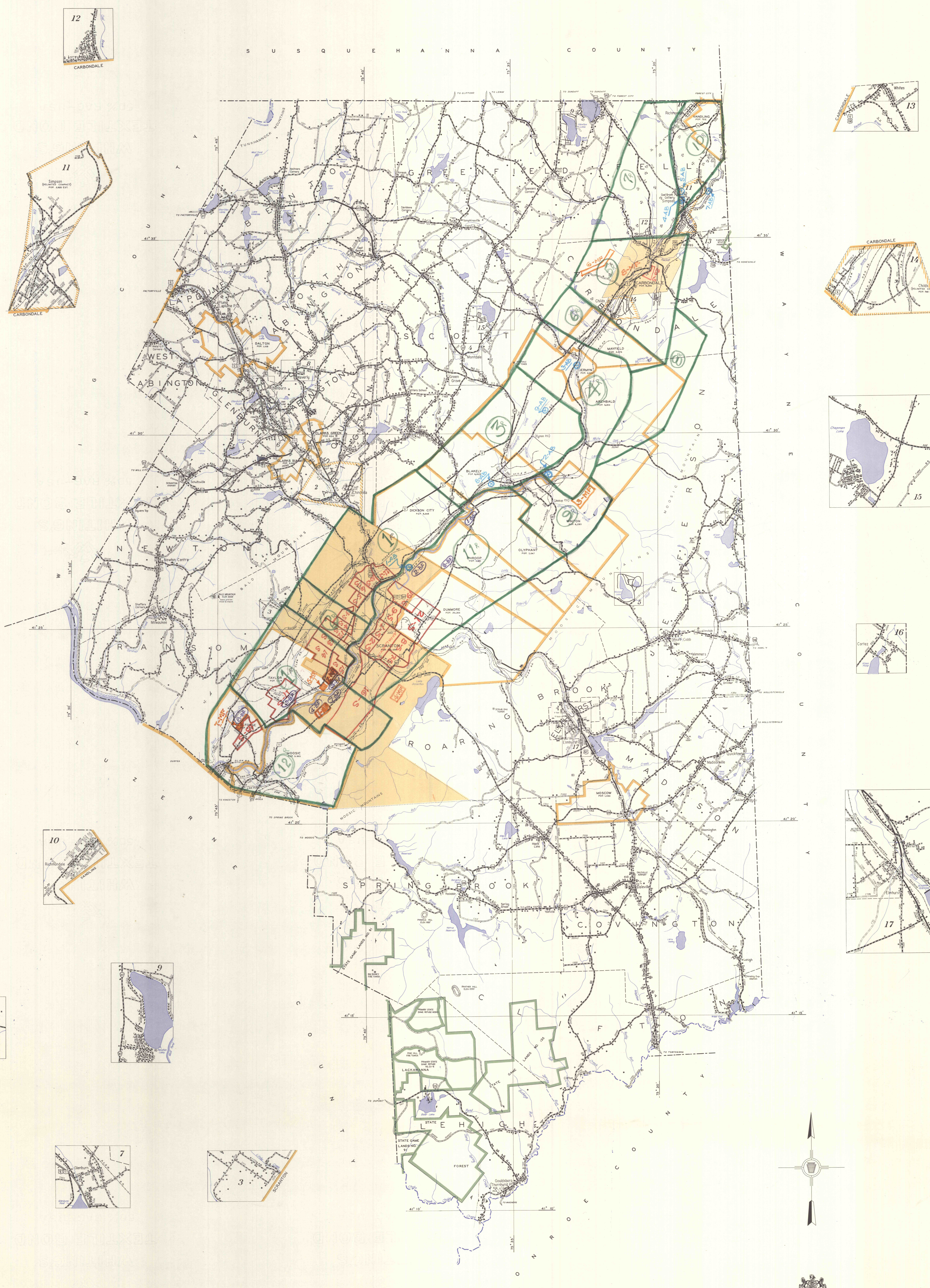

GENERAL HIGHWAY MAP
LACKAWANNA COUNTY
PENNSYLVANIA

PREPARED BY THE
PENNSYLVANIA DEPARTMENT OF HIGHWAYS
IN COOPERATION WITH THE
BUREAU OF PUBLIC ROADS
U.S. DEPARTMENT OF COMMERCE
DATA OBTAINED FROM
STATE-WIDE HIGHWAY PLANNING SURVEY

SCALE
ENLARGEMENT SCALE
1953

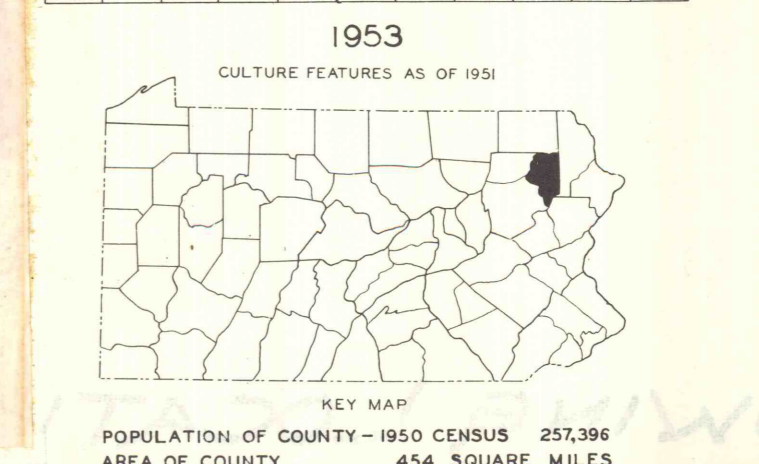

LEGEND

STRIPPING, BACKFILL	R GREEN
SUBSIDENCE	S RED
ACTIVE DRAINAGE	AC BLACK
ABANDONED DRAINAGE	AB BLUE
MINES FIRES	MF PURPLE
BANK FIRES	BF ORANGE

August 10 1965

GENERAL HIGHWAY MAP LACKAWANNA COUNTY PENNSYLVANIA